

Peirce Island Road Bridge - Background

- Constructed 1958
- Typical Lifespan 50 Years
- Plan for Replacement
- Could be Eligible for NHDOT Municipal Bridge Aid Program with 80% Grant Funding
- Potential Replacement Cost \$7M



Peirce Island Road Bridge – Scope of Work

- Deck Maintenance Project
 - Extend Life to Take Advantage of NHDOT Funding
 - Avoid Repairs During WWTF Construction
 - Repair Mechanic Street Pump Station Force Main
- Cost : \$414,000
- Contractor: George R Cairns & Sons, Inc.
- Schedule:
 - Late May through Late September



Peirce Island Road Bridge – Traffic Details

- Phase 1 and 2 (June, July, Aug)
 - Temporary Traffic Signal on Both Sides of Bridge
 - One-Way Alternating Traffic
 - 10-ft Wide Lane Width
 - Parking Restriction Along Mechanic Street
- Miscellaneous (Sept)
 - Intermittent One-Way Alternating Traffic
 - No Lane Width Restriction
- Pedestrian Access Only Restricted on Limited Basis for Repairs of the Pedestrian Walkway





Phase 1 – Deck Repairs South and Force Main

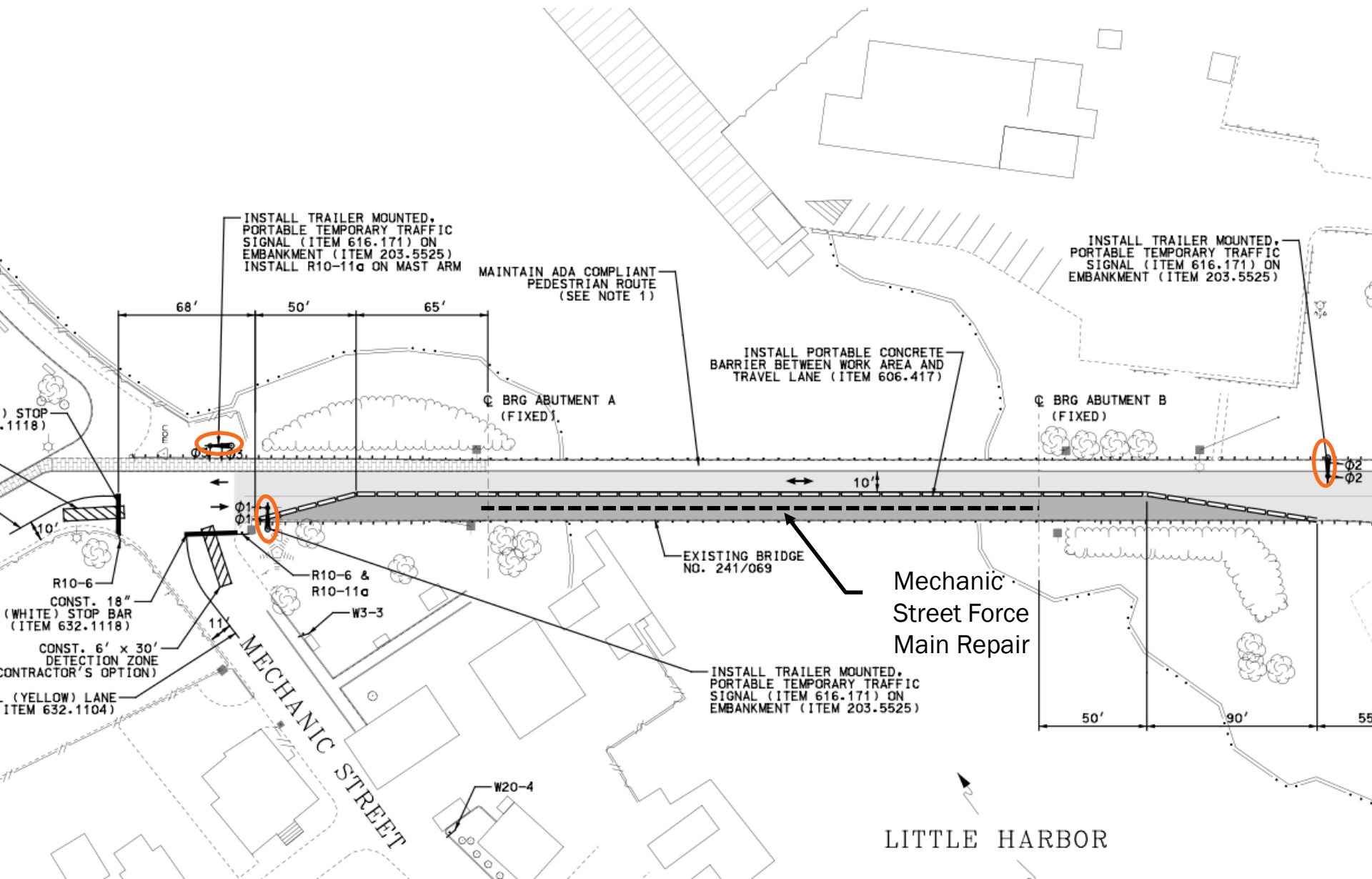

Phase 2 – Deck Repairs North

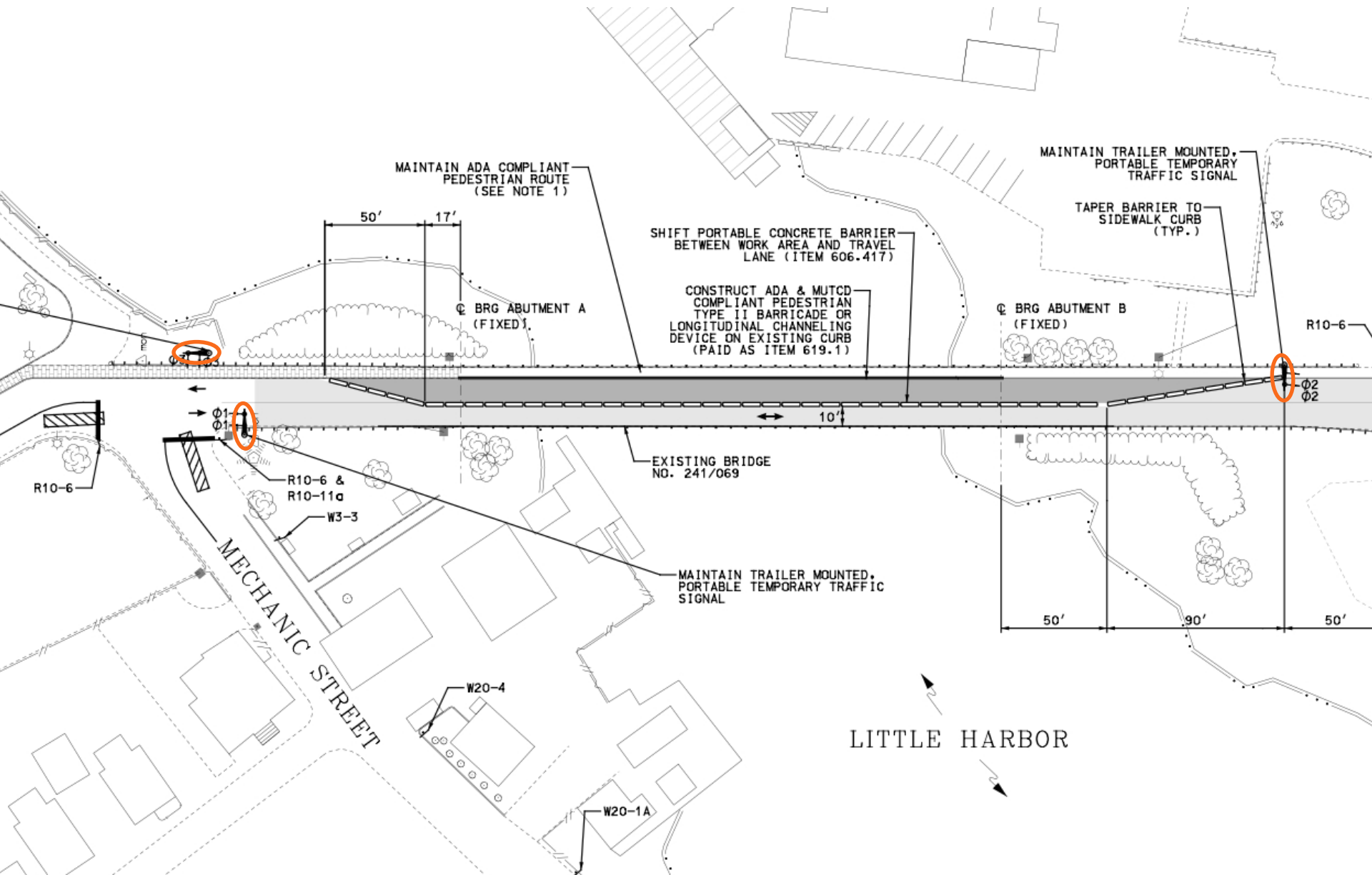

Phase 2A – Sidewalk Repairs

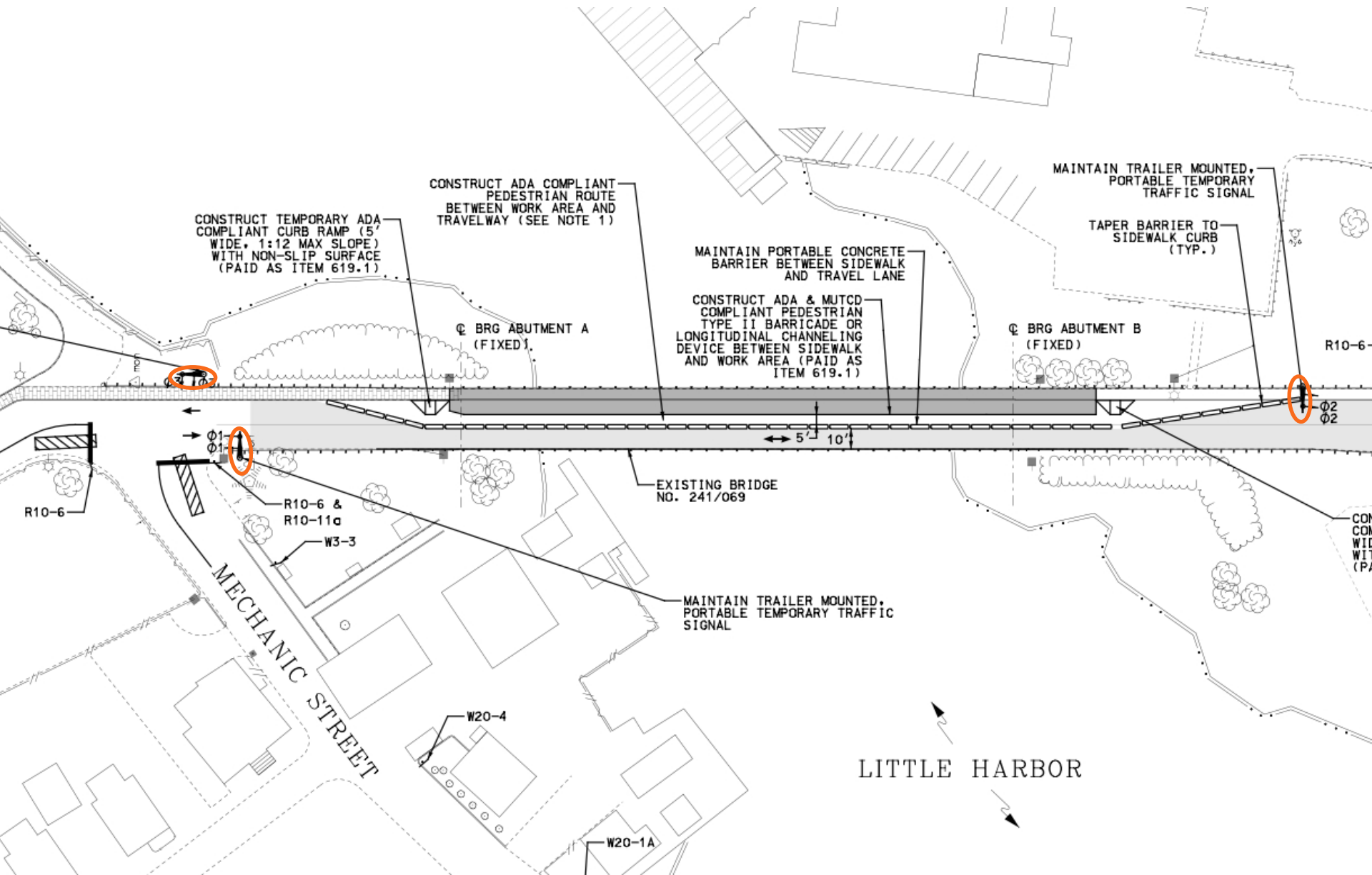

Mechanic Street Parking Restrictions

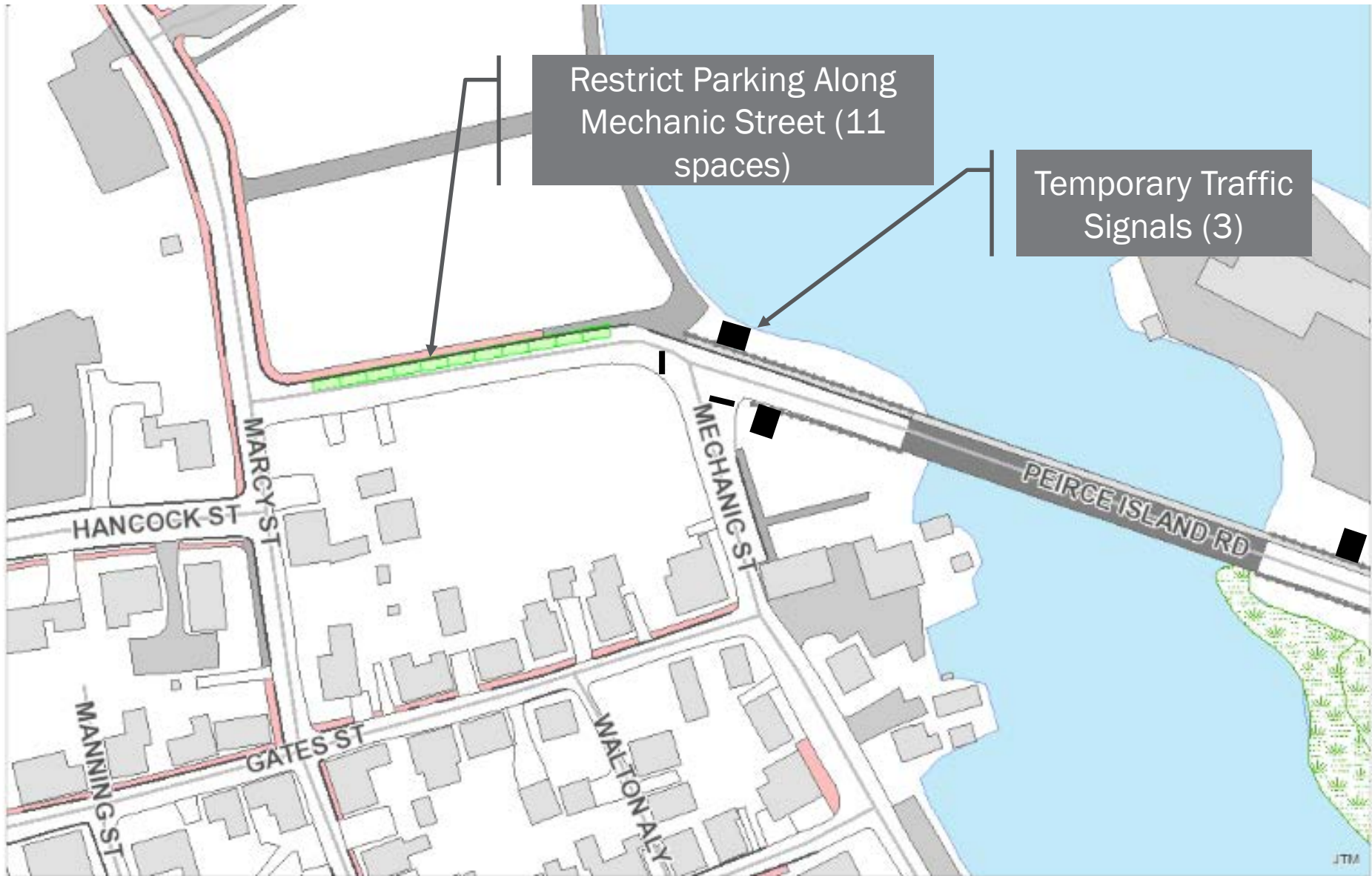

Mechanic Street Parking Restrictions

