

Plans:

We plan to add a skylight to the upstairs bathroom on the 3rd story.

- Size : 21" x 37 7/8"
- Type: Vented Deck Mount Skylight
- We plan to add the skylight between existing roof rafters - no structural changes to existing framing
- Our skylight will go on the roofline facing the parking lot and not seen from street

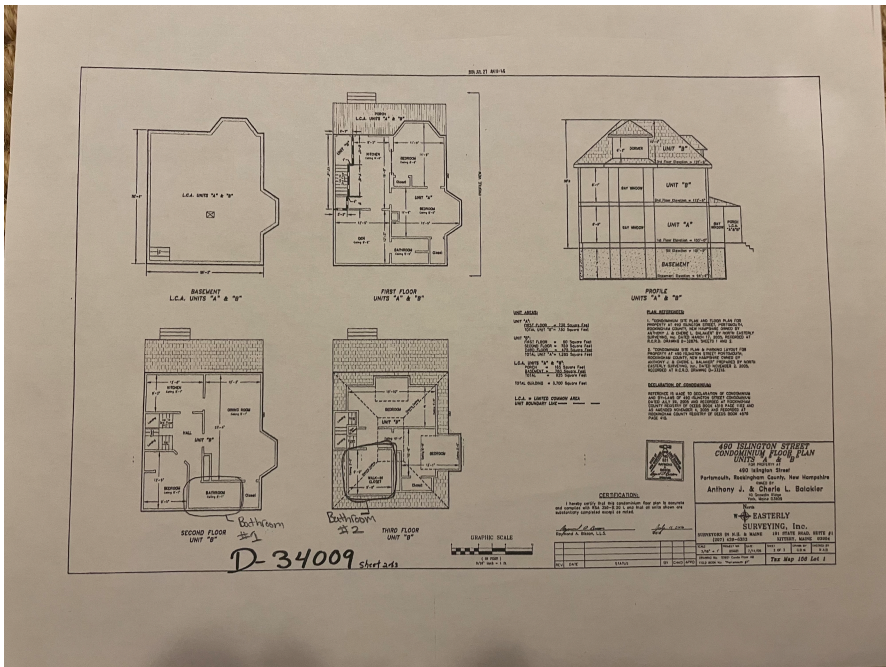
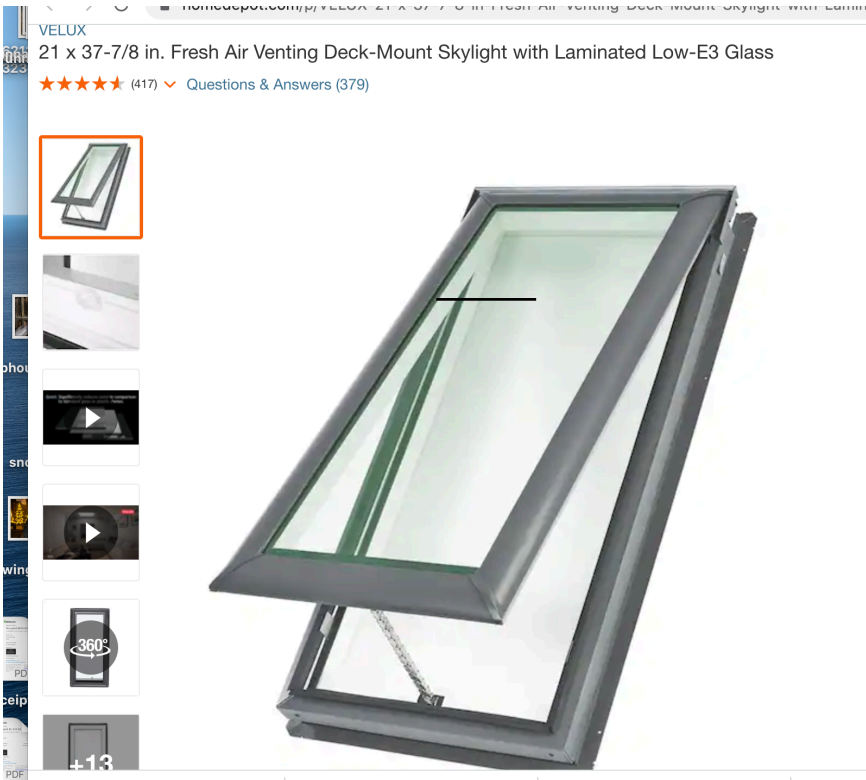

Neighbor Examples:

