

## Application for Certificate of Approval

# Historic District Commission

(For projects over \$25,000; Work Sessions are strongly recommended)

Date: _____	<b>RECEIVED</b> SEP 14 2018
By: _____	

Owner: Andrew Greeter Applicant (if different): \_\_\_\_\_

Address: 69 New Castle Ave Address: \_\_\_\_\_  
(Street) (Street)

Portsmouth NH 03801 (City, State, Zip) (City, State, Zip)

Phone: 603-531-3346 Phone: \_\_\_\_\_

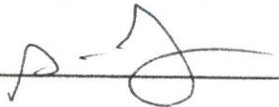
Signature: 

Location of Structure: Map 0101 Lot 0049 Street Address: 69 New Castle Ave  
Building Permit #: \_\_\_\_\_

To permit the following: See attach drawings and site plan - Looking to add 72sqft to back of house to allow room for an eat-in kitchen

Action Taken by H.D. C. at Public Hearing	
Date of Approval:	
As Per Plan:	
Stipulations:	
Signature of Principal Planner:	

Administrative Use Only:	
Date of Meeting:	<u>10-3-18</u>
Payment:	<u>200</u>
Payment Type:	<u>OK# 1361</u>
Index/Permit #:	_____

### If approved, please acknowledge below:

I hereby acknowledge that all changes or variation in the design as presented shall require further Historic District Commission approval.

Owner: 

## Izak Gilbo

---

**From:** Aaron Grueter <agrueter@comcast.net>  
**Sent:** Wednesday, October 31, 2018 1:45 PM  
**To:** Izak Gilbo  
**Subject:** RE: Updated plans - Grueter  
**Attachments:** Entry Door Spec.png

Hi Izak, this is the door that we would like to use. I called the manufacturer and i cannot seem to get a picture of it with the 6 lites showing but that is what we plan to do which is called out in the spec, 3x2. Will this work?

Thanks, Aaron

Aaron  
603-531-3346

> On October 30, 2018 at 1:34 PM Izak Gilbo <igilbo@cityofportsmouth.com> wrote:

>

>

> Hi Aaron,

>

> Sorry for bothering you again- any chance you were able to decide on/have a specification sheet for the proposed front door that was talked about during the Work Session? I belive a member had mentioned it should be a six light vs. 4 light. They will need to see the door that is going to be replaced in order to approve- I did not see a new spec. sheet with the submitted plans from 10/19/2018.

>

> I would need that spec. sheet by Thursday morning, if you're still planning on moving forward with the door as well.

>

> Best,

> Izak

> -----Original Message-----

> From: Izak Gilbo

> Sent: Tuesday, October 30, 2018 10:52 AM

> To: 'Aaron Grueter' <agrueter@comcast.net>

> Subject: RE: Updated plans - Grueter

>

> Hi Aaron,

>

> Thank you for sending over the PDF of the plans for HDC approval. Your application will move forward as a Work/Session/Public Hearing again however the difference this time is that instead of continuing until December- they will end the work session and move directly into a public hearing. Because your application is continued it actually moves closer to the beginning of the agenda- so you will not be last this time.

>

# Proposed Front Door:

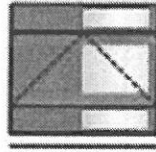

PK #  
2006

Pella Brand, 3-Wide Entry Door Sidelight, 1638.30 X 2076.450, Classic White, 4 9/16"

Item Price

Qty

Ext'd Price

## 1: 1280 Fixed Entry Door Sidelight

Frame Size: 13 1/2 X 81 3/4

Unit Type: Fixed Inswing, Standard Sill

Dimension Options: No Cut Down

General Information: 5 7/8", 1 5/16", 4 9/16"

Panel Style: 1/2 Light

Glass: Tempered Low-E Air Fillic

Grilles: Simulated Divided Light, 7/8" Contour, Match Interior Panel Finish, Match Exterior Panel Finish, Traditional, Typical, 1, 3

Panel Selection: Oak, Painted, Black, Painted, Black

Frame Selection: Clad, Pine, Oak Threshold, No Panel Reinforcement, Standard Enduracled, Classic White, Wood, Unfinished

Hardware Options: Brown Finish Sill

Performance Information: U-Factor 0.19, SHGC 0.05, VLT 0.07, CPD PEL-M-174-02316-00001

Vertical Mull 1: FactoryMull, Standard Joining Mullion - Doors, Frame To Frame Width- 0", Mull Design Pressure- 20

2: 3680 Entry Door

Frame Size: 37 1/2 X 81 3/4

Unit Type: Left Inswing, Standard Sill, No Fire Rating, No Fire Rating

Dimension Options: No Cut Down

General Information: 5 7/8", 1 5/16", 4 9/16"

Panel Style: 1/2 Light

Glass: Tempered Low-E Air Fillic

Grilles: Simulated Divided Light, 7/8" Contour, Match Interior Panel Finish, Match Exterior Panel Finish, Traditional, Typical, 3, 3

Panel Selection: Oak, Painted, Black, Painted, Black

Frame Selection: Clad, Pine, Oak Threshold, No Panel Reinforcement, Standard Enduracled, Classic White, Wood, Unfinished

Hardware Options: Latch Bore with Deadbolt, 2 3/8", 2 1/8", No Integrated Sensor, No Handle Set, Aluminum Adjustable, Oil Rubbed Bronze, Brown

Finish Sill

Unit Accessories: No Bang Panel

Performance Information: U-Factor 0.22, SHGC 0.09, VLT 0.15, CPD PEL-M-174-02400-00001, Calculated Positive DP Rating 30, Calculated Negative

DP Rating 30, Year Rated 08

Vertical Mull 2: FactoryMull, Standard Joining Mullion - Doors, Frame To Frame Width- 0", Mull Design Pressure- 20

3: 1280 Fixed Entry Door Sidelight

Frame Size: 13 1/2 X 81 3/4

Unit Type: Fixed Inswing, Standard Sill

Dimension Options: No Cut Down

General Information: 5 7/8", 1 5/16", 4 9/16"

Panel Style: 1/2 Light

Glass: Tempered Low-E Air Fillic

Grilles: Simulated Divided Light, 7/8" Contour, Match Interior Panel Finish, Match Exterior Panel Finish, Traditional, Typical, 1, 3

Panel Selection: Oak, Painted, Black, Painted, Black

Frame Selection: Clad, Pine, Oak Threshold, No Panel Reinforcement, Standard Enduracled, Classic White, Wood, Unfinished

Hardware Options: Brown Finish Sill

Performance Information: U-Factor 0.19, SHGC 0.05, VLT 0.07, CPD PEL-M-174-02316-00001

Vertical Mull 1: FactoryMull, Standard Joining Mullion - Doors, Frame To Frame Width- 0", Mull Design Pressure- 20

Wrapping Information: Nail Fin, Factory Applied, No Exterior Trim, 4 9/16", 5 7/8", Factory Applied, Pella Recommended Clearance, Perimeter Length = 293"



69 New Castle Ave, Portsmouth, NH  
Proposed Addition



Existing Conditions



Proposed Addition





Existing Conditions



Proposed Window



69 New Castle Ave, Portsmouth, NH [Map Lot 0101-0049-0000]  
Proposed Addition

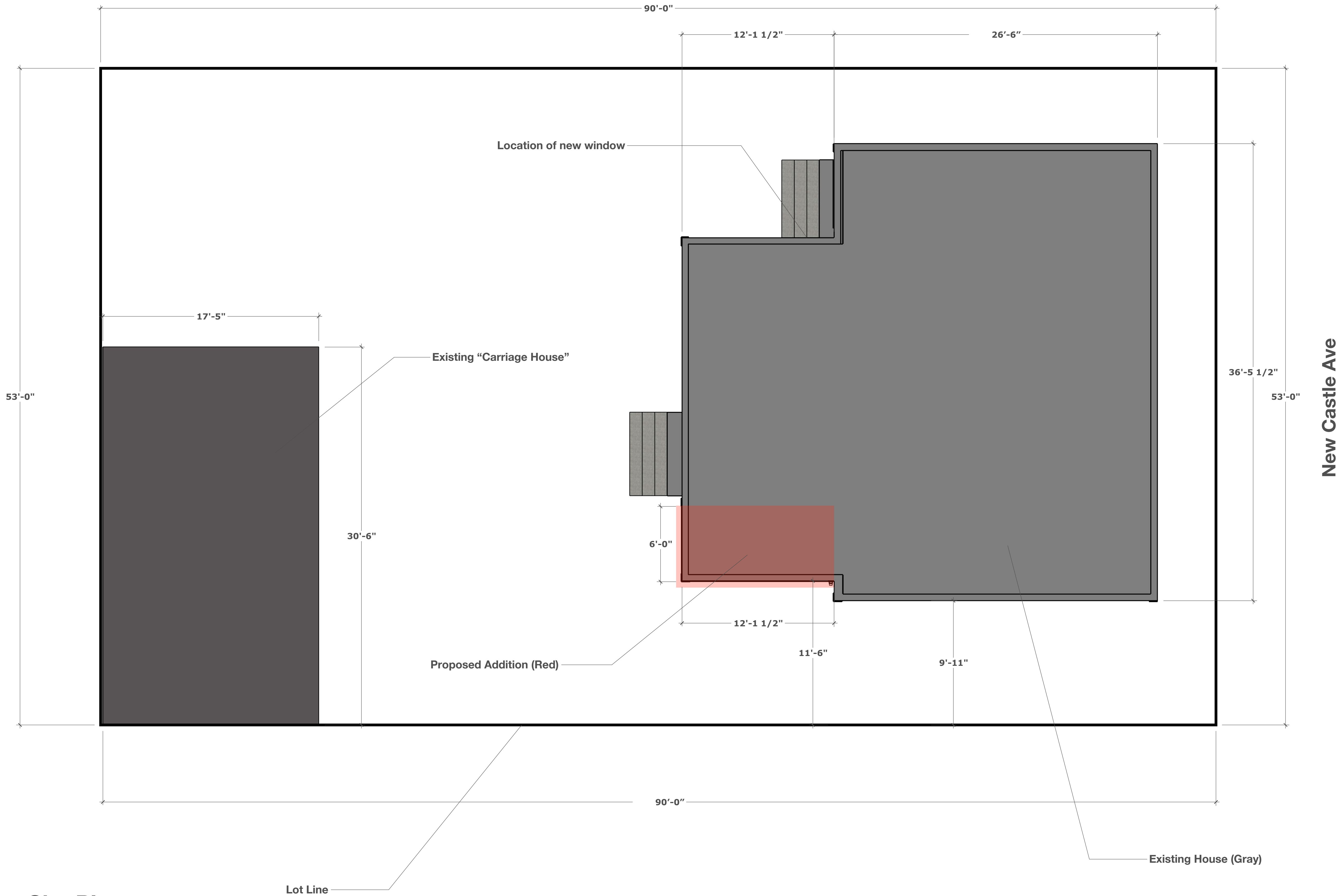
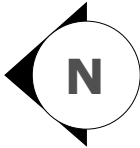

Site Plan

1/4" = 1' - 0"

chris@rfikt.co  
802 999 1641  
rfikt.co

Reflective  
Designworks

69 New Castle Ave  
Portsmouth, NH

Grueter Addition / Remodel

Site Plan

By: Chris Kiper

17 OCT 2018

A3



69 New Castle Ave, Portsmouth, NH  
Proposed Addition



North Elevation

1/4" = 1' - 0"

West Elevation

1/4" = 1' - 0"





Gutter

Vented soffit

Simple cornerboard

Small crown molding

Crown molding at top of window

Existing Roof and Trim Detail



Vented soffit (wood)

Gutter (metal, matching existing)

Crown molding at top of window (wood)

Simple Corner board

Composite board trim

Composite board trim

Proposed Roof and Trim Detail for Addition  
(To match existing)