

HIGH-HANOVER RESTORATION PROJECT

**PROJECT #7199
BID #04-17**



CONTACT NUMBERS:

*PUBLIC WORKS 427-1530
PORTSMOUTH WATER 427-1552
POLICE DETAILS 610-7412
PROJECT FLAGGING 622-9302
GAS LEAK EMERGENCY 866-900-4115*

DEPARTMENT OF
PUBLIC WORKS
CITY OF PORTSMOUTH, NH
FALL 2016

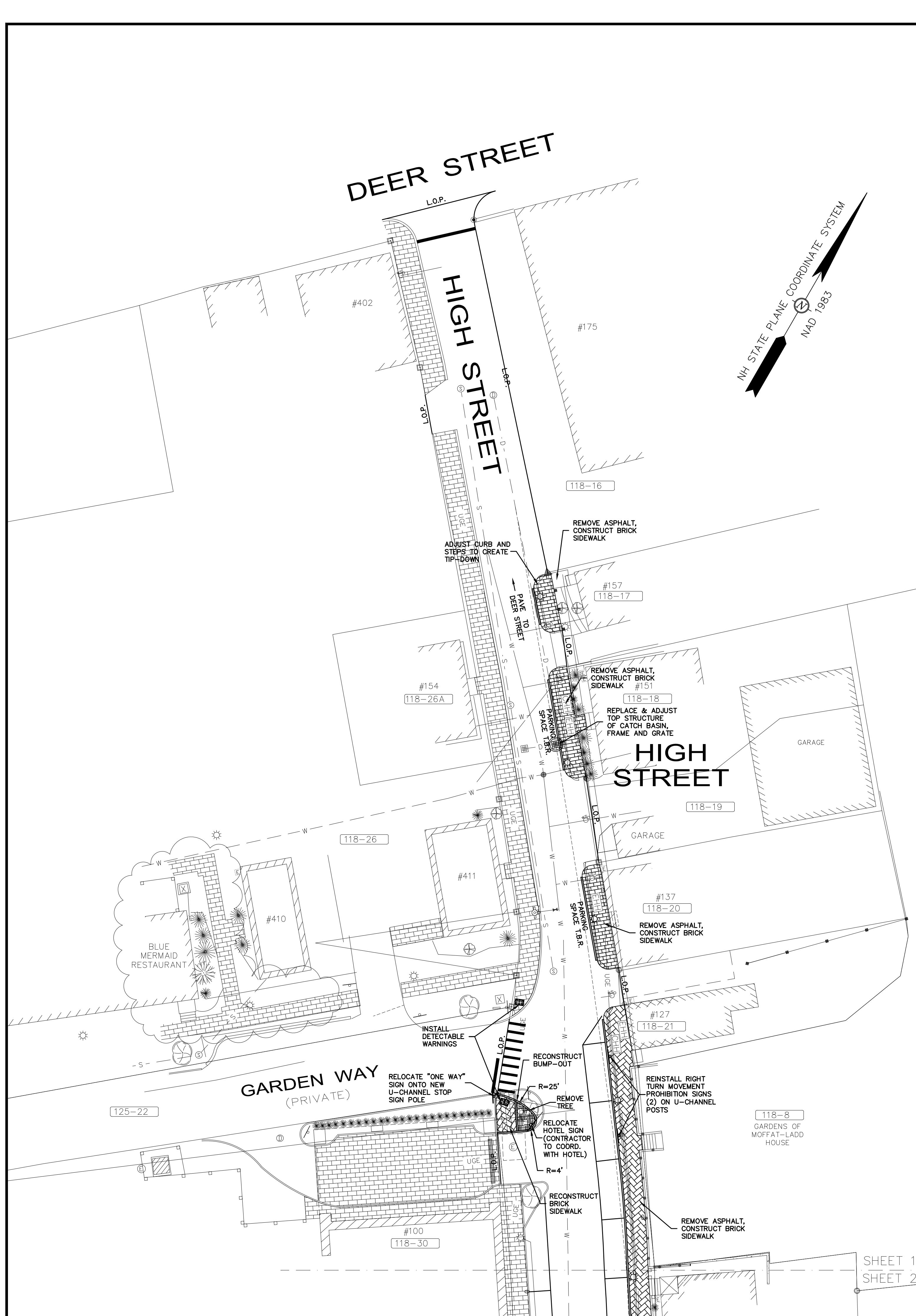

- LEGEND:**
- IRON ROD
 - IRON PIPE
 - BOUND as DESCRIBED
 - ▲ RAILROAD SPIKE
 - △ SURVEY NAIL SET
 - ⊙ DRILL HOLE
 - PHA PORTSMOUTH HOUSING AUTHORITY
 - CHAIN LINK FENCE
 - WOOD FENCE
 - WOOD FENCE POST
 - STEEL FENCE POST
 - BA BELL ATLANTIC
 - EH EXETER HAMPTON ELECTRIC CO.
 - FP FAIRPOINT
 - NETT NEW ENGLAND TEL. & TEL. CO.
 - PSNH PUBLIC SERVICE CO. OF NH
 - VZ VERIZON
 - 110-5 TAX SHEET - LOT NUMBER
 - RCRD ROCKINGHAM COUNTY REGISTRY OF DEEDS
 - EOP EDGE OF PAVEMENT
 - ETW EDGE OF TRAVELLED WAY
 - SAC SLOPED FACED ASPHALT CURB
 - VGC VERTICAL FACED GRANITE CURB
 - RWC CONCRETE RETAINING WALL
 - RWM MORTARED RETAINING WALL
 - RWS STONE RETAINING WALL
 - RWW WOOD RETAINING WALL
 - RWG GRANITE RETAINING WALL
 - ⊙ BOLLARD
 - ⊙ SIGN
 - ⊙ DOUBLE POST SIGN
 - ⊙ HANDICAP SPACE
 - ⊙ UTILITY POLE W/TRANSFORMER
 - ☆ LIGHT POLE
 - ⊙ UTILITY POLE WITH ARM & LIGHT
 - ⊙ ELECTRICAL MANHOLE
 - ⊙ ELECTRICAL CONDUIT
 - ⊙ PAD MOUNTED TRANSFORMER
 - ⊙ ELECTRICAL BOX
 - ⊙ ELECTRIC METER
 - ⊙ FIRE ALARM BOX
 - ⊙ HVAC UNIT
 - ⊙ TELEPHONE RISER
 - ⊙ TRANSFORMER
 - ⊙ GUY
 - BS/CS BLACK STEEL/COATED STEEL GAS LINE
 - PP/PL PLASTIC GAS LINE
 - ⊙ GAS METER
 - ⊙ GAS SHUT OFF
 - ⊙ GAS VALVE
 - ⊙ WATER GATE VALVE
 - ⊙ WATER SHUT OFF VALVE
 - ⊙ HYDRANT
 - ⊙ SIAMESE FIRE CONNECTION
 - ⊙ CATCH BASIN
 - ⊙ CATCH BASIN
 - ⊙ DRAIN MANHOLE
 - ⊙ SEWER MANHOLE
 - ⊙ SEWER CLEAN OUT
 - ⊙ CONIFEROUS TREE
 - ⊙ DECIDUOUS TREE
 - ⊙ CONIFEROUS SHRUB
 - ⊙ DECIDUOUS SHRUB
 - W - WATER LINE
 - S - SEWER LINE
 - D - DRAIN LINE
 - G - GAS LINE
 - FM - FORCE MAIN
 - UGE - UNDERGROUND ELECTRIC
 - UGT - UNDERGROUND TELEPHONE
 - UGW - UNDERGROUND WIRES
 - UGTV - UNDERGROUND CATV/DATA
 - OHW - OVERHEAD WIRES
 - OHE - OVERHEAD ELECTRIC
 - OHT - OVERHEAD TELEPHONE
 - CATV - OVERHEAD CATV/DATA

- NOTES:**
- THIS PLAN WAS PREPARED BY JAMES VERRA AND ASSOC., INC. FOR CIVILWORKS, INC. THIS PLAN WAS PREPARED TO SUPPORT PSNH EFFORTS TO MOVE OVERHEAD UTILITIES BELOW GROUND. THIS PLAN IS BASED ON A FIELD SURVEY BY JAMES VERRA AND ASSOC., INC. PERFORMED MARCH, APRIL 2014 AND RECORD INFORMATION.
 - SEWER LATERALS NOT DEPICTED HEREON. ONLY WATER SERVICES MARKED OUT BY THE CITY OF PORTSMOUTH SHOWN HEREON.
 - THE LOCATION OF ALL UNDERGROUND UTILITIES SHOWN HEREON ARE APPROXIMATE AND ARE BASED UPON THE FIELD LOCATION OF ALL VISIBLE STRUCTURES (IE CATCH BASINS, MANHOLES, WATER GATES ETC.) AND INFORMATION COMPILED FROM PLANS PROVIDED BY UTILITY COMPANIES AND GOVERNMENTAL AGENCIES. ALL CONTRACTORS SHOULD NOTIFY, IN WRITING, SAID AGENCIES PRIOR TO ANY EXCAVATION WORK AND CALL DIG-SAFE @ 1-888-DIG-SAFE.
 - SEWER & DRAIN CONNECTIONS SHOWN HEREON PER CITY OF PORTSMOUTH INFORMATION AND NOT FIELD VERIFIED. WATER LINES SHOWN HEREON AS DASHED LINES PER CITY OF PORTSMOUTH INFORMATION.
 - HORIZONTAL DATUM: NAD 1983 (1986 CONTROL ADJUSTMENT)
PRIMARY BM: CITY CONTROL POINT "ALBA"
ON SITE CONTROL ESTABLISH USING SURVEY GRADE GPS UNITS.

MAP-LOT	OWNER OF RECORD	DEED REF.
PARCEL "3D"	HEIRS OF JOHN E. SWANSON	1700/134
117-1	CITY OF PORTSMOUTH	SEE PLAN
117-16	CITY OF PORTSMOUTH	3348/505
117-29	36 MARKET STREET CONDOMINIUM	4864/1531
117-30	CAPITAL SECURITY FINANCIAL SERVICES, INC.	2839/1290
117-31	NANCY H. ALEXANDER	2901/148
117-32	THE 50-52 MARKET STREET REALTY TRUST	3029/2018
117-33	PETER R. EGELSTON, TRUSTEE	3121/444
117-34	KAYLA REALTY, LLC	4057/475
117-35	JESSICA REALTY, LLC	4057/434
117-36	KRS REALTY, LLC	3506/1271
117-47	PAUL D. SORLI	3036/1448
118-6	100 MARKET STREET, LLC	3485/971
118-8	THE NATIONAL SOCIETY OF COLONIAL DAMES OF AMERICA	1538/245
	THE "MOFFATT-LADD" HOUSE	
118-16	GALARO PROPERTIES, LLC	5159/2413
118-17	LEON V. & MARGARET A. FREDETTE	3224/617
118-18	MICHAEL J. LACROIX	3398/1240
118-19	MICHAEL J. LACROIX	3398/1240
118-20	KIMBERLY A. LUCY & JAMES C. LUCY, TRUSTEES	5198/598
118-21	KIMBERLY A. LUCY & JAMES C. LUCY, TRUSTEES	5198/600
118-22	JOSEPH J. & JENNIFER ALMEIDA	4248/2694
118-23	HIGH HANOVER CONDOMINIUM	2546/2583
118-24	JEFFREY H. MARPLE, TRUSTEE	5291/266
118-24-1	JEFFREY H. MARPLE, TRUSTEE	5291/266
118-26	THE HILL OF PORTSMOUTH, N.H. CONDOMINIUM	3538/2793
118-26A	NEW HAMPSHIRE LEGAL ASSISTANCE, INC.	2337/258
118-30	PARADE HOTEL, LLC	4441/1747
125-22	PARADE RESIDENCE HOTEL, LLC	5011/121

NO.	DATE	BY	REVISION

CONSTRUCTION PLAN 1
FOR
HIGH-HANOVER AREA
RESTORATION PROJECT
PORTSMOUTH, NEW HAMPSHIRE



DESIGN: RAF
SCALE: 1"=20'
DATE: 7/15/16
SHEET: 2 OF 9
PROJECT # 7199

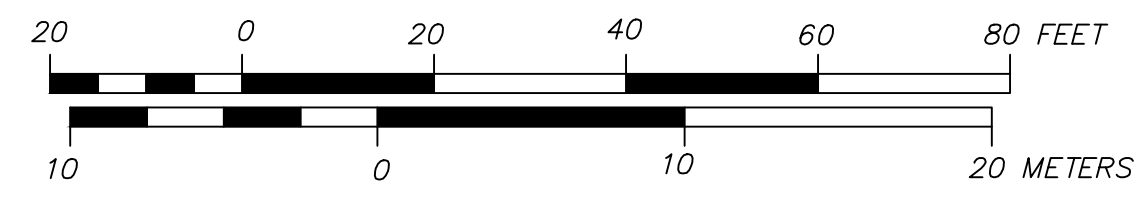

SHEET 1
SHEET 2

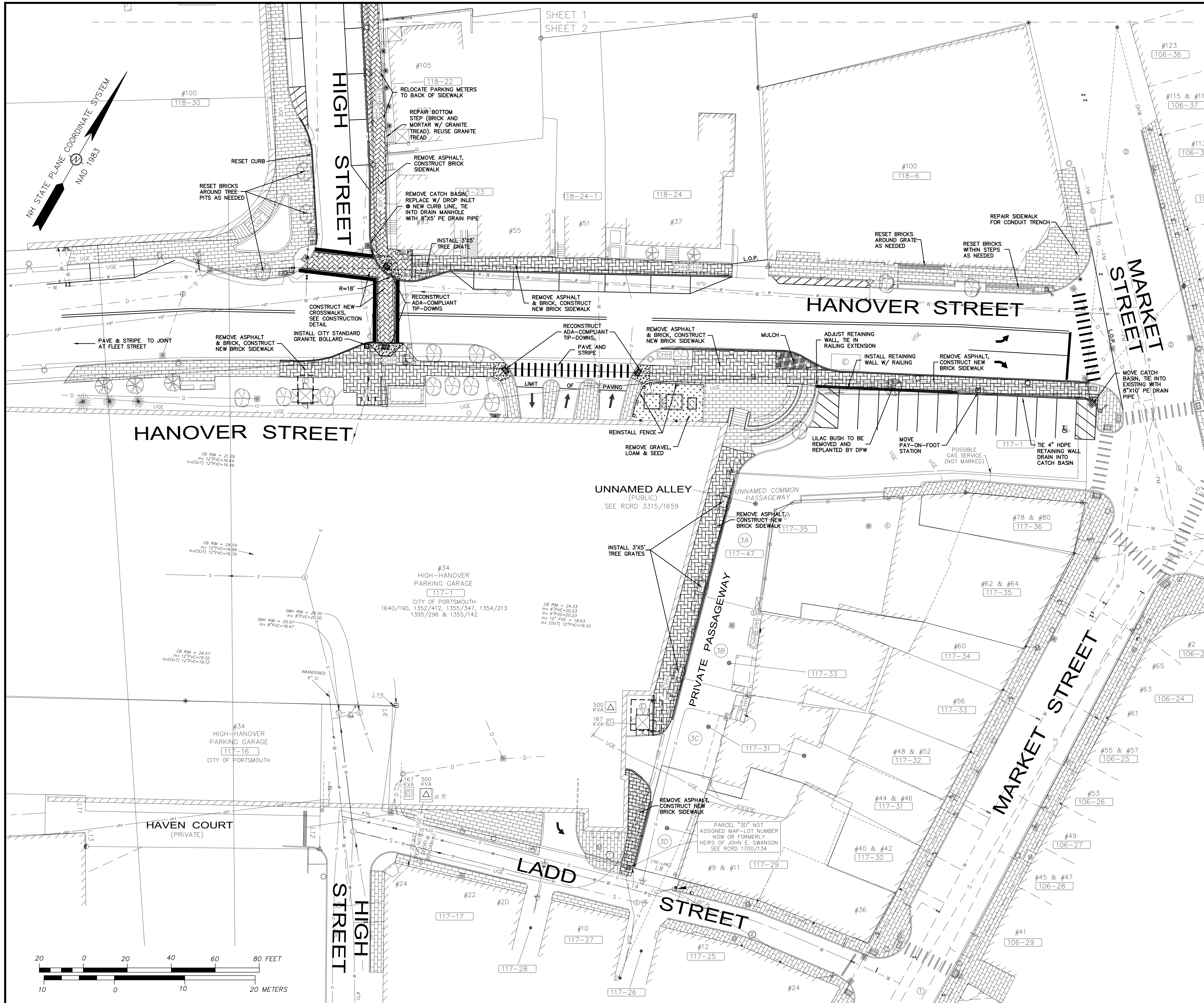

- LEGEND:**
- IRON ROD
 - IRON PIPE
 - BOUND as DESCRIBED
 - ▲ RAILROAD SPIKE
 - △ SURVEY NAIL SET
 - DRILL HOLE
 - PHA PORTSMOUTH HOUSING AUTHORITY
 - CHAIN LINK FENCE
 - WOOD FENCE
 - WOOD FENCE POST
 - STEEL FENCE POST
 - BA BELL ATLANTIC
 - EH EXETER HAMPTON ELECTRIC CO.
 - FP FAIRPOINT
 - NETT NEW ENGLAND TEL. & TEL. CO.
 - PSNH PUBLIC SERVICE CO. OF NH
 - VZ VERIZON
 - 110-5 TAX SHEET - LOT NUMBER
 - RCRD ROCKINGHAM COUNTY REGISTRY OF DEEDS
 - EOP EDGE OF PAVEMENT
 - ETW EDGE OF TRAVELLED WAY
 - SAC SLOPED FACED ASPHALT CURB
 - VGC VERTICAL FACED GRANITE CURB
 - RWC CONCRETE RETAINING WALL
 - RWM MORTARED RETAINING WALL
 - RWS STONE RETAINING WALL
 - RWW WOOD RETAINING WALL
 - RWG GRANITE RETAINING WALL
 - BOLLARD
 - SIGN
 - DOUBLE POST SIGN
 - HANDICAP SPACE
 - UTILITY POLE W/TRANSFORMER
 - LIGHT POLE
 - UTILITY POLE WITH ARM & LIGHT
 - ELECTRICAL MANHOLE
 - ELECTRICAL CONDUIT
 - PAD MOUNTED TRANSFORMER
 - ELECTRICAL BOX
 - ELECTRIC METER
 - FIRE ALARM BOX
 - HVAC UNIT
 - TELEPHONE RISER
 - TRANSFORMER
 - GUY
 - BS/CS BLACK STEEL/COATED STEEL GAS LINE
 - PP/PL PLASTIC GAS LINE
 - GAS METER
 - GAS SHUT OFF
 - GAS VALVE
 - WATER GATE VALVE
 - WATER SHUT OFF VALVE
 - HYDRANT
 - SIAMESE FIRE CONNECTION
 - CATCH BASIN
 - CATCH BASIN
 - DRAIN MANHOLE
 - SEWER MANHOLE
 - SEWER CLEAN OUT
 - CONIFEROUS TREE
 - DECIDUOUS TREE
 - CONIFEROUS SHRUB
 - DECIDUOUS SHRUB
 - W WATER LINE
 - S SEWER LINE
 - D DRAIN LINE
 - G GAS LINE
 - FM FORCE MAIN
 - UGE UNDERGROUND ELECTRIC
 - UGT UNDERGROUND TELEPHONE
 - UGW UNDERGROUND WIRES
 - UGTV UNDERGROUND CATV/DATA
 - OHW OVERHEAD WIRES
 - OHE OVERHEAD ELECTRIC
 - OHT OVERHEAD TELEPHONE
 - CATV OVERHEAD CATV/DATA

No.	DATE	BY	REVISION

CONSTRUCTION PLAN 2
FOR
HIGH-HANOVER AREA
RESTORATION PROJECT
PORTSMOUTH, NEW HAMPSHIRE



DESIGN: RAF
SCALE: 1"=20'
DATE: 7/15/16
SHEET: 3 OF 9
PROJECT # 7199

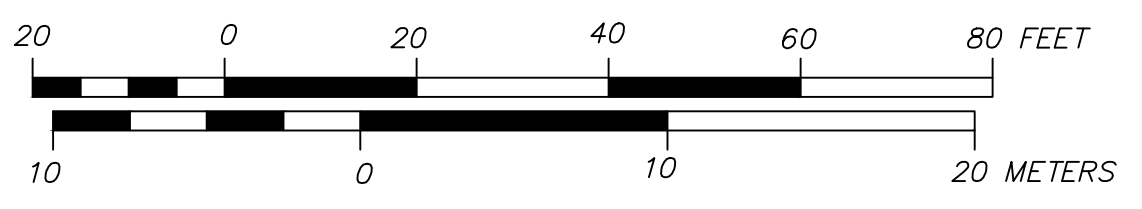

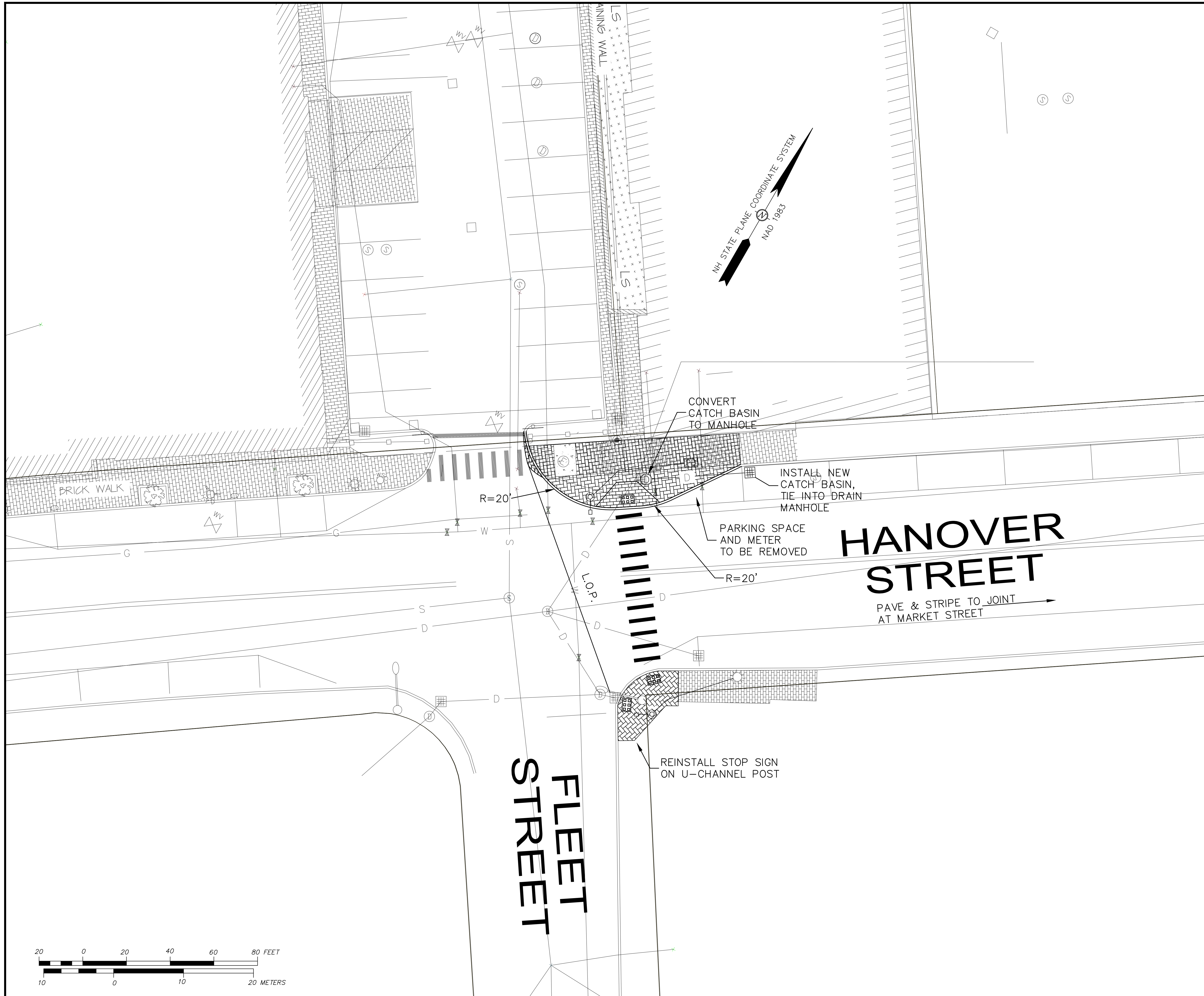

- LEGEND:**
- IRON ROD
 - IRON PIPE
 - BOUND as DESCRIBED
 - ▲ RAILROAD SPIKE
 - △ SURVEY NAIL SET
 - ⊙ DRILL HOLE
 - PHA PORTSMOUTH HOUSING AUTHORITY
 - CHAIN LINK FENCE
 - WOOD FENCE
 - WOOD FENCE POST
 - STEEL FENCE POST
 - BA BELL ATLANTIC
 - EH EXETER HAMPTON ELECTRIC CO.
 - FP FAIRPOINT
 - NETT NEW ENGLAND TEL. & TEL. CO.
 - PSNH PUBLIC SERVICE CO. OF NH
 - VZ VERIZON
 - 110-5 TAX SHEET - LOT NUMBER
 - RCRD ROCKINGHAM COUNTY REGISTRY OF DEEDS
 - EOP EDGE OF PAVEMENT
 - ETW EDGE OF TRAVELLED WAY
 - SAC SLOPED FACED ASPHALT CURB
 - VGC VERTICAL FACED GRANITE CURB
 - RWC CONCRETE RETAINING WALL
 - RWM MORTARED RETAINING WALL
 - RWS STONE RETAINING WALL
 - RWW WOOD RETAINING WALL
 - RWG GRANITE RETAINING WALL
 - ⊙ BOLLARD
 - SIGN
 - DOUBLE POST SIGN
 - HANDICAP SPACE
 - UTILITY POLE W/TRANSFORMER
 - LIGHT POLE
 - UTILITY POLE WITH ARM & LIGHT
 - ⊙ ELECTRICAL MANHOLE
 - ELECTRICAL CONDUIT
 - PAD MOUNTED TRANSFORMER
 - ELECTRICAL BOX
 - ELECTRIC METER
 - FIRE ALARM BOX
 - HVAC UNIT
 - TELEPHONE RISER
 - TRANSFORMER
 - GUY
 - BS/CS BLACK STEEL/COATED STEEL GAS LINE
 - PP/PL PLASTIC GAS LINE
 - GAS METER
 - GAS SHUT OFF
 - GAS VALVE
 - WATER GATE VALVE
 - WATER SHUT OFF VALVE
 - HYDRANT
 - SIAMESE FIRE CONNECTION
 - CATCH BASIN
 - CATCH BASIN
 - DRAIN MANHOLE
 - SEWER MANHOLE
 - SEWER CLEAN OUT
 - CONIFEROUS TREE
 - DECIDUOUS TREE
 - CONIFEROUS SHRUB
 - DECIDUOUS SHRUB
 - W WATER LINE
 - S SEWER LINE
 - D DRAIN LINE
 - G GAS LINE
 - FM FORCE MAIN
 - UGE UNDERGROUND ELECTRIC
 - UGT UNDERGROUND TELEPHONE
 - UGW UNDERGROUND WIRES
 - UGTV UNDERGROUND CATV/DATA
 - OHW OVERHEAD WIRES
 - OHE OVERHEAD ELECTRIC
 - OHT OVERHEAD TELEPHONE
 - CATV OVERHEAD CATV/DATA

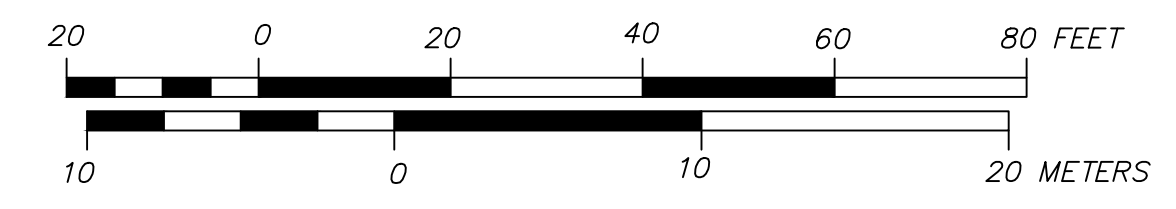

No.	DATE	BY	REVISION

CONSTRUCTION PLAN 3
FOR
HIGH-HANOVER AREA
RESTORATION PROJECT
 PORTSMOUTH, NEW HAMPSHIRE



DESIGN: RAF
 SCALE: 1"=20'
 DATE: 7/15/16
 SHEET: 4 OF 9
 PROJECT # 7199

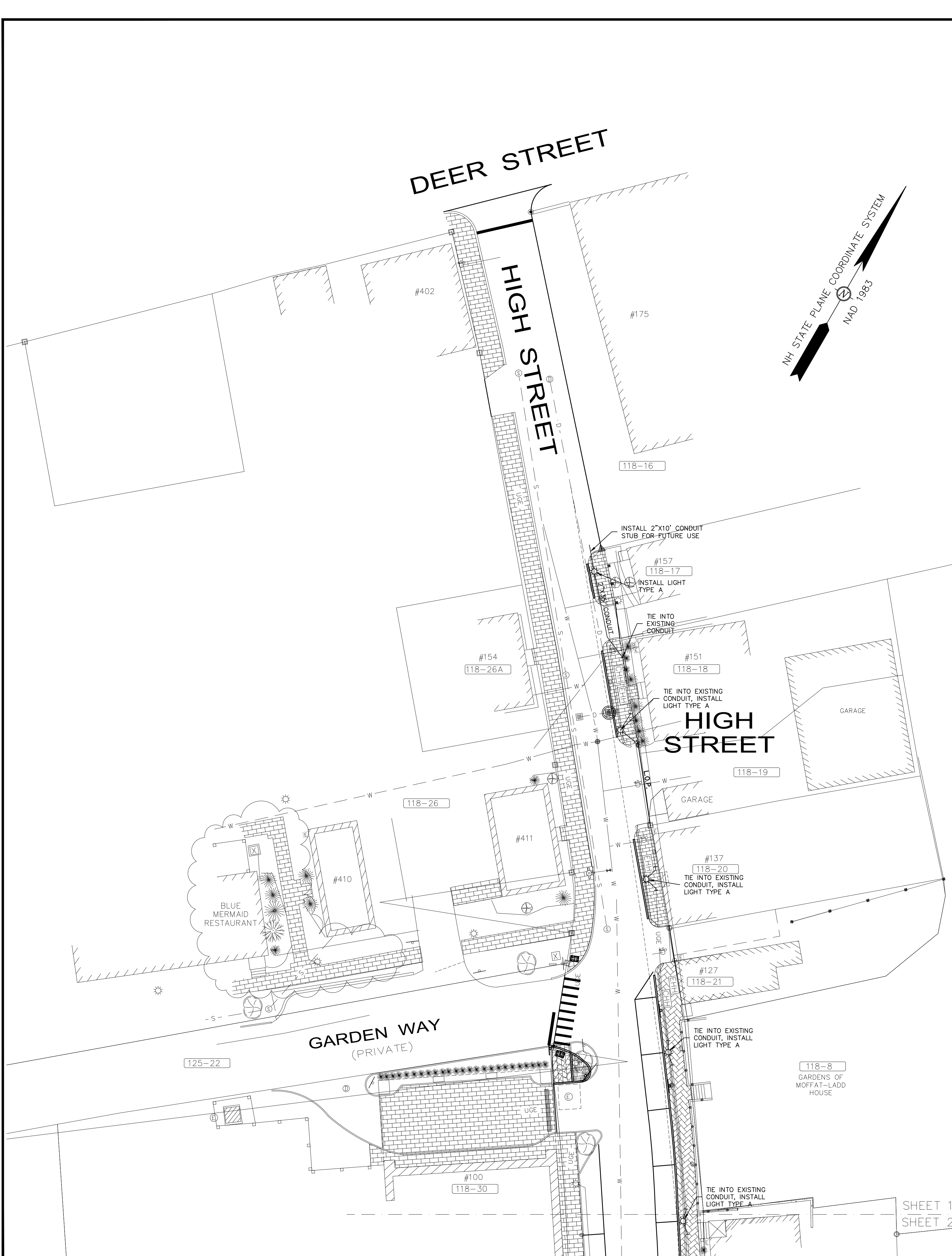

- LEGEND:**
- IRON ROD
 - IRON PIPE
 - BOUND as DESCRIBED
 - ▲ RAILROAD SPIKE
 - △ SURVEY NAIL SET
 - ⊙ DRILL HOLE
 - PHA PORTSMOUTH HOUSING AUTHORITY
 - CHAIN LINK FENCE
 - WOOD FENCE
 - WOOD FENCE POST
 - STEEL FENCE POST
 - BA BELL ATLANTIC
 - EH EXETER HAMPTON ELECTRIC CO.
 - FP FAIRPOINT
 - NETT NEW ENGLAND TEL. & TEL. CO.
 - PSNH PUBLIC SERVICE CO. OF NH
 - VZ VERIZON
 - 110-5 TAX SHEET - LOT NUMBER
 - RCRD ROCKINGHAM COUNTY REGISTRY OF DEEDS
 - EOP EDGE OF PAVEMENT
 - ETW EDGE OF TRAVELLED WAY
 - SAC SLOPED FACED ASPHALT CURB
 - VGC VERTICAL FACED GRANITE CURB
 - RWC CONCRETE RETAINING WALL
 - RWM MORTARED RETAINING WALL
 - RWS STONE RETAINING WALL
 - RWW WOOD RETAINING WALL
 - RWG GRANITE RETAINING WALL
 - ⊙ BOLLARD
 - ⊙ SIGN
 - ⊙ DOUBLE POST SIGN
 - ⊙ HANDICAP SPACE
 - ⊙ UTILITY POLE W/TRANSFORMER
 - ⊙ LIGHT POLE
 - ⊙ UTILITY POLE WITH ARM & LIGHT
 - ⊙ ELECTRICAL MANHOLE
 - ⊙ ELECTRICAL CONDUIT
 - ⊙ PAD MOUNTED TRANSFORMER
 - ⊙ ELECTRICAL BOX
 - ⊙ ELECTRIC METER
 - ⊙ FIRE ALARM BOX
 - ⊙ HVAC UNIT
 - ⊙ TELEPHONE RISER
 - ⊙ TRANSFORMER
 - ⊙ GUY
 - BS/CS BLACK STEEL/COATED STEEL GAS LINE
 - PP/PL PLASTIC GAS LINE
 - ⊙ GAS METER
 - ⊙ GAS SHUT OFF
 - ⊙ GAS VALVE
 - ⊙ WATER GATE VALVE
 - ⊙ WATER SHUT OFF VALVE
 - ⊙ HYDRANT
 - ⊙ SIAMESE FIRE CONNECTION
 - ⊙ CATCH BASIN
 - ⊙ CATCH BASIN
 - ⊙ DRAIN MANHOLE
 - ⊙ SEWER MANHOLE
 - ⊙ SEWER CLEAN OUT
 - ⊙ CONIFEROUS TREE
 - ⊙ DECIDUOUS TREE
 - ⊙ CONIFEROUS SHRUB
 - ⊙ DECIDUOUS SHRUB
 - W- WATER LINE
 - S- SEWER LINE
 - D- DRAIN LINE
 - G- GAS LINE
 - FM- FORCE MAIN
 - UGE- UNDERGROUND ELECTRIC
 - UGT- UNDERGROUND TELEPHONE
 - UGW- UNDERGROUND WIRES
 - UGTV- UNDERGROUND CATV/DATA
 - OHW- OVERHEAD WIRES
 - OHE- OVERHEAD ELECTRIC
 - OHT- OVERHEAD TELEPHONE
 - CATV- OVERHEAD CATV/DATA

- NOTES:**
- THIS PLAN WAS PREPARED BY JAMES VERRA AND ASSOC., INC. FOR CIVILWORKS, INC. THIS PLAN WAS PREPARED TO SUPPORT PSNH EFFORTS TO MOVE OVERHEAD UTILITIES BELOW GROUND. THIS PLAN IS BASED ON A FIELD SURVEY BY JAMES VERRA AND ASSOC., INC. PERFORMED MARCH, APRIL 2014 AND RECORD INFORMATION.
 - SEWER LATERALS NOT DEPICTED HEREON. ONLY WATER SERVICES MARKED OUT BY THE CITY OF PORTSMOUTH SHOWN HEREON.
 - THE LOCATION OF ALL UNDERGROUND UTILITIES SHOWN HEREON ARE APPROXIMATE AND ARE BASED UPON THE FIELD LOCATION OF ALL VISIBLE STRUCTURES (IE CATCH BASINS, MANHOLES, WATER GATES ETC.) AND INFORMATION COMPILED FROM PLANS PROVIDED BY UTILITY COMPANIES AND GOVERNMENTAL AGENCIES. ALL CONTRACTORS SHOULD NOTIFY, IN WRITING, SAID AGENCIES PRIOR TO ANY EXCAVATION WORK AND CALL DIG-SAFE @ 1-888-DIG-SAFE.
 - SEWER & DRAIN CONNECTIONS SHOWN HEREON PER CITY OF PORTSMOUTH INFORMATION AND NOT FIELD VERIFIED. WATER LINES SHOWN HEREON AS DASHED LINES PER CITY OF PORTSMOUTH INFORMATION.
 - HORIZONTAL DATUM: NAD 1983 (1986 CONTROL ADJUSTMENT)
PRIMARY BM: CITY CONTROL POINT "ALBA"
ON SITE CONTROL ESTABLISH USING SURVEY GRADE GPS UNITS.

MAP-LOT	OWNER OF RECORD	DEED REF.
PARCEL "3D"	HEIRS OF JOHN E. SWANSON	1700/134
117-1	CITY OF PORTSMOUTH	SEE PLAN
117-16	CITY OF PORTSMOUTH	3348/505
117-29	36 MARKET STREET CONDOMINIUM	4864/1531
117-30	CAPITAL SECURITY FINANCIAL SERVICES, INC.	2839/1290
117-31	NANCY H. ALEXANDER	2901/148
117-32	THE 50-52 MARKET STREET REALTY TRUST	3029/2018
117-33	PETER R. EGELSTON, TRUSTEE	3121/444
117-34	KAYLA REALTY, LLC	4057/475
117-35	JESSICA REALTY, LLC	4057/434
117-36	KRS REALTY, LLC	3506/1271
117-47	PAUL D. SORLI	3036/1448
118-6	100 MARKET STREET, LLC	3485/971
118-8	THE NATIONAL SOCIETY OF COLONIAL DAMES OF AMERICA	1538/245
	THE "MOFFATT-LADD" HOUSE	
118-16	GALARO PROPERTIES, LLC	5159/2413
118-17	LEON V. & MARGARET A. FREDETTE	3224/617
118-18	MICHAEL J. LACROIX	3398/1240
118-19	MICHAEL J. LACROIX	3398/1240
118-20	KIMBERLY A. LUCY & JAMES C. LUCY, TRUSTEES	5198/598
118-21	KIMBERLY A. LUCY & JAMES C. LUCY, TRUSTEES	5198/600
118-22	JOSEPH J. & JENNIFER ALMEIDA	4248/2694
118-23	HIGH HANOVER CONDOMINIUM	2546/2583
118-24	JEFFREY H. MARPLE, TRUSTEE	5291/266
118-24-1	JEFFREY H. MARPLE, TRUSTEE	5291/266
118-26	THE HILL OF PORTSMOUTH, N.H. CONDOMINIUM	3538/2793
118-26A	NEW HAMPSHIRE LEGAL ASSISTANCE, INC.	2337/258
118-30	PARADE HOTEL, LLC	4441/1747
125-22	PARADE RESIDENCE HOTEL, LLC	5011/121

NO.	DATE	BY	REVISION

**LIGHTING PLAN 1
FOR
HIGH-HANOVER AREA
RESTORATION PROJECT
PORTSMOUTH, NEW HAMPSHIRE**



DESIGN: RAF
SCALE: 1"=20'
DATE: 7/15/16
SHEET: 5 OF 9
PROJECT # 7199

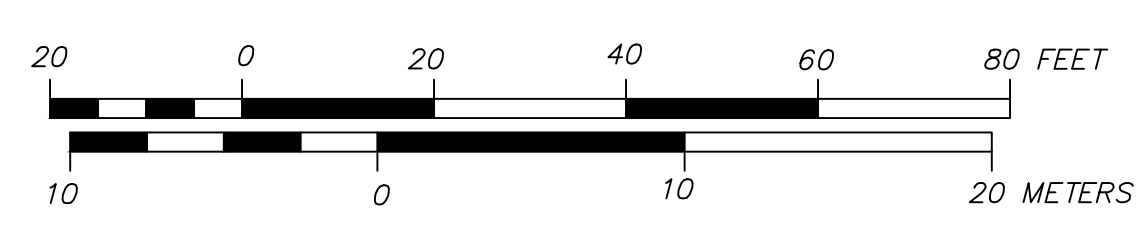

SHEET 1
SHEET 2

NH STATE PLANE COORDINATE SYSTEM
NAD 1983

SHEET 1
SHEET 2

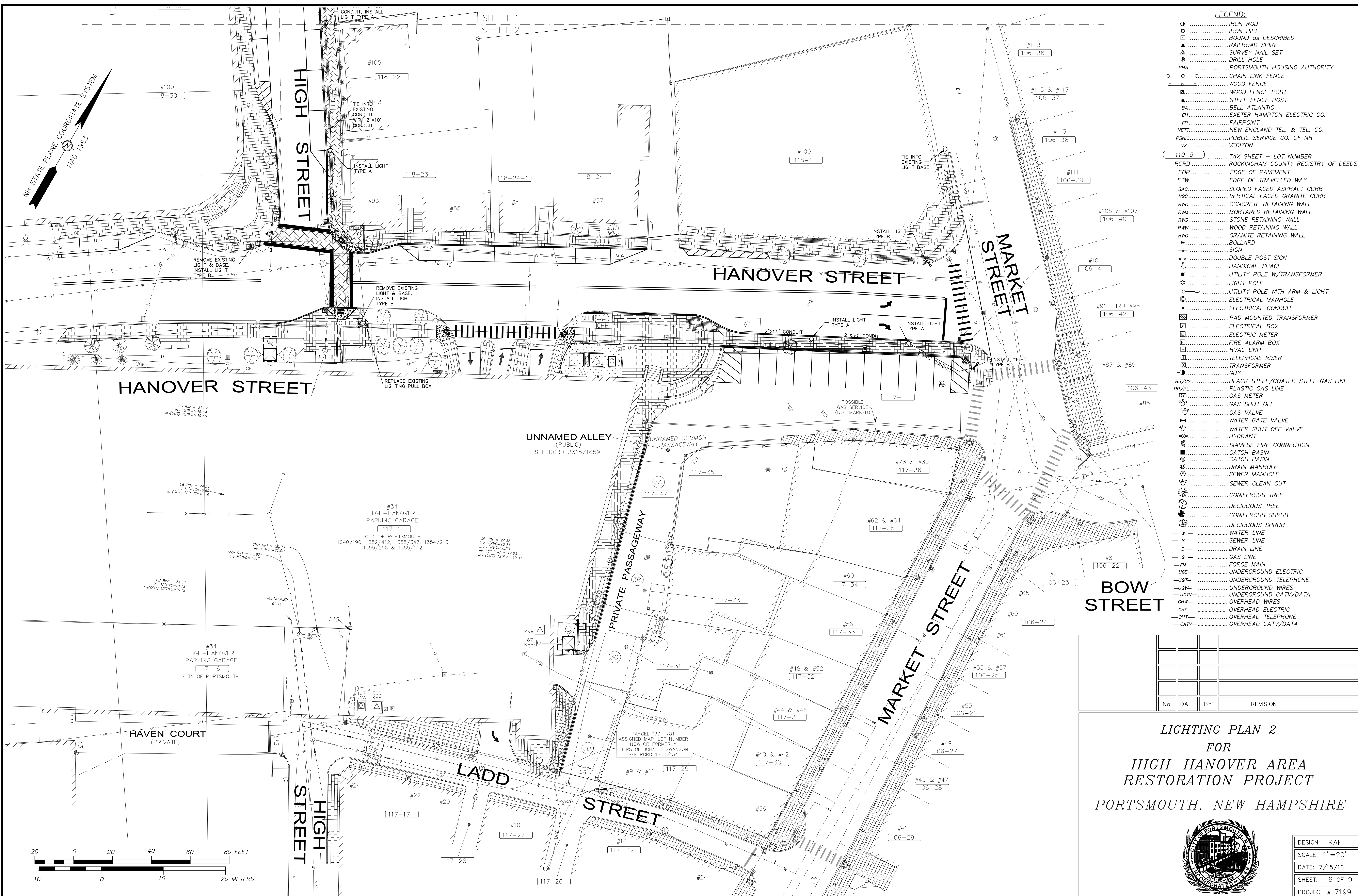

- LEGEND:**
- IRON ROD
 - IRON PIPE
 - BOUND as DESCRIBED
 - ▲ RAILROAD SPIKE
 - △ SURVEY NAIL SET
 - ⊙ DRILL HOLE
 - PHA PORTSMOUTH HOUSING AUTHORITY
 - CHAIN LINK FENCE
 - WOOD FENCE
 - WOOD FENCE POST
 - STEEL FENCE POST
 - BA BELL ATLANTIC
 - EH EXETER HAMPTON ELECTRIC CO.
 - FP FAIRPOINT
 - NETT NEW ENGLAND TEL. & TEL. CO.
 - PSNH PUBLIC SERVICE CO. OF NH
 - VZ VERIZON
 - 110-5 TAX SHEET - LOT NUMBER
 - RCRD ROCKINGHAM COUNTY REGISTRY OF DEEDS
 - EOP EDGE OF PAVEMENT
 - ETW EDGE OF TRAVELLED WAY
 - SAC SLOPED FACED ASPHALT CURB
 - VGC VERTICAL FACED GRANITE CURB
 - RWC CONCRETE RETAINING WALL
 - RWM MORTARED RETAINING WALL
 - RWS STONE RETAINING WALL
 - RWW WOOD RETAINING WALL
 - RWG GRANITE RETAINING WALL
 - ⊕ BOLLARD
 - ⊕ SIGN
 - ⊕ DOUBLE POST SIGN
 - ♿ HANDICAP SPACE
 - ⊕ UTILITY POLE W/TRANSFORMER
 - ⊕ LIGHT POLE
 - ⊕ UTILITY POLE WITH ARM & LIGHT
 - ⊕ ELECTRICAL MANHOLE
 - ⊕ ELECTRICAL CONDUIT
 - ⊕ PAD MOUNTED TRANSFORMER
 - ⊕ ELECTRICAL BOX
 - ⊕ ELECTRIC METER
 - ⊕ FIRE ALARM BOX
 - ⊕ HVAC UNIT
 - ⊕ TELEPHONE RISER
 - ⊕ TRANSFORMER
 - ⊕ GUY
 - BS/CS BLACK STEEL/COATED STEEL GAS LINE
 - PP/PL PLASTIC GAS LINE
 - ⊕ GAS METER
 - ⊕ GAS SHUT OFF
 - ⊕ GAS VALVE
 - ⊕ WATER GATE VALVE
 - ⊕ WATER SHUT OFF VALVE
 - ⊕ HYDRANT
 - ⊕ SIAMESE FIRE CONNECTION
 - ⊕ CATCH BASIN
 - ⊕ CATCH BASIN
 - ⊕ DRAIN MANHOLE
 - ⊕ SEWER MANHOLE
 - ⊕ SEWER CLEAN OUT
 - ⊕ CONIFEROUS TREE
 - ⊕ DECIDUOUS TREE
 - ⊕ CONIFEROUS SHRUB
 - ⊕ DECIDUOUS SHRUB
 - W WATER LINE
 - S SEWER LINE
 - D DRAIN LINE
 - G GAS LINE
 - FM FORCE MAIN
 - UGE UNDERGROUND ELECTRIC
 - UGT UNDERGROUND TELEPHONE
 - UGW UNDERGROUND WIRES
 - UGTW UNDERGROUND CATV/DATA
 - OHW OVERHEAD WIRES
 - OHE OVERHEAD ELECTRIC
 - OHT OVERHEAD TELEPHONE
 - CATV OVERHEAD CATV/DATA

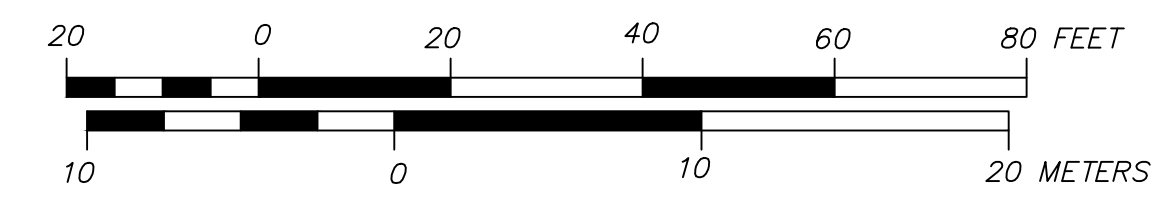

No.	DATE	BY	REVISION

LIGHTING PLAN 2
FOR
HIGH-HANOVER AREA
RESTORATION PROJECT
PORTSMOUTH, NEW HAMPSHIRE



DESIGN: RAF
SCALE: 1"=20'
DATE: 7/15/16
SHEET: 6 OF 9
PROJECT # 7199

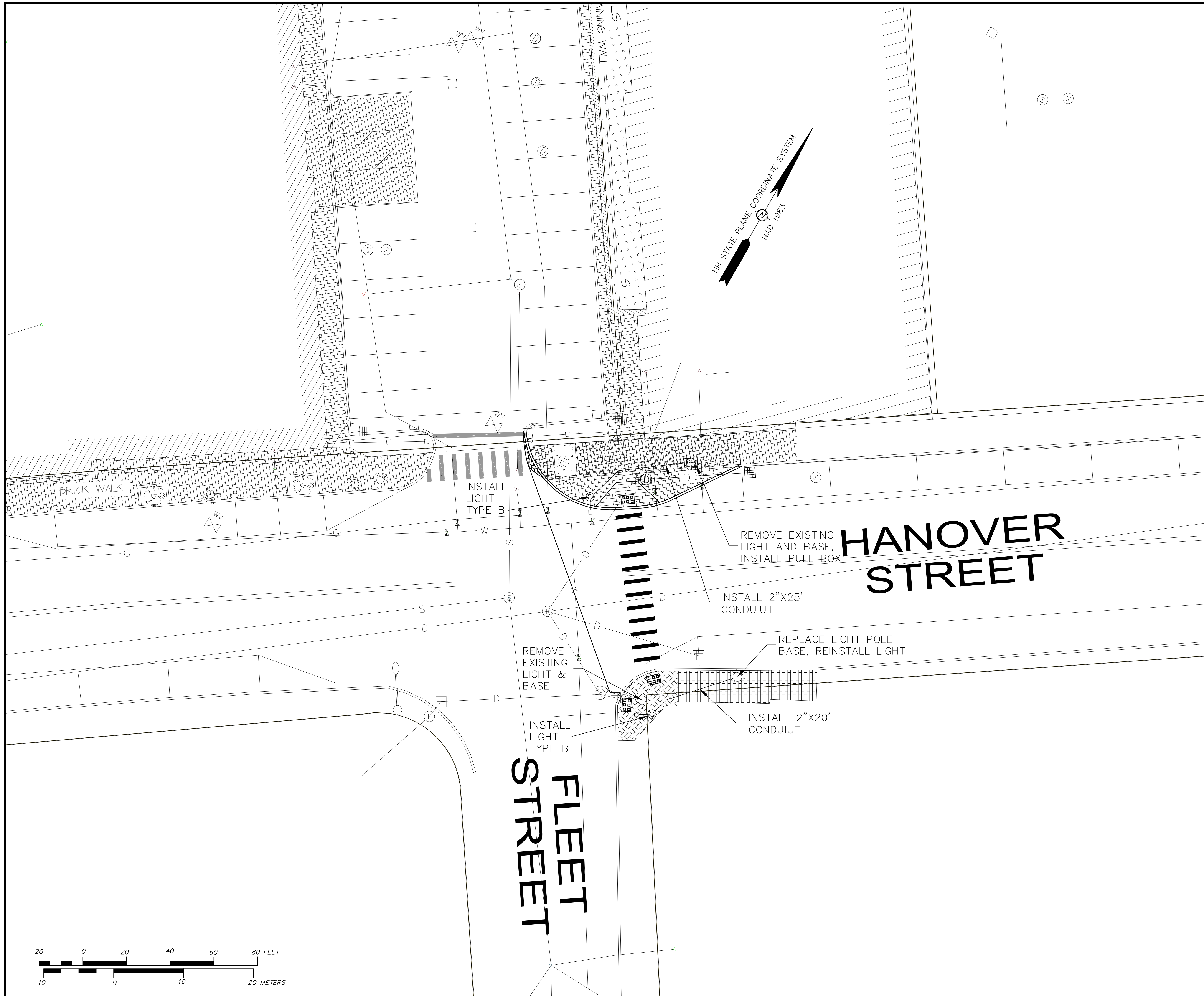

- LEGEND:**
- IRON ROD
 - IRON PIPE
 - BOUND as DESCRIBED
 - ▲ RAILROAD SPIKE
 - △ SURVEY NAIL SET
 - ⊙ DRILL HOLE
 - PHA PORTSMOUTH HOUSING AUTHORITY
 - CHAIN LINK FENCE
 - WOOD FENCE
 - WOOD FENCE POST
 - STEEL FENCE POST
 - BA BELL ATLANTIC
 - EH EXETER HAMPTON ELECTRIC CO.
 - FP FAIRPOINT
 - NETT NEW ENGLAND TEL. & TEL. CO.
 - PSNH PUBLIC SERVICE CO. OF NH
 - VZ VERIZON
 - 110-5 TAX SHEET - LOT NUMBER
 - RCRD ROCKINGHAM COUNTY REGISTRY OF DEEDS
 - EOP EDGE OF PAVEMENT
 - ETW EDGE OF TRAVELLED WAY
 - SAC SLOPED FACED ASPHALT CURB
 - VGC VERTICAL FACED GRANITE CURB
 - RWC CONCRETE RETAINING WALL
 - RWM MORTARED RETAINING WALL
 - RWS STONE RETAINING WALL
 - RWW WOOD RETAINING WALL
 - RWG GRANITE RETAINING WALL
 - ⊙ BOLLARD
 - SIGN
 - DOUBLE POST SIGN
 - HANDICAP SPACE
 - UTILITY POLE W/TRANSFORMER
 - LIGHT POLE
 - UTILITY POLE WITH ARM & LIGHT
 - ELECTRICAL MANHOLE
 - ELECTRICAL CONDUIT
 - PAD MOUNTED TRANSFORMER
 - ELECTRICAL BOX
 - ELECTRIC METER
 - FIRE ALARM BOX
 - HVAC UNIT
 - TELEPHONE RISER
 - TRANSFORMER
 - GUY
 - BS/CS BLACK STEEL/COATED STEEL GAS LINE
 - PP/PL PLASTIC GAS LINE
 - GAS METER
 - GAS SHUT OFF
 - GAS VALVE
 - WATER GATE VALVE
 - WATER SHUT OFF VALVE
 - HYDRANT
 - SIAMESE FIRE CONNECTION
 - CATCH BASIN
 - CATCH BASIN
 - DRAIN MANHOLE
 - SEWER MANHOLE
 - SEWER CLEAN OUT
 - CONIFEROUS TREE
 - DECIDUOUS TREE
 - CONIFEROUS SHRUB
 - DECIDUOUS SHRUB
 - W WATER LINE
 - S SEWER LINE
 - D DRAIN LINE
 - G GAS LINE
 - FM FORCE MAIN
 - UGE UNDERGROUND ELECTRIC
 - UGT UNDERGROUND TELEPHONE
 - UGW UNDERGROUND WIRES
 - UGTV UNDERGROUND CATV/DATA
 - OHW OVERHEAD WIRES
 - OHE OVERHEAD ELECTRIC
 - OHT OVERHEAD TELEPHONE
 - CATV OVERHEAD CATV/DATA

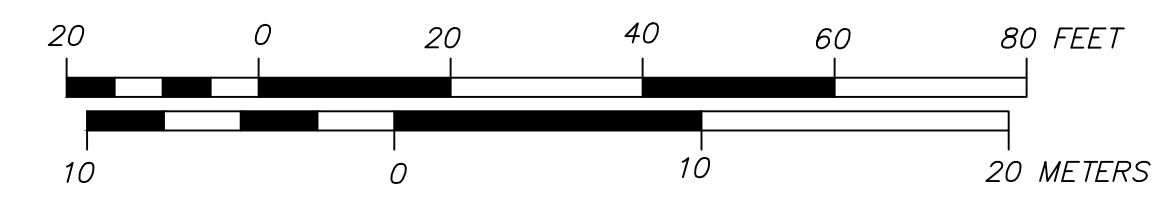

No.	DATE	BY	REVISION

LIGHTING PLAN 3
FOR
HIGH-HANOVER AREA
RESTORATION PROJECT
PORTSMOUTH, NEW HAMPSHIRE



DESIGN: RAF
SCALE: 1"=20'
DATE: 7/15/16
SHEET: 7 of 9
PROJECT # 7199

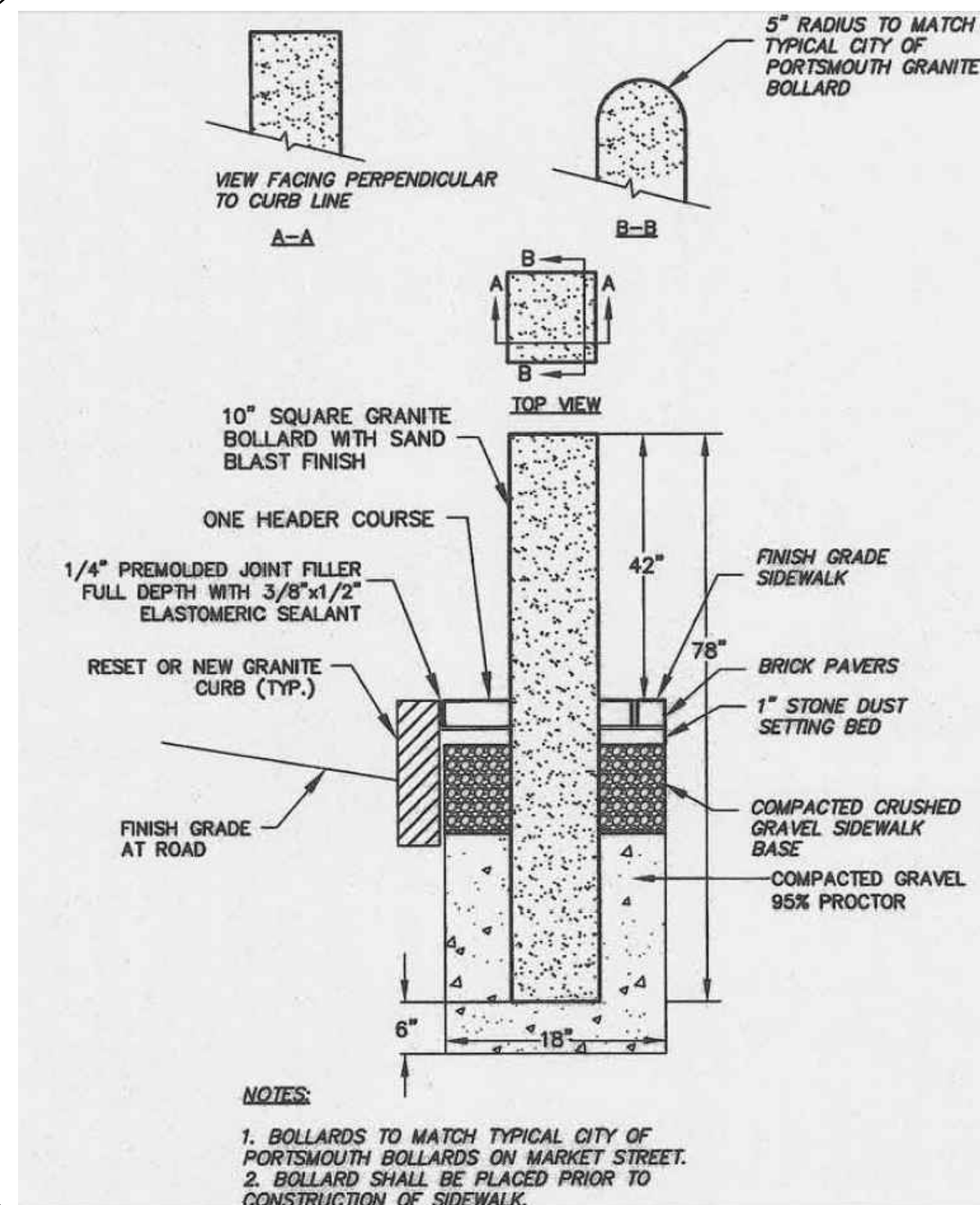

GRANITE BOLLARD
DETAIL
NOT TO SCALE

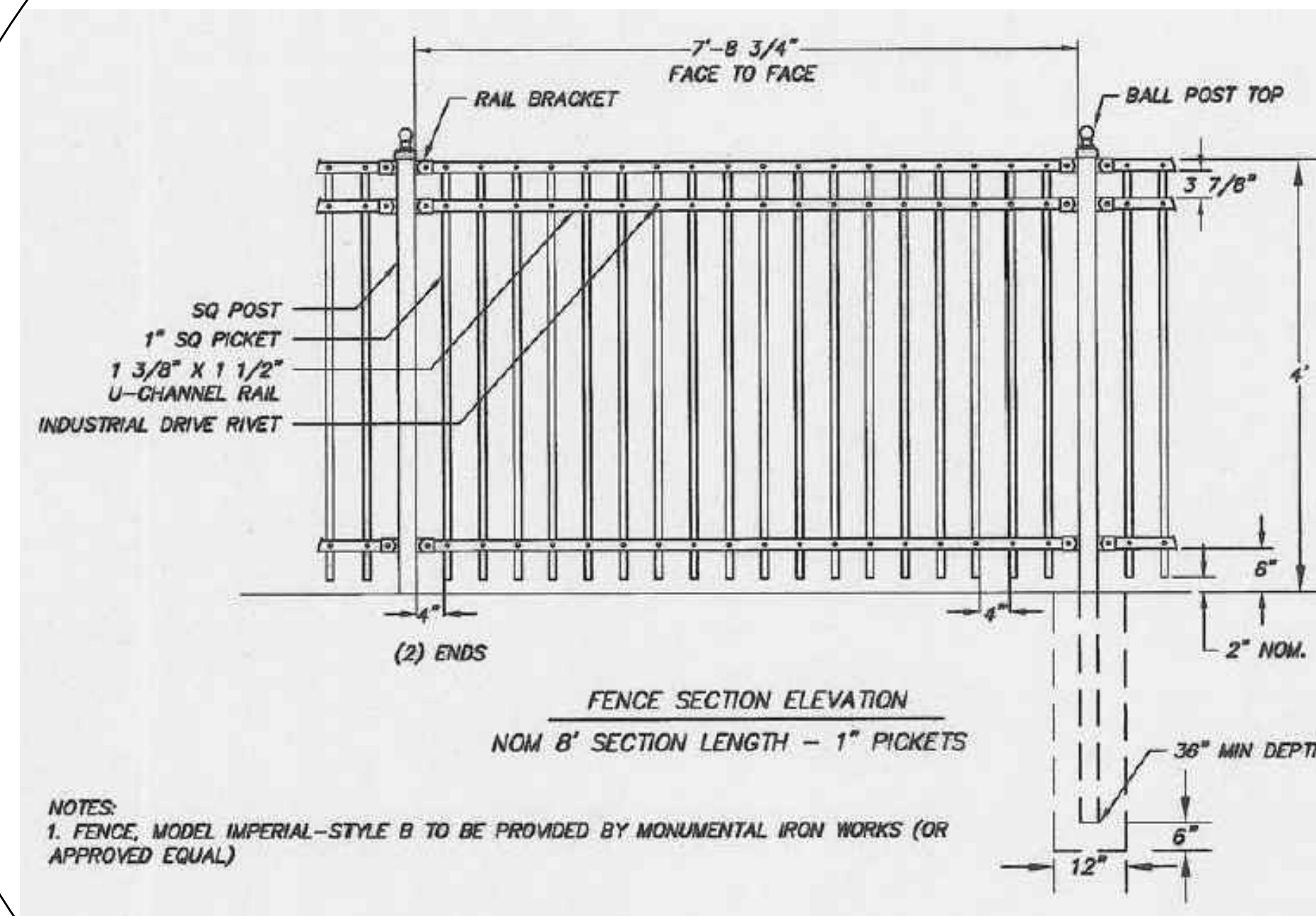

ORNAMENTAL STEEL FENCE
DETAIL
NOT TO SCALE

No.	DATE	BY	REVISION

CONSTRUCTION DETAILS 2
FOR
HIGH-HANOVER AREA
RESTORATION PROJECT
PORTSMOUTH, NEW HAMPSHIRE



DESIGN: RAF
SCALE: 1"=20'
DATE: 7/15/16
SHEET: 8 OF 9
PROJECT # 7199