

STATE STREET SIDEWALK REPLACEMENT

PUBLIC WORKS PROJECT #7149

BID NUMBER 10-12

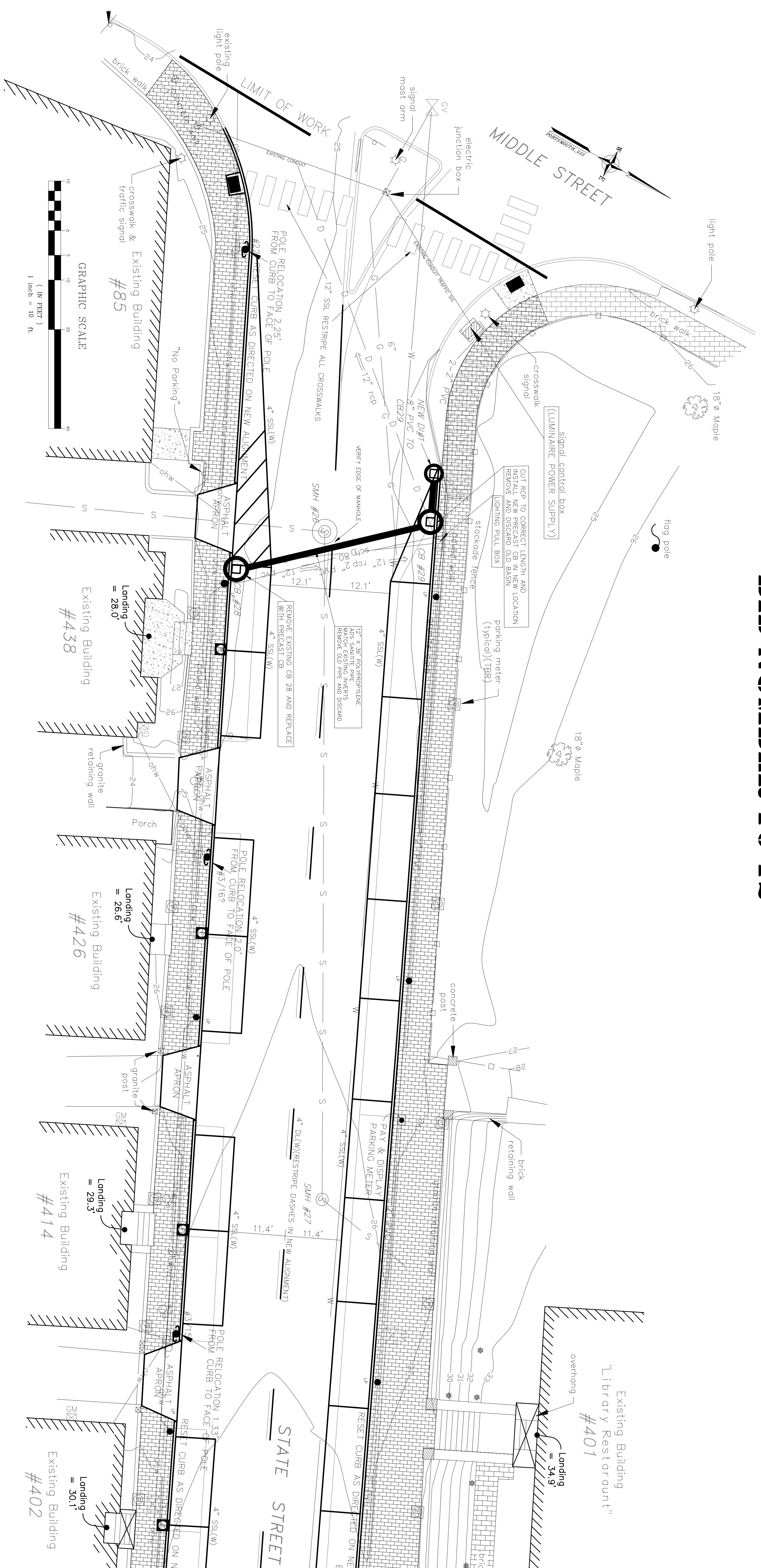

STATE STREET SIDEWALK REPLACEMENT LAYOUT PLAN
 DEPARTMENT OF PUBLIC WORKS
 CITY OF PORTSMOUTH
 NEW HAMPSHIRE

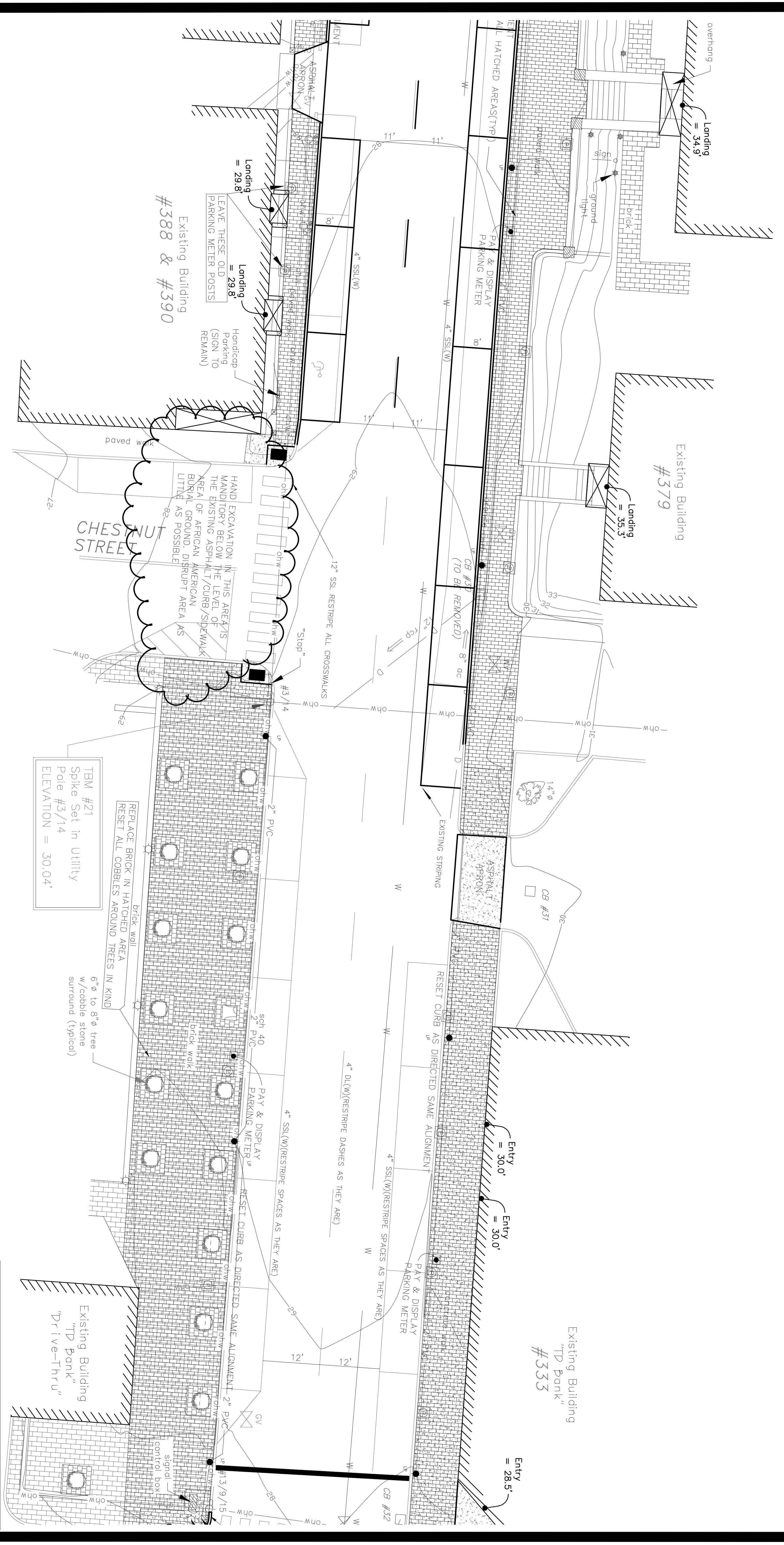

CHESNUT STREET

TBM #21
Spike Set in Utility
Pole #3/14
ELEVATION = 30.04'

STATE STREET SIDEWALK
REPLACEMENT
DETAIL PLAN

DEPARTMENT OF
PUBLIC WORKS
CITY OF PORTSMOUTH
NEW HAMPSHIRE

- LEGEND**
- EXISTING CATCH BASIN
 - BOLLARDS
 - UTILITY POLE
 - HYDRANT
 - GATE VALVE
 - NEW LIGHT POLE
 - CATCH BASIN
 - $R=15'$ PROPOSED RADIUS
 - EP EDGE OF PAVEMENT
 - -13 EXISTING CONTOUR
 - $+15.3$ EXISTING SPOT GRADE
 - NEW SIDEWALK AREAS
 - NEW PULL BOX

- NOTES:**
1. UTILITIES (IF SHOWN) ARE APPROXIMATE, CALL 1-800-DIG-SAFE PRIOR TO ANY EXCAVATION.
 2. ALL MATERIALS PROPOSED ON THIS PLAN ARE TO MEET NHDOT, NEC & CITY STANDARD SPECIFICATIONS.
 3. TOPOGRAPHY IS BASED NGVD 83.
 4. PARKING SPACES WILL BE AVAILABLE FOR PUBLIC USE AT NIGHT IT IS SAFE AND REASONABLE.
 5. ALL NEW SIDEWALKS MUST BE COMPLETE WITHIN 3 WEEKS OF OLD WALK REMOVAL.
 6. HOURS OF WORK WILL BE 7 AM TO 5 PM DAILY, WEEKEND WORK WILL NOT BE ALLOWED.
 7. THE STREET WILL NOT BE SHUT DOWN TO TRAFFIC.
 8. FLAGGERS WILL NEED TO BE HIRED FOR THE DURATION OF THE PROJECT WHENEVER CONSTRUCTION OR VEHICLES ARE IN THE ROAD.
 9. ALL BUSINESSES AND RESIDENCES MUST HAVE SAFE ACCESS AT ALL TIMES.
 10. CONTACT PSNH FOR OLD POLE REMOVAL.
 11. THE CITY OF PORTSMOUTH HAS BOUGHT THE LIGHTS FOR THE PROJECT AHEAD OF TIME. THE CONTRACTOR WILL BE RESPONSIBLE FOR MOVING THE LIGHTS TO THE SITE, CLEANING THE LIGHTS, INSTALLING THE LIGHTS, PAINT TOUCH UPS, WIRING THE LIGHTS, INSTALLING THE BASES, UPGRADING THE ELECTRICAL PANEL(S), PROVIDING THE CONTRACTOR(S) AND PHOTOCELL(S), AND ANY OTHER ASSOCIATED BUT UNLISTED TASK.
 12. ALL SIDEWALKS MUST BE SAFE FOR THE GENERAL PUBLIC AT ALL TIMES. BARRICADES, SIGNS ETC. WILL BE PROVIDED UNDER THE MAINTENANCE OF TRAFFIC ITEM IF NEEDED TO PROTECT THE PUBLIC. IT IS THE DECISION OF THE ENGINEER WHETHER THE CONTRACTOR HAS SUPPLIED THE PROPER SAFETY SUPPLIES. THE CONTRACTOR MAY BE REQUIRED TO PROVIDE TEMPORARY SIDEWALKS AND "BRIDGES" INTO BUSINESS OPENINGS AS NEEDED AND AS DETERMINED BY THE CITY.
 13. THE CONTRACTOR WILL SUPPLY THE CITY WITH A 24 HOUR PHONE NUMBER IN CASE OF EMERGENCY.
 14. CALCIUM OR OTHER DUST CONTROL MEASURES WILL BE PROVIDED IF DEEMED NECESSARY BY THE ENGINEER.
 15. COORDINATE WITH THE CITY FOR PARKING METER REMOVAL AND REPLACEMENT.
 16. DRAINAGE LINES THAT CROSS WITHIN 12" OF A SEWER OR WATER LINE SHALL BE INSULATED WITH POLYSTYRENE.

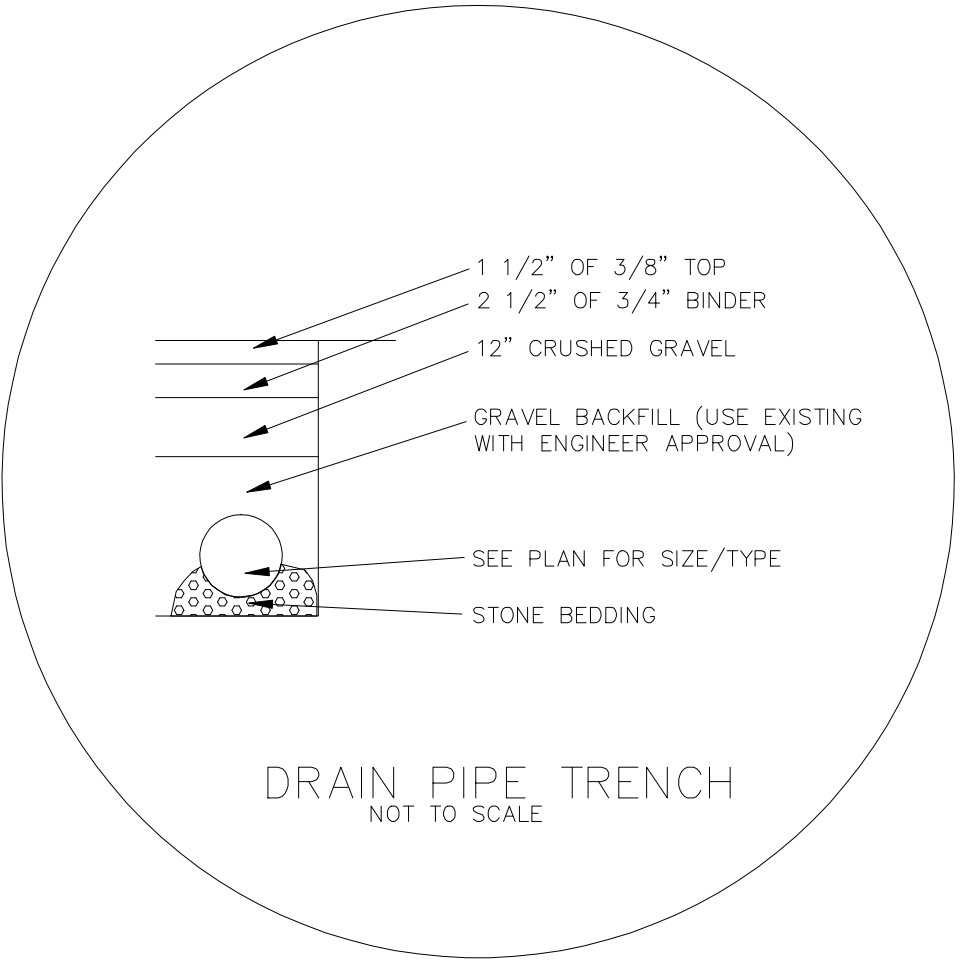
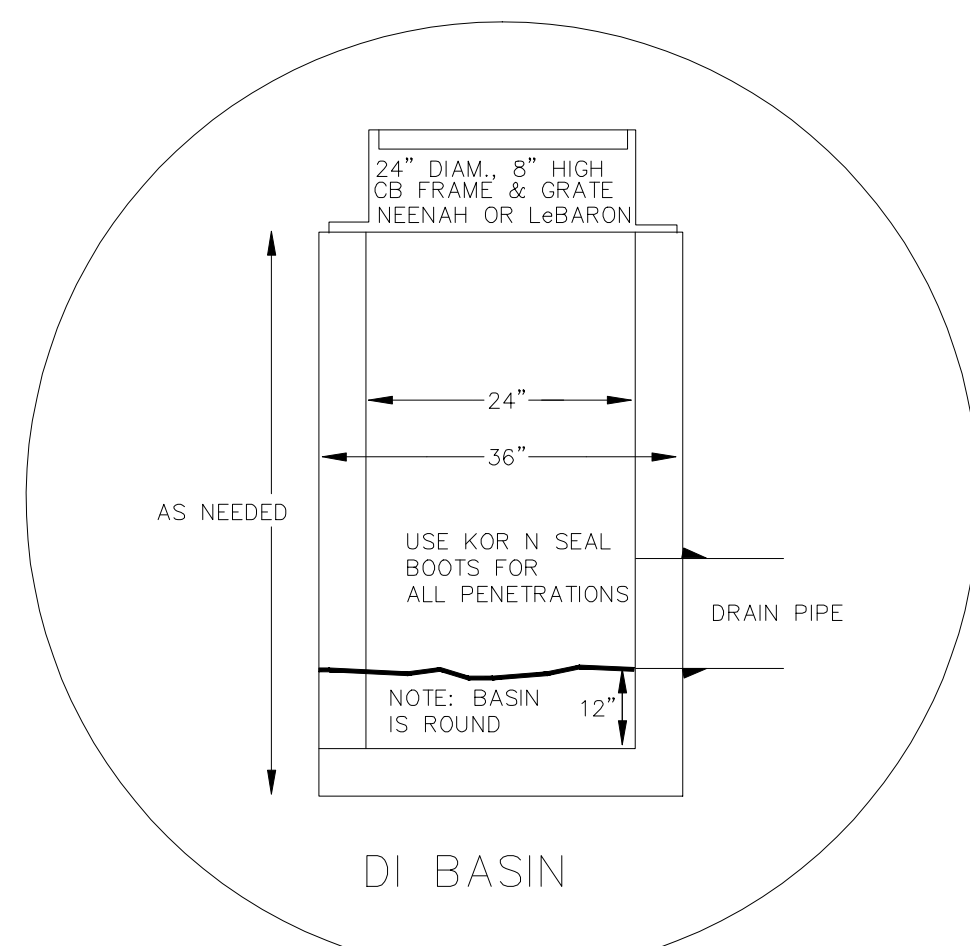
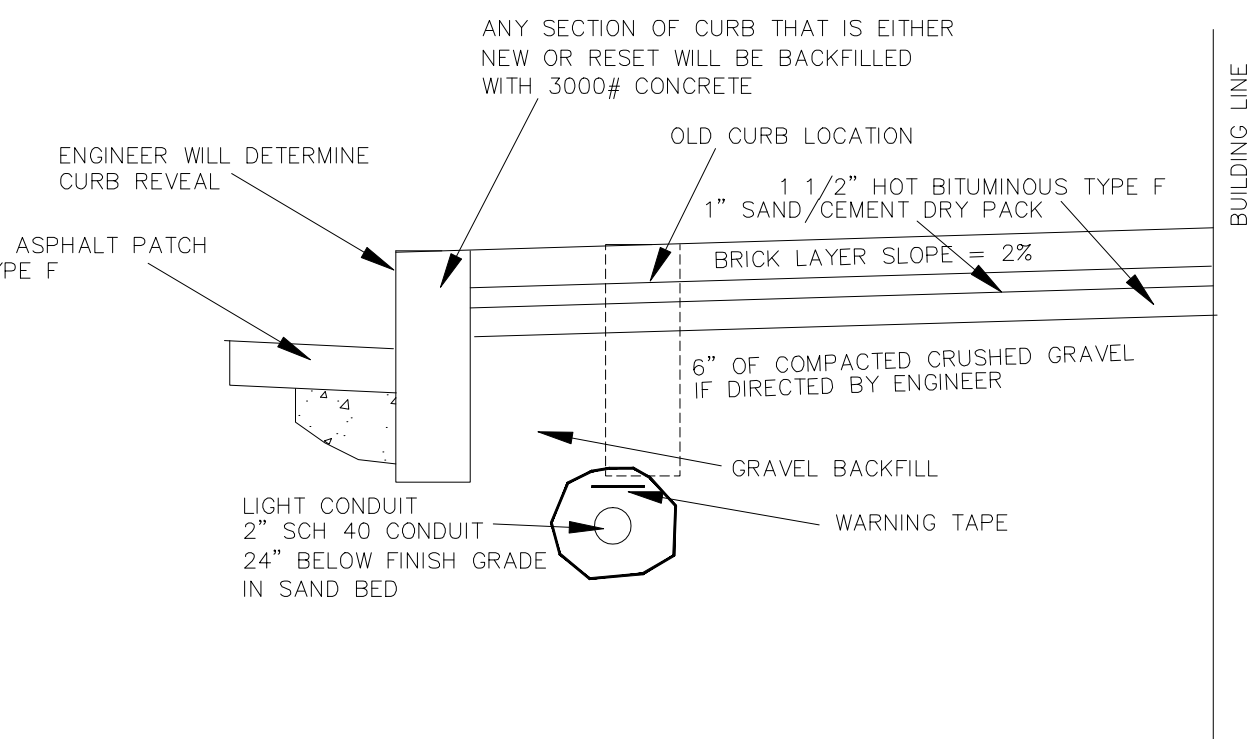
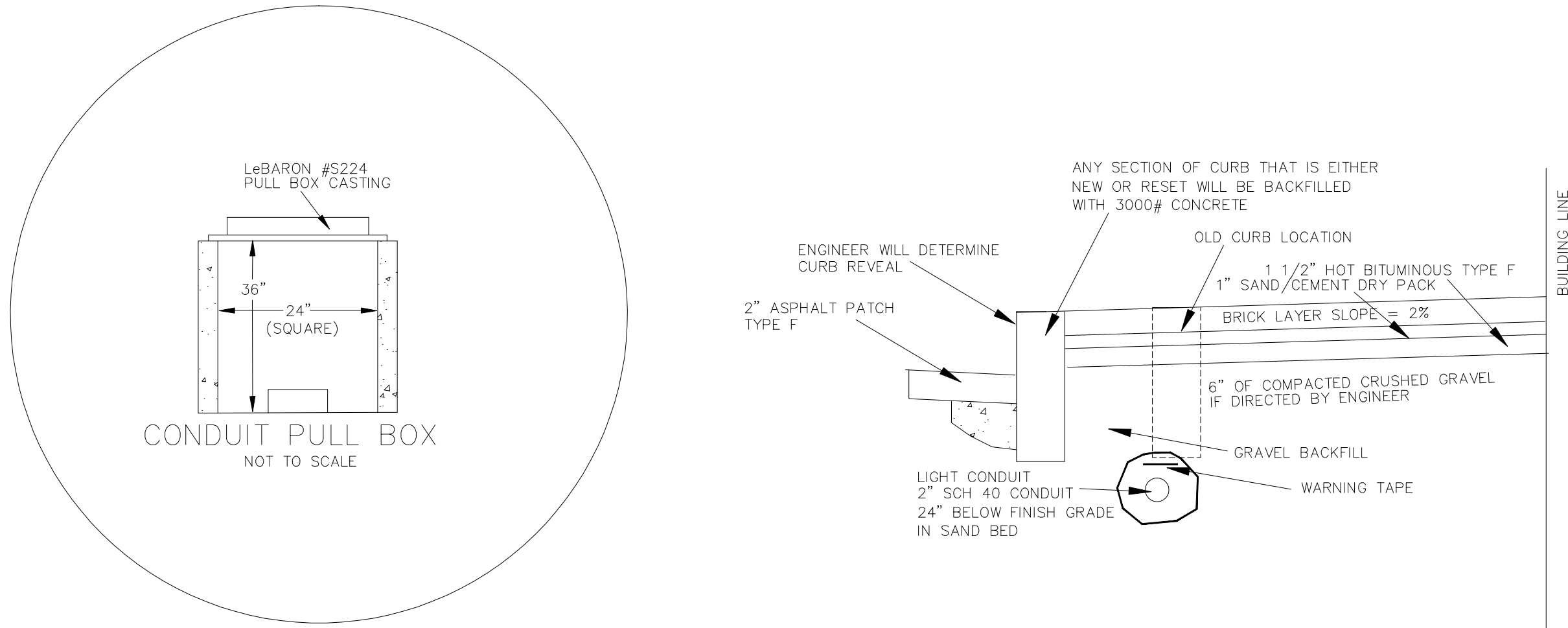
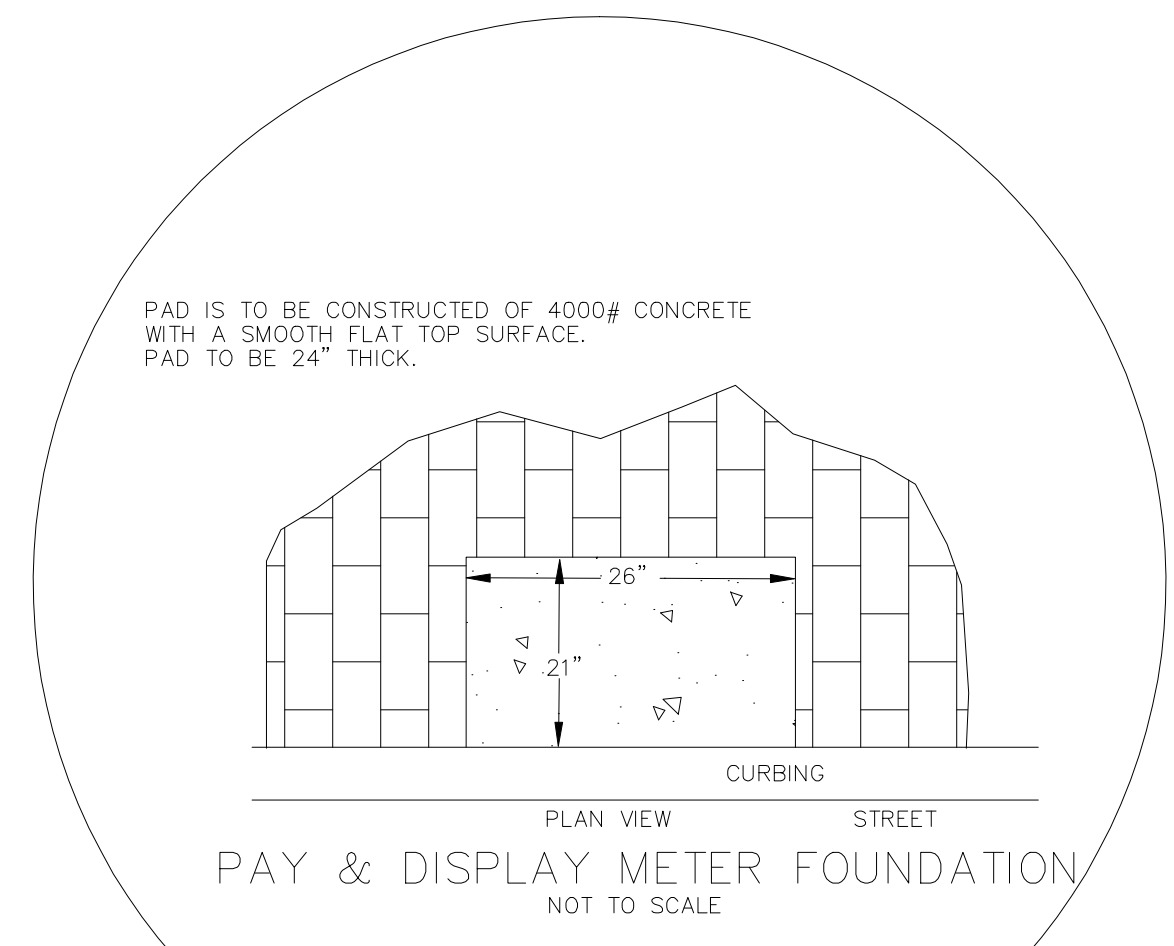
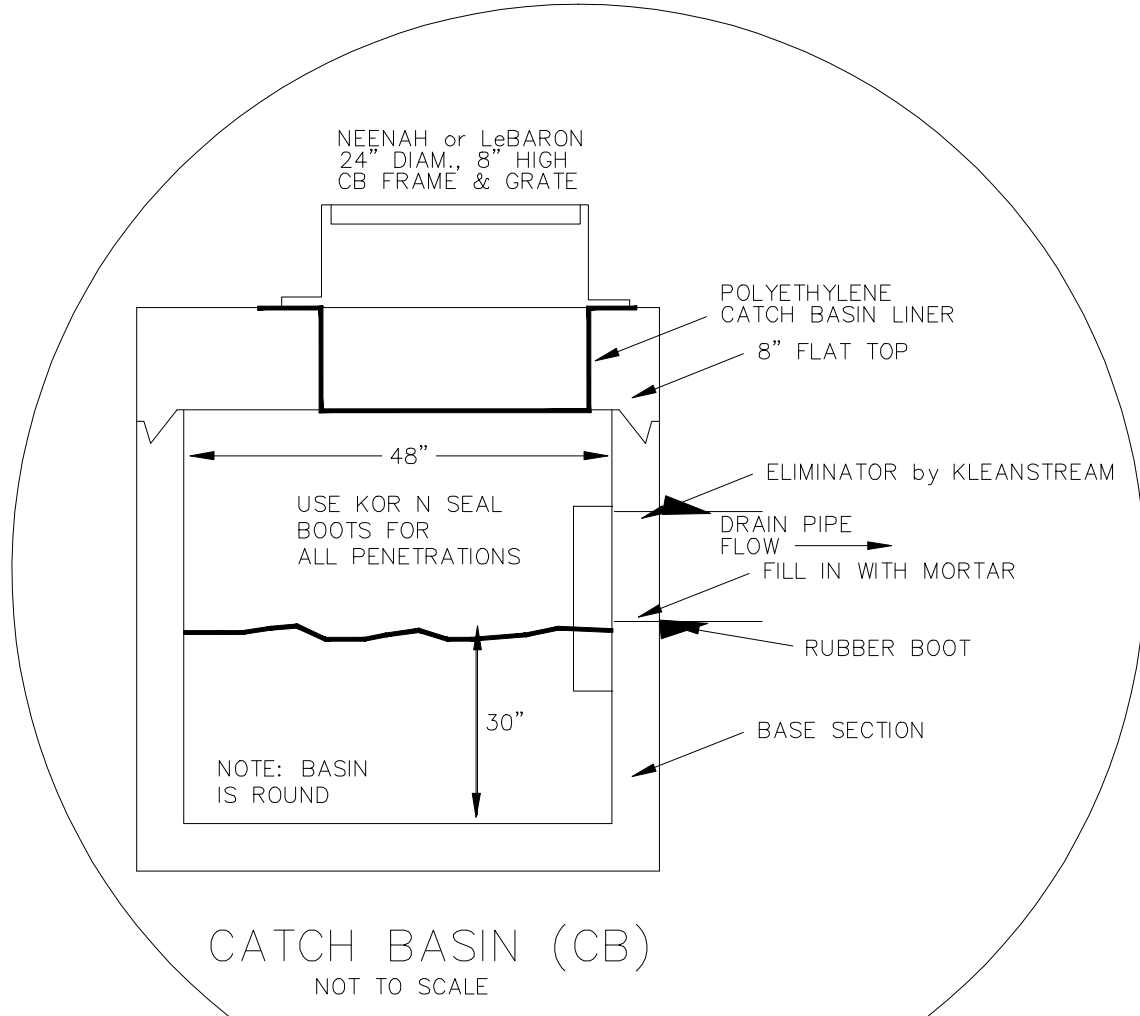

- NOTES:**
1. COORDINATES ARE BASED UPON THE CITY OF PORTSMOUTH CONTROL STATIONS "MEMO" & "MAPL" AND THE VERTICAL INFORMATION IS FROM SAID STATION "MEMO", ELEVATION 25.688' (NAD 83 DATUM).
 2. FIELD OBSERVATIONS WERE MADE BY A NORTH EASTERLY SURVEYING, INC. FIELD CREW. STATE STREET FROM MIDDLE STREET TO PLEASANT STREET WAS LOCATED IN DECEMBER 2010.
 3. ALL UNDERGROUND UTILITIES ARE APPROXIMATE BASED UPON FIELD OBSERVATIONS AND INFORMATION PROVIDED BY THE CITY OF PORTSMOUTH DEPARTMENT OF PUBLIC WORKS. NORTH EASTERLY PS SURVEYING, INC. MAKES NO CLAIM TO THE ACCURACY OF THESE UTILITIES. A CALL TO DIG SAFE MUST BE MADE PRIOR TO ANY EXCAVATION.
 4. THE APPROXIMATE EDGE OF RIGHT OF WAYS ARE BASED UPON RECORD PLANS AND HAVE NOT BEEN VERIFIED BY THIS FIRM.

DRAIN INVERT DATA:		DRAIN INVERT DATA:		SEWER INVERT DATA:	
CB #23	RM = 24.9'	CB #30	RM = 28.9'	SMH #26	RM = 25.3'
INV IN (NW) 12" sdr = 21.5'		INV IN (E) 8" oc = 26.8'		(No Invert Data Obtained)	
INV OUT (NE) 12" sdr = *		INV OUT (SE) 12" rcp = 26.1'		SMH #27	RM = 26.3'
*Unable to get an accurate invert				(No Invert Data Obtained)	
CB #24	RM = 24.9'	CB #31	RM = 29.8'	SMH #28	RM = 27.6'
INV IN (NW) 12" sdr = 21.5'		(No Invert Data Obtained)		(No Invert Data Obtained)	
INV IN (SE) 12" rcp = 22.0'		CB #32	RM = 27.5'	SMH #29	RM = 27.5'
INV OUT (NE) 12" rcp = 21.2'		INV OUT (SE) 12" rcp = 22.9'		(WITH TRAP)	
CB #25	RM = 24.8'	DMH #33	RM = 26.8'	(No Invert Data Obtained)	
INV OUT (NE) 12" rcp = 22.2'		(No Invert Data Obtained)		SMH #30	RM = 26.8'
		CB #34	RM = 26.3'	(No Invert Data Obtained)	
		INV IN (N) 12" pvc = 22.3'			
		CB #29	RM = 25.2'		
		INV IN (S) 12" rcp = 22.2'			
		INV OUT (SW) 12" rcp = 21.9'			

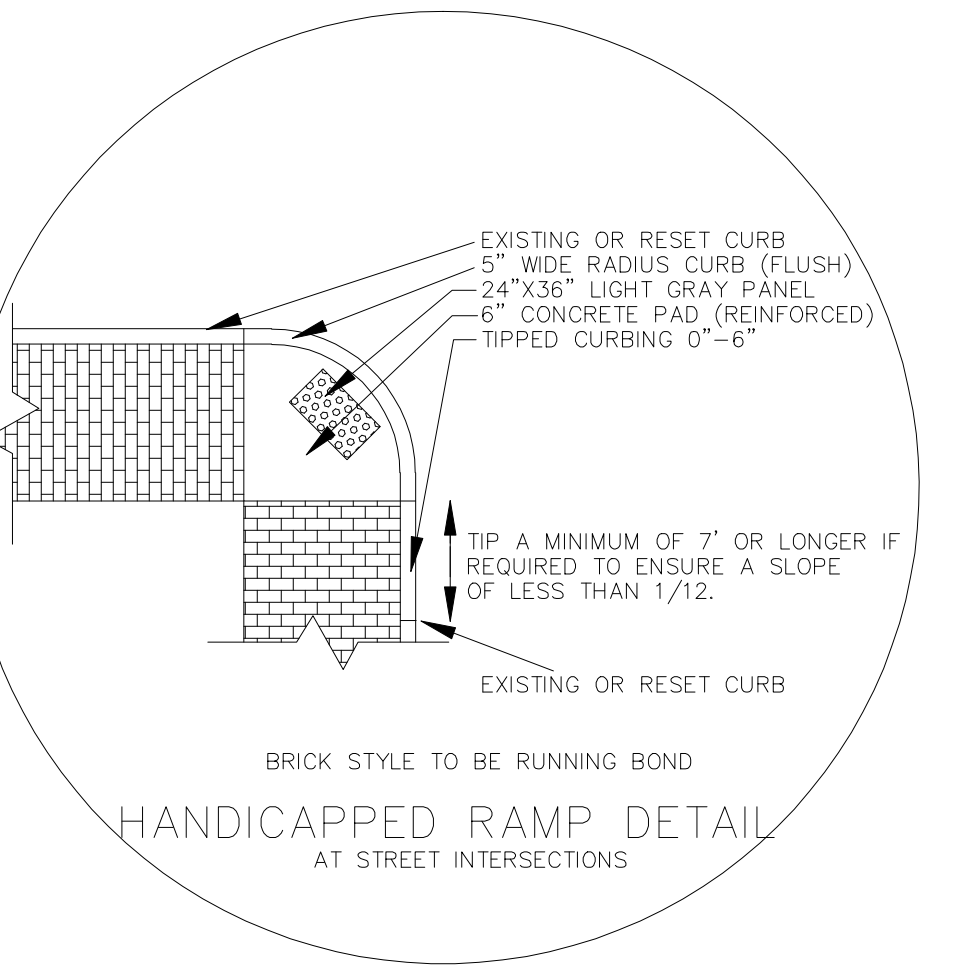
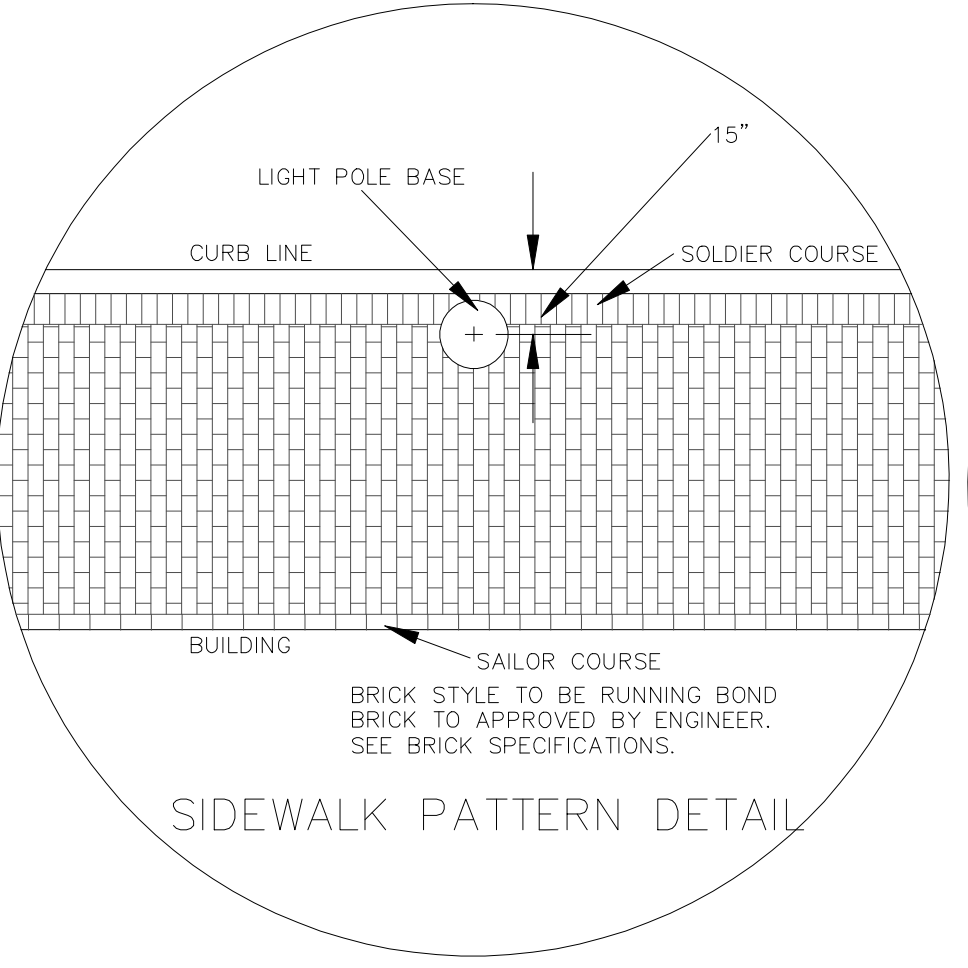
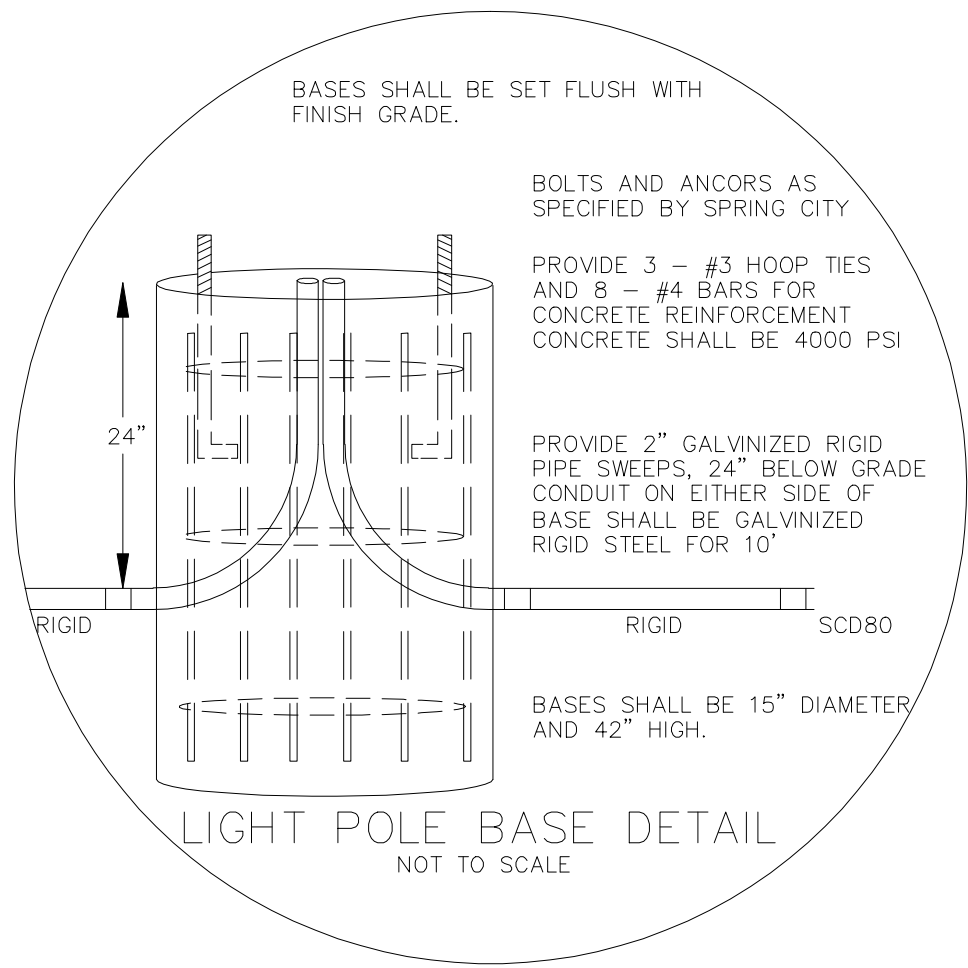
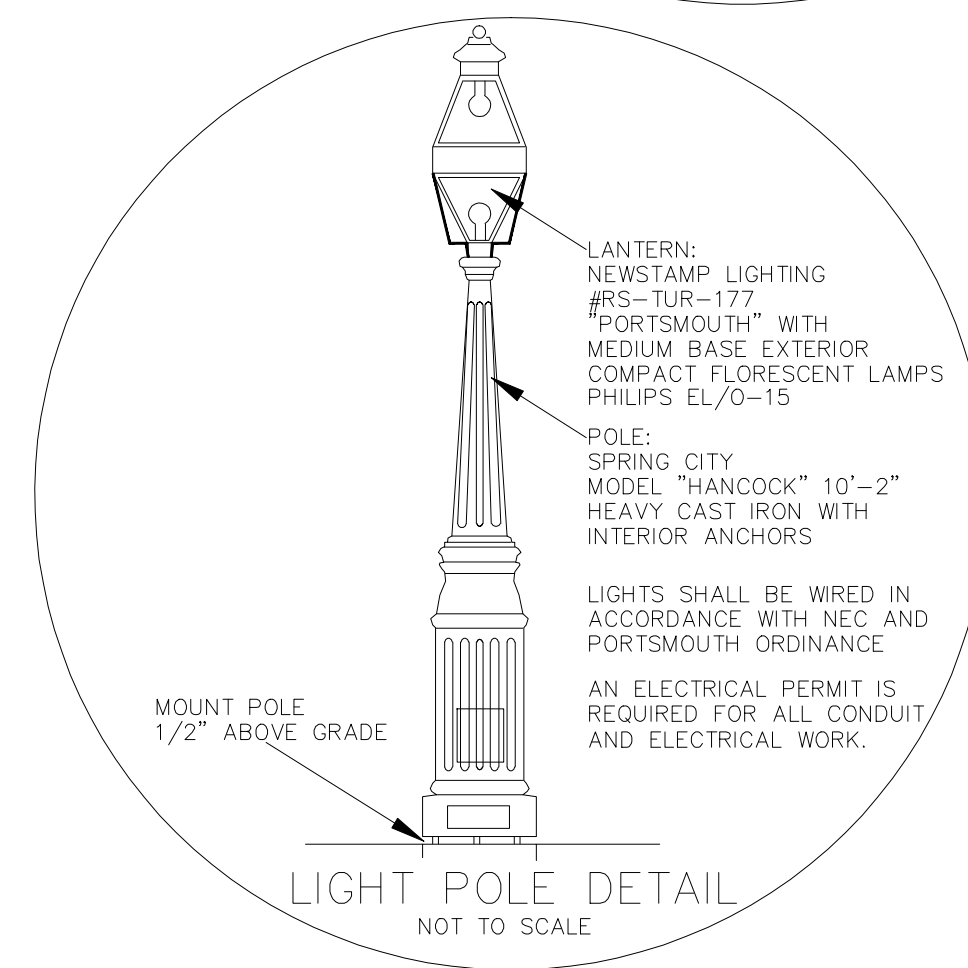

STATE STREET SIDEWALK
REPLACEMENT
DETAIL PLAN
DEPARTMENT OF
PUBLIC WORKS
CITY OF PORTSMOUTH
NEW HAMPSHIRE

