



City of Portsmouth Department of Public Works
680 Peverly Hill Road
Portsmouth, New Hampshire 03801

ADDENDUM NUMBER 1

Bid #33-17

Outer Islington Street Improvements

Issued January 25, 2017

The addendum forms part of the original document marked: Bid #33-17 Outer Islington Street Improvements. Acknowledge this addendum within your proposal. Failure to do so may subject bidder to disqualification.

The following questions have been asked and answered:

Question 1: Pay item 202.32 Removal of Existing Driveways and Aprons; Is this asphalt only, or does the pay item include excavation to subgrade or is any of this covered under 203.1 Common Excavation?

Answer: Both Pay Item 202.31 Removal of Sidewalks and 202.32 Removal of Existing Driveways and Aprons are for the surface material removal only, full depth of asphalt and/or concrete. Any excavation to sub-grade will be paid under the 203.1 Common Excavation pay item. Due to some driveway aprons being raised, the full excavation depth may not be 8" for sub-grade material. The engineer on-site will determine if existing sub-grade is suitable for re-use or if excavation to sub-grade is required.

Question 2: An existing gas main is shown on Sheets C-2D and C-2E, but are not shown on C-2A, C-2B, and C-2C. Where does the gas main end?

Answer: The gas main was inadvertently omitted from Sheet C-2C. The gas main continues to approximately sta. 14+10LT where it is capped. A revised Sheet C-2C dated 1/19/2017 is attached as part of this addendum and will supersede the previous plan.

Question 3: Does the City and/or private utilities have any restrictions on blasting in proximity to underground utilities?

Answer: The City will not allow ledge removal via blasting on this project due to the proximity to the cast iron water main.

Question 4: Sheet G-1 Grading Note #7 states all disturbed areas to receive 6" loam. Sheet C-4 and C-5 details show 4" loam. Please clarify

Answer: Note #7 on Sheet G-1 is incorrect. All areas receiving loam shall have a minimum of 4" depth.

Question 5: Sheet C-1A Note #6 states loam and seed in all disturbed areas as incidental to the sidewalk pay item. Please clarify what are incidental and what areas will be paid under Item #646.51 Turf Establishment.

Answer: On all C-1 sheets, the notes state only #2 through #5 are incidental to the sidewalk pay item. The intent of Note #6 is to identify to the Contractor that there may be areas not shown specifically on the drawings that are disturbed during the construction that will require loam, unless otherwise noted. All loam and seeding will be paid under item 646.51.

Question 6: Does the City have any area available for Contractors to use as laydown or staging area?

Answer: No, there are no available City owned staging areas. Contractors will be allowed to keep a day's worth of materials on the side of the road. All other materials must be trucked daily unless accommodations can be found with private land owners.

Question 7: Is there geotechnical or boring information available?

Answer: John Turner Consulting performed borings on the project. Below is a chart with the information provided. Locations correlating to the boring numbers are shown on the C-2 drawings.

Boring No.	Pavement thickness (in)	Gravel Thickness (in)	Overburden depth (ft)	Refusal Depth (ft)	Notes
1	4.5	18	12	-	OB-silty sand
2	5	18	-	5	OB-silty sand
3	5	18	-	8	OB-sand, gravel, cobbles
4	4	12	-	4	OB-sand, gravel, cobbles
5	-	-	-	-	Skipped due to water main per water dept rep
6	6	18	-	2	OB-silty gravel, cobbles
7	5	20	-	3	OB-silty gravel, cobbles
8	4	20	-	3	OB-silty gravel, cobbles

Question 8: There is a cut and cap of an existing water line shown on WBBX Road, which is outside the reclaim and paving area. Is all work associated with this considered incidental, including sawcut and trench patch?

Answer: Yes, All work for this item, including installation of mechanical cap, thrust block, and mud up opening of abandoned pipe, is covered under Pay Item 611.

Question 9: The plans indicate to remove an existing hydrant and gate valve, and cap the lateral near sta. 15+17RT. What pay item is this work associated with?

Answer: Pay Item 611.814 Removal of Hydrant has been added to the contract bid tab. This pay item will include all work necessary to remove the existing hydrant and valve riser sleeve. The valve itself does not need removal. This includes, but not limited to, excavation, hydrant & valve riser sleeve removal, mud up open end of abandoned pipe, backfill & compaction. A revised bid tab has been included in this addendum to be used in place of the original.

Question 10: Is there any permits, bonds or special conditions per the railroad company to install the restrictor plate on the existing headwall below the railroad tracks? If so, will the City be responsible for this? What type of access will be available to the Contractor to do this work.

Answer: Formal access is only available across the property of 1549 Islington Street. It is expected that installation of the restrictor plate will only require hand tools and not large equipment.

Question 11: Is there an engineer's estimate for the project?

Answer: Engineer's estimate is:

Base Bid - \$1,000,000

Alt-Option #1 - \$116,000

Alt-Option #2 - \$30,000

Question 12: Will the City allow water based paint?

Answer: Latex paints will be allowed as long as the surface temperature of the asphalt is at least 40 degrees Fahrenheit.

Question 13: Please clarify the intent of the Reclaim Stabilized Base. Is the intent to reclaim 8", add 1.5" stone if necessary and pave 5" and keeping the existing road profile, or is it to build per the specific elevations shown on the profile sheets? The amendment to Section 306, Reclaimed Stabilized Base, states that reclaim, remove and rehandle of reclaim to obtain specific grades are subsidiary.

Answer: The intent for Pay Items:

- Pay Item 306.108a is to reclaim the existing roadway to a depth of 8" and build the roadway to the specified elevations on the profile sheets. Rehandling the reclaim material in order to meet the proposed grades is subsidiary to the Pay Item. The proposed grades are slightly higher in most areas when compared to the existing elevations in order to accommodate the volume of base material, as well as provide an additional high point at sta.7+00. The proposed elevations on the profiles sheets include the thickness of the pavement. It is not the intent of this project to reconstruct the roadway base, with the exception of the widening sections.
- Pay item 306.108b is for the second reclaiming process when mixing the 1.5" crushed stone. This pay item will only be used if it is determined that adding crushed stone is required.
- Pay Item 306.208 shall only be paid when Reclaim material is rehandled and used as base materials identified in the drawings and the specification (widening, driveways and sidewalks).
- The engineer estimates the quantities for reclaim material will balance out project wide, and no export of excess reclaimed material is expected. In the event there is excess reclaimed material beyond what is used under Pay Item 306.208, the Contractor shall load and haul material to a City stockyard. If the City cannot accept the excess material, then the material will become the property of the Contractor, and shall be exported off-site. All of these options are considered subsidiary to the Pay Item 306.108a.

Question 14: Pay Item 646.51 Turf Establishment w/Mulch and Tackifier. NHDOT associates 646.51 as Turf Establishment w/Mulch, Tackifier and Loam. Is it intended that loam is included with the project Pay Item 646.51?

Answer: Yes, loam is included in Pay Item 646.51. The Bid Tab attached has been updated to specify Loam.

Question 15: Does the City anticipate the drainage installation to occur while the adjacent water main is active without the use of temporary water? There are many locations where the proposed drain line is drawn 2' from the water main (center of pipe to center of pipe) and this leaves no room for typical trench shoring. The drain manholes at a 5' OD also appears to conflict with the existing water main.

Answer: As stated on Sheet G-1, Survey Notes, #4 – Locations of underground utilities shown are approximate. The drain line running from sta. 4+50LT to sta. 12+10LT is intended to run parallel to the water main approximately with 3' separation. The drain line was placed in this location as it is anticipated that ledge removal will be reduced due to the proximity to the water line as well as this side of the street has been built-up. The City anticipates that the installation of the drain line will occur with the water main active.

Question 16: Drawings reference SDR 11 (1.5 and 2.0 inch) on C-2 drawings. On the bid sheet for Alternative #1, Pay Item 660.3A and 660.3B specify SDR21. Please clarify which is to be used.

Answer: The design is for SDR11. The Bid Tab attached has been updated to specify SDR11.

Question 17: The elevation tables shown on C-2C and C-2D appear to indicate ledge at a higher elevation/depth than the proposed depth for the low pressure sewer, some of the proposed SMH, CB and DMHs, and in some cases storm drain lines. The bid sheet has items 206.19 Common Structure Excavation- Exploratory (in hours) 206.2 – Rock Structure Excavation (in CY), both on the base bid and on alternative #1 (400 CY total). Is this intended to cover all ledge removal, for setting structures and for running the low pressure sewer and drain lines?

Answer: Pay Item 206.19 is intended to be used for Exploratory Excavation (i.e. test pits), this is not a pay item for ledge removal. Pay Item 206.2 under the Base Bid is for ledge removal for the Base Bid pay items only. The engineer has estimated 300CY of ledge removal for installation of drainage. Pay Item 206.2 under the Alternative #1 is the engineer's estimate of ledge removal necessary to install the low-pressure sewer.

End of Addendum #1.

PROPOSAL FORM

Outer Islington Street Improvements

CITY OF PORTSMOUTH, N.H.

To the City of Portsmouth, New Hampshire, herein called the Owner.

The undersigned, as Bidder, herein referred to as singular and masculine declares as follows:

1. All interested in the Bid as Principals are named herein.
2. This bid is not made jointly, or in conjunction, cooperation or collusion with any other person, firm, corporation, or other legal entity;
3. No officer, agent or employee of the Owner is directly or indirectly interested in this Bid.
4. The bidder has carefully examined the sites of the proposed work and fully informed and satisfied himself as to the conditions there existing, the character and requirements of the proposed work, the difficulties attendant upon its execution and the accuracy of all estimated quantities stated in this Bid, and the bidder has carefully read and examined the Drawings, Agreement, Specifications and other Contract Documents therein referred to and knows and understands the terms and provisions thereof;
5. The bidder understands that the quantities of work calculated in the Bid or indicated on the Drawings or in the Specifications or other Contract Documents are approximate and are subject to increase or decrease or deletion as deemed necessary by the Director of Public Works. Any such changes will not result in or be justification for any penalty or increase in contract prices; and agrees that, if the Bid is accepted the bidder will contract with the Owner, as provided in the Contract Documents, this Bid Form being part of said Contract Documents, and that the bidder will supply or perform all labor, services, plant, machinery, apparatus, appliances, tools, supplies and all other activities required by the Contract Documents in the manner and within the time therein set forth, and that the bidder will take in full payment therefore the following item prices, to wit:

ITEM #	EST. QTY	UNITS	ITEM DESCRIPTION AND UNIT PRICE IN WORDS	UNIT PRICE IN FIGURES	ITEM TOTAL IN FIGURES
201.1	1	LS	Clearing and Grubbing	\$ _____	\$ _____
201.2	1	EA	Removal of Tree & Stump	\$ _____	\$ _____
202.31	120	SY	Removal of Existing Sidewalk	\$ _____	\$ _____

ITEM #	EST. QTY	UNITS	ITEM DESCRIPTION AND UNIT PRICE IN WORDS	UNIT PRICE IN FIGURES	ITEM TOTAL IN FIGURES
202.32	1400	SY	Removal of Existing Driveways and Aprons	\$ _____	\$ _____
202.7	475	LF	Removal of Guardrail	\$ _____	\$ _____
202.8	10	CY	Removal of Masonry Steps as Directed	\$ _____	\$ _____
203.1	750	CY	Common Excavation	\$ _____	\$ _____
203.6	250	CY	Embankment in Place	\$ _____	\$ _____
206.19	20	HR	Common Structure Excavation - Exploratory	\$ _____	\$ _____
206.2	300	CY	Rock Structure Excavation	\$ _____	\$ _____
209.1	200	CY	Granular Backfill	\$ _____	\$ _____
214	8600	SY	Fine Grade	\$ _____	\$ _____
304.2	100	CY	Gravel in Place (Roadway Base)	\$ _____	\$ _____
304.3	50	CY	Crushed Gravel in Place (Roadway Base)	\$ _____	\$ _____

ITEM #	EST. QTY	UNITS	ITEM DESCRIPTION AND UNIT PRICE IN WORDS	UNIT PRICE IN FIGURES	ITEM TOTAL IN FIGURES
304.3	550	CY	Crushed Gravel in Place (Sidewalk & Driveway Base)	\$ _____	\$ _____
306.108a	7500	SY	8" Reclaimed Stabilized Base	\$ _____	\$ _____
306.108b	7500	SY	8" Reclaimed Stabilized Base (Blend in 1.5" Crushed Stone)	\$ _____	\$ _____
306.208	50	CY	Reclaim Stabilized Base (Rehandle for Base Material)	\$ _____	\$ _____
306.36	450	TN	1.5" Crushed Stone (Mixed with Reclaimer)	\$ _____	\$ _____
403.11A	1880	TN	Machine Method, Binder	\$ _____	\$ _____
403.11B	925	TN	Machine Method, Wearing	\$ _____	\$ _____
403.12	220	TN	Hand Method	\$ _____	\$ _____
417	2600	SY	Cold Plane Bituminous Surface (1.5")	\$ _____	\$ _____
520	170	CY	Class B Curb Backfill	\$ _____	\$ _____
585.3	100	CY	Stone Fill, Class C in Place	\$ _____	\$ _____

ITEM #	EST. QTY	UNITS	ITEM DESCRIPTION AND UNIT PRICE IN WORDS	UNIT PRICE IN FIGURES	ITEM TOTAL IN FIGURES
592.12	150	SF	Segmented Block Retaining Wall	\$ _____	\$ _____
603.3012	10	LF	18" Dia. RCP	\$ _____	\$ _____
603.8221	1000	LF	12" Dia. HDPE Drain Pipe	\$ _____	\$ _____
604.0007	9	EA	Poly Liner for CB	\$ _____	\$ _____
604.1	7	EA	Eliminator Oil/Water Separator	\$ _____	\$ _____
604.12	9	EA	New Catch Basin	\$ _____	\$ _____
604.324	9	EA	New Drain Manhole	\$ _____	\$ _____
604.54	4	EA	Adjust Existing Structures (Tele. MH)	\$ _____	\$ _____
604.62	9	EA	Provide and Install DMH Frame & Cover	\$ _____	\$ _____
604.72	9	EA	Provide and Install CB Frame & Grate	\$ _____	\$ _____

ITEM #	EST. QTY	UNITS	ITEM DESCRIPTION AND UNIT PRICE IN WORDS	UNIT PRICE IN FIGURES	ITEM TOTAL IN FIGURES
604.8	1	EA	Alter Existing Stone Culvert with Aluminum Restrictor Plate	\$ _____	\$ _____
605.512	550	LF	12" Corrugated Perforated HDPE Underdrain	\$ _____	\$ _____
606.12	620	LF	Beam Guardrail Standard Section (Steel Post)	\$ _____	\$ _____
606.1255	4	EA	Beam Guardrail Terminal Unit E-2	\$ _____	\$ _____
608.24	1250	SY	4" Concrete Sidewalk	\$ _____	\$ _____
608.26	50	SY	6" Concrete Sidewalk (for ADA Ramp areas)	\$ _____	\$ _____
608.52	12	EA	ADA Detectable Warning Tile, Cast Iron	\$ _____	\$ _____
609.1	3700	LF	New Straight Vertical Granite Curb, 5"	\$ _____	\$ _____
609.2	210	LF	New Curved Vertical Granite Curb, 5"	\$ _____	\$ _____
611	1	LS	Cut and Cap Existing Water Main	\$ _____	\$ _____

ITEM #	EST. QTY	UNITS	ITEM DESCRIPTION AND UNIT PRICE IN WORDS	UNIT PRICE IN FIGURES	ITEM TOTAL IN FIGURES
611.5001	2	EA	1" Copper Corporation and Curb Stop	\$ _____	\$ _____
611.5011	60	LF	1" Copper Water Service	\$ _____	\$ _____
611.8	1	EA	New Hydrant Assembly Complete (Incl. tapping saddle & valve & 6" lateral pipe)	\$ _____	\$ _____
611.814	1	LS	Remove Hydrant (Incl. valve sleeve)	\$ _____	\$ _____
611.9	25	EA	Adjust Existing Gate Valves	\$ _____	\$ _____
615	4	EA	Relocate Traffic Signs	\$ _____	\$ _____
618.6	2720	HR	Uniformed Flaggers Twenty dollars and fifty cents	<u>\$20.50</u>	<u>\$55,760.00</u>
618.7	100	HR	Portsmouth Police Officers Sixty dollars	<u>\$60.00</u>	<u>\$6,000.00</u>
619.1	1	U	Maintenance of Traffic	\$ _____	\$ _____
619.11	1000	LB	Calcium Chloride for Dust Control	\$ _____	\$ _____

ITEM #	EST. QTY	UNITS	ITEM DESCRIPTION AND UNIT PRICE IN WORDS	UNIT PRICE IN FIGURES	ITEM TOTAL IN FIGURES
619.253	4	WK	Portable Message Boards	\$ _____	\$ _____
628.2	1000	LF	Sawcut Bituminous Pavement	\$ _____	\$ _____
632.0104A	10500	LF	4" Paint Striping (Chlorinated Rubber Paint)	\$ _____	\$ _____
632.3112	425	LF	12" Thermoplastic Crosswalk & Stop Bars	\$ _____	\$ _____
645	4	EA	Catch Basin Silt Sack	\$ _____	\$ _____
645.631	3400	LF	Silt Fence or Silt Log	\$ _____	\$ _____
645.7	1	LS	SWPPP	\$ _____	\$ _____
645.71	85	HR	SWPPP Inspections	\$ _____	\$ _____
646.51	3500	SY	Turf Establishment w/ Mulch, Tackifier and Loam	\$ _____	\$ _____
692	1	U	Mobilization	\$ _____	\$ _____
1010.2	1	U	Asphalt Cement Adjustment	\$ _____	\$ _____

TOTAL FOR PROJECT BASE BID

In Figures \$ _____

In Words \$ _____

PROPOSAL FORM FOR ADDITIONAL/ALTERNATIVE #1 BID
CONSTRUCTION ITEMS

It is mandatory to fill out this section as well.

ITEM #	EST. QTY	UNITS	ITEM DESCRIPTION AND UNIT PRICE IN WORDS	UNIT PRICE IN FIGURES	ITEM TOTAL IN FIGURES
206.2	100	CY	Rock Structure Excavation	\$ _____	\$ _____
<hr/>					
618.6	160	HR	Uniformed Flaggers	<u>\$20.50</u>	<u>\$3,280.00</u>
			Twenty dollars and fifty cents		
<hr/>					
645.71	5	HR	SWPPP Inspections	\$ _____	\$ _____
<hr/>					
660.1A	1	EA	New 4' Dia. Sewer Manhole	\$ _____	\$ _____
<hr/>					
660.1B	1	EA	New 6' Dia. Sewer Manhole	\$ _____	\$ _____
<hr/>					
660.2	\$1,700.00	\$	Allowance to purchase manhole frame and grates from City.	\$ _____	\$ _____
<hr/>					
660.3	120	LF	8" Dia. SDR 35 Sewer Pipe	\$ _____	\$ _____
<hr/>					

ITEM #	EST. QTY	UNITS	ITEM DESCRIPTION AND UNIT PRICE IN WORDS	UNIT PRICE IN FIGURES	ITEM TOTAL IN FIGURES
660.3A	200	LF	1.5" Dia. SDR 11 Forced Sewer Pipe	\$ _____	\$ _____
660.3B	1600	LF	2.0" Dia. SDR 11 Forced Sewer Pipe	\$ _____	\$ _____
660.4A	24	EA	Service Lateral Assembly	\$ _____	\$ _____
660.4B	1	EA	Terminal Cleanout Assembly	\$ _____	\$ _____
660.5	1	EA	Core Existing SMH	\$ _____	\$ _____
660.6	1	EA	Construct Invert & Drop into Existing SMH	\$ _____	\$ _____

The contractor will be provided an extra 10 working days if this add-alt is selected for approval.

TOTAL FOR PROJECT ADDITIONAL/ALTERNATIVE BID #1

In Figures \$ _____

In Words \$ _____

PROPOSAL FORM FOR ADDITIONAL/ALTERNATIVE #2 BID
CONSTRUCTION ITEMS

It is mandatory to fill out this section as well.

ITEM #	EST. QTY	UNITS	ITEM DESCRIPTION AND UNIT PRICE IN WORDS	UNIT PRICE IN FIGURES	ITEM TOTAL IN FIGURES
202.31	220	SY	Removal of Existing Sidewalk	\$ _____	\$ _____
202.32	100	SY	Removal of Existing Driveways and Aprons	\$ _____	\$ _____
203.1	75	CY	Common Excavation	\$ _____	\$ _____
214	100	SY	Fine Grade (Driveways)	\$ _____	\$ _____
304.3	75	CY	Crushed Gravel in Place (Sidewalk & Driveway Base)	\$ _____	\$ _____
403.12	10	TN	Hand Method Paving	\$ _____	\$ _____
520	5	CY	Class B Curb Backfill	\$ _____	\$ _____
608.24	220	SY	4" Concrete Sidewalk	\$ _____	\$ _____
609.1	10	LF	New Straight Vertical Granite Curb, 5"	\$ _____	\$ _____
609.5	375	LF	Reset Existing Curb	\$ _____	\$ _____
618.6	100	HR	Uniformed Flaggers Twenty dollars and fifty cents	<u>\$20.50</u>	<u>\$2,050.00</u>

ITEM #	EST. QTY	UNITS	ITEM DESCRIPTION AND UNIT PRICE IN WORDS	UNIT PRICE IN FIGURES	ITEM TOTAL IN FIGURES
628.2	525	LF	Sawcut Bituminous Pavement	\$ _____	\$ _____
632.0104A	460	LF	4" Paint Striping (Chlorinated Rubber Paint)	\$ _____	\$ _____
645	2	EA	Catch Basin Silt Sack	\$ _____	\$ _____
646.51	225	SY	Turf Establishment w/ Mulch, Tackifier and Loam	\$ _____	\$ _____

The contractor will be provided an extra 5 working days if this add-alt is selected for approval.

TOTAL FOR PROJECT ADDITIONAL/ALTERNATIVE BID #2

In Figures \$ _____

In Words \$ _____

To Bidder:

The City reserves the right, after bid opening and prior to award of the contract, to modify the amount of the work in the event that bids exceed budgeted amounts and/or easements and agreements from one or more impacted property owners are not received.

It is the intention of this contract that the items listed above describe completely and thoroughly the entirety of the work as shown on the plans and as described in the specifications. All other items required to accomplish the above items are considered to be subsidiary work, unless shown as a pay item.

TOTAL FOR PROJECT (BASE BID + ADD ALTERNATIVE BID #1 + ADD ALTERNATIVE BID #2) AND BASIS OF AWARD

In Figures \$ _____

In Words \$ _____

The undersigned agrees that for extra work, if any, performed in accordance with the terms and provisions of the Contract Documents, the bidder will accept compensation as stipulated therein.

Date:

Company

By: _____
Signature

Business Address

Title: _____

City, State, Zip Code

Telephone: _____

We certify that the Company is currently pre-qualified with the State of New Hampshire for Road Construction.

By: _____
Signature & Title

Date

The Bidder has received and acknowledged Addenda No. _____ through _____.

All Bids are to be submitted on this form and in a sealed envelope, plainly marked on the outside with the Bidder's name and address and the Project name as it appears at the top of the Proposal Form.

In order to follow the City's sustainability practices, future bid invitations/specifications may be sent electronically. Please provide an email address as to where I could email future bid invitations/specifications of this type. Thank you in advance for your cooperation.

Email
Address: _____

NH STATE PLANE COORDINATE SYSTEM
NAD 1983

NOTES:
1. REMOVAL OF 18" RCP AND ALL SPECIAL CONNECTIONS NEEDED TO RECONSTRUCT CULVERT TO PDMH4 ARE CONSIDERED INCIDENTAL TO THE PDMH INSTALLATION.

EXISTING 18" RCP TO BE REMOVED TO EXTENT NECESSARY TO INSTALL PDMH4 (SEE NOTE)

CONSTRUCT 6" FIRE LATERAL (6" DI PIPE, 12x6 TAPPING SADDLE, VALVE & THRUST BLOCKS)

INSTALL HYDRANT (SEE DETAIL)

INSULATE BETWEEN DRAIN AND FORCED SEWER MAIN

CUT AND CAP EXISTING 6" WATER MAIN 10' FROM VALVE (ABANDON PIPE)

PROPOSED 12" TYPE 'C' HDPE 48LF, S=0.005

PROPOSED 12" HDPE 58LF, S=0.005

PROPOSED 12" HDPE 42LF, S=0.013

PROPOSED 12" HDPE 200LF, S=0.017

SEWER LATERAL ASSEMBLY (TYP)

PROPOSED 12" HDPE 218LF, S=0.018

INSTALL 1" DOMESTIC WATER SERVICE LINE AND CURB STOP TO 12" WATER MAIN

REMOVE EXISTING HYDRANT AND VALVE (CAP LATERAL)

INSTALL 1" DOMESTIC WATER SERVICE LINE AND CURB STOP TO 12" WATER MAIN

PDMH7
RIM=55.25
INV IN=51.05
INV OUT=50.95

PDMH6
RIM=51.82
INV IN(PDMH6)=47.65
INV IN(PCB6)=47.68
INV OUT(PDMH4)=47.55

PCB6
RIM=51.78
INV OUT=47.72

PDMH4
RIM=51.00
INV IN(PDMH3)=45.47
INV IN(18"RCP)=42.64
INV IN(PCB5)=46.26
INV OUT=42.52

PCB5
RIM=50.73
INV IN=46.60
INV OUT=46.50

PDMH5
RIM=51.16
INV IN=47.00
INV OUT=46.90

25LF 1.5" SDR11HDPE LOW PRESSURE MAIN w/VALVE (FUTURE USE)

PROPOSED 12" HDPE 8LF, S=0.005

1575LF 2.0" SDR11HDPE LOW PRESSURE SEWER MAIN

EXISTING WATER MAIN (APPROX)

DEPTH OF LEDGE (APPROX)

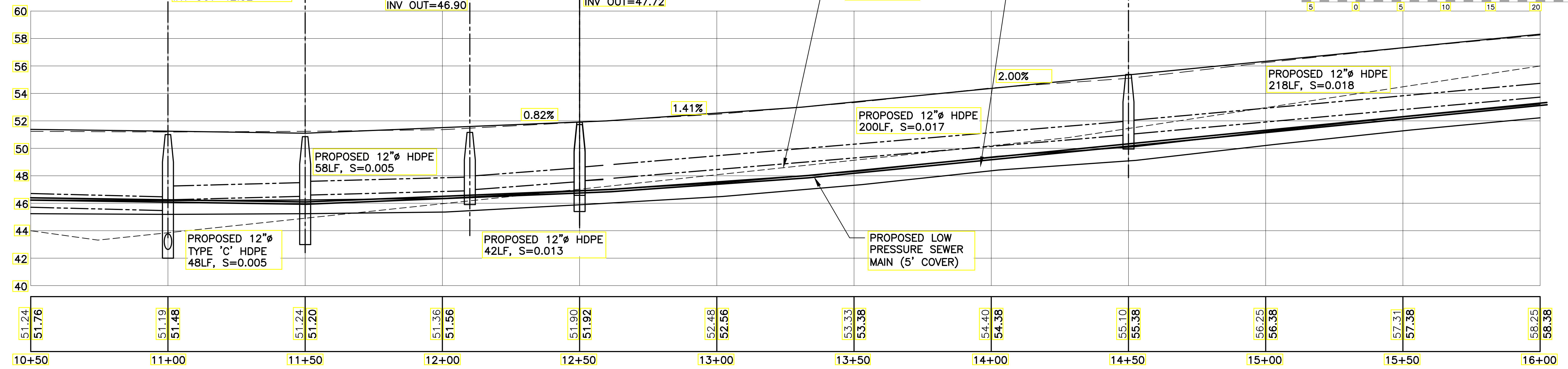
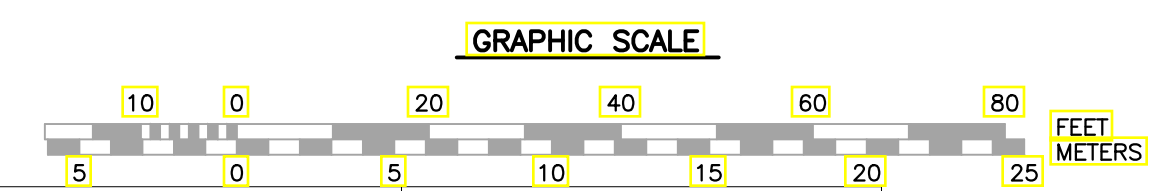

DATE: FEBRUARY 2, 2016		PROJECT NO.: Cop-002	
SCALE: 1:20		MARC R. BATCHELDER, PE ENGINEER OF RECORD	
FOR: Outer Islington St Sidewalk Design Portsmouth, NH 03801		Seaport Engineering, LLC PORTSMOUTH, NH (603) 498-8449 www.seaporteng.com	
TITLE: UTILITIES PLAN and PROFILE		C-2C	

NO.	DESCRIPTION	APP'D	DATE
B	APPENDIX #1	MRB	01/19/17
A	ISSUED FOR BID	MRB	01/09/17