

Landscape Improvement Plan

ROCK STREET PARK

Portsmouth, New Hampshire

Project Directory:

OWNER

City of Portsmouth
1 Junkins Avenue
P.O. Box 628
Portsmouth, New Hampshire 03802

Nancy Carmer, City Community Development Director
603-431-2006 ext. 220









LANDSCAPE ARCHITECT, OWNER'S REPRESENTATIVE

Richardson & Associates
Pepperell Square
P.O. Box 426
Saco, Maine 04072

Todd Richardson, Principal and Project Manager
207-286-9291

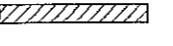
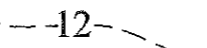
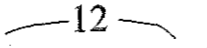
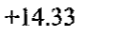
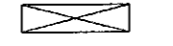
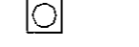
GENERAL NOTES:

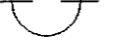
1. All topographic and existing base information has been provided by The City of Portsmouth and should be considered approximate. Base information is taken from three sources: 1) Map entitled "Topographic Map, City of Portsmouth, Rockingham County, New Hampshire Sheet No. 68B"; 2) Survey conducted by the City of Portsmouth engineers in February, 1998; 3) Informal field measurements taken by Richardson & Associates
2. Limit of work shall be at property line unless otherwise noted.
3. All written dimensions shall prevail; do not scale from drawings.
4. Distances shown on site plans are horizontal dimensions.
5. Layout staking to be approved by landscape architect.
6. Contractor shall verify all dimensions and grades on the ground and field verify location of existing plants and utilities as necessary. Any discrepancies shall be reported immediately to the landscape architect.
7. See construction details for dimensions of site elements.
8. All dimensions 90 degrees unless otherwise noted.
9. All disturbed areas not covered by pavement or structures shall receive a minimum of 6" of loam and seeded as specified.
10. All areas not requiring grading shall be left undisturbed. Contractor shall keep out of these areas and preserve existing plantings.
11. Prior to excavation, appropriate utility companies shall be contacted and Dig-Safe Center shall be called at 1-800-225-4977, at least 72 hours (3 working days) in advance.

| LEGEND | |
|---|------------------------------|
|  | Existing Plant to Remain |
|  | Existing Plant to be Removed |
|  | Proposed Plant |
|  | Transplanted from On-Site |
|  | Dry Well |
|  | -12- Existing Contours |
|  | -12- Proposed Contours |
|  | +14.33 Proposed Spot Grades |
|  | Bench |
|  | Trash Receptacle |
|  | Wall Light |
|  | -E- Electrical Conduit |
|  | Utility Pole |
|  | Granite Bollard |
|  | X Existing Fence |

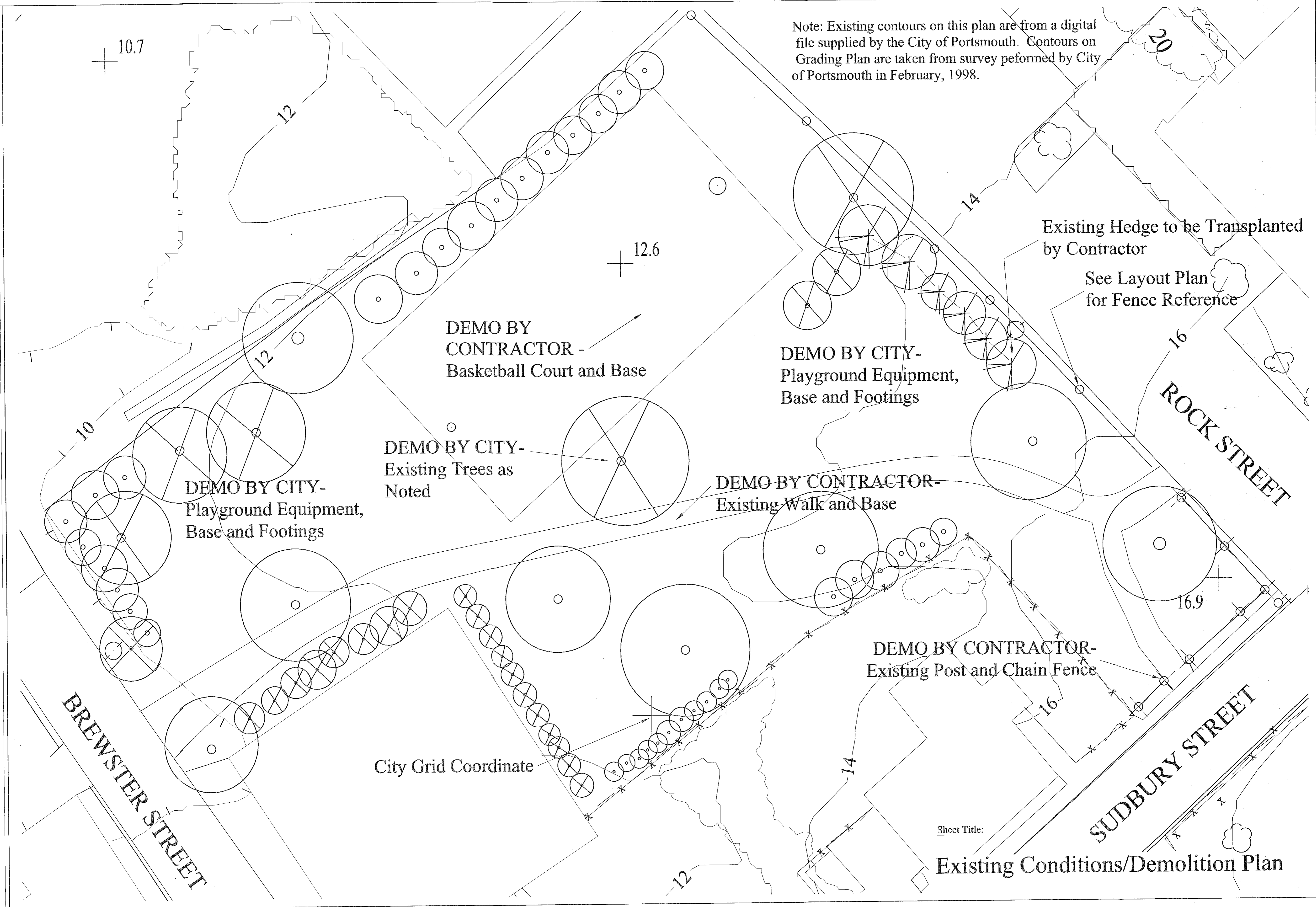

Note: Existing contours on this plan are from a digital file supplied by the City of Portsmouth. Contours on Grading Plan are taken from survey performed by City of Portsmouth in February, 1998.

Existing Hedge to be Transplanted by Contractor
See Layout Plan for Fence Reference

DEMO BY CONTRACTOR - Basketball Court and Base

DEMO BY CITY - Playground Equipment, Base and Footings

DEMO BY CITY - Existing Trees as Noted

DEMO BY CONTRACTOR - Existing Walk and Base

DEMO BY CITY - Playground Equipment, Base and Footings

DEMO BY CONTRACTOR - Existing Post and Chain Fence

City Grid Coordinate

Sheet Title:

Existing Conditions/Demolition Plan

Richardson & Associates
Landscape Architects
P.O. Box 426
Saco, Maine 04072
(207) 286-9291

ROCK STREET PARK

Portsmouth, New Hampshire

Scale: 1"=10'

Date: 4/22/98
Revisions: 6/15/98
6/29/98

Sheet Number:

1 of 6

ROCK STREET PARK

Portsmouth, New Hampshire

Scale: 1"=10'

Date: 4/22/98
Revisions: 6/15/98
6/29/98

Sheet Number:

2 of 6

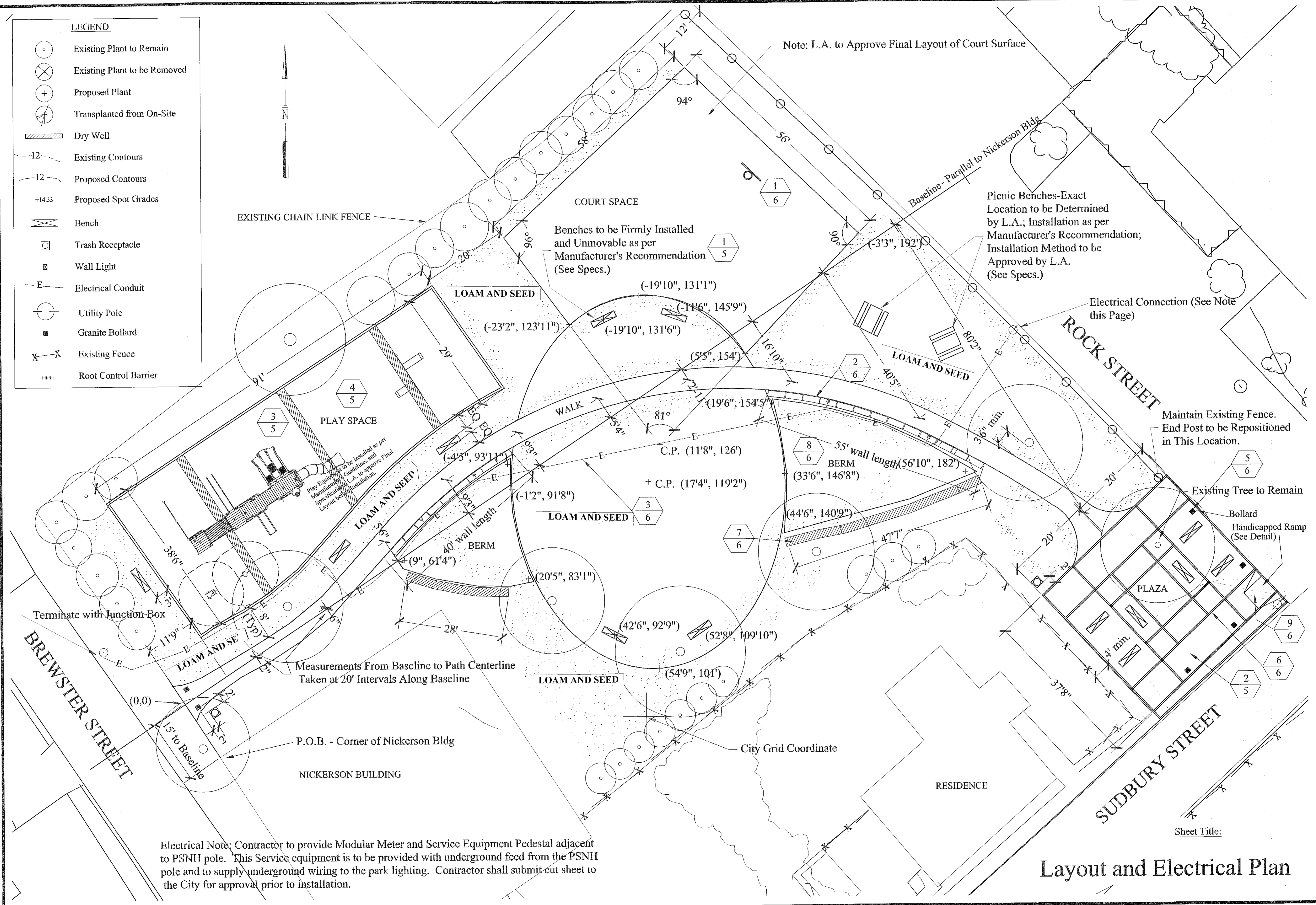

LEGEND

- Existing Plant to Remain
- Existing Plant to be Removed
- Proposed Plant
- Transplanted from On-Site
- Dry Well
- Existing Contours
- Proposed Contours
- Proposed Spot Grades
- Bench
- Trash Receptacle
- Wall Light
- Electrical Conduit
- Utility Pole
- Granite Bollard
- Existing Fence
- Root Control Barrier

Electrical Note: Contractor to provide Modular Meter and Service Equipment Pedestal adjacent to PSNH pole. This Service equipment is to be provided with underground feed from the PSNH pole and to supply underground wiring to the park lighting. Contractor shall submit cut sheet to the City for approval prior to installation.

Layout and Electrical Plan

Sheet Title:

ROCK STREET PARK

Portsmouth, New Hampshire

Scale: 1"=10'

Date: 4/22/98
Revisions: 6/15/98
6/29/98

Sheet Number:

3 of 6

Grading Plan Notes

1. Contractor to notify Landscape Architect if min. grade is less than 1.8% in any direction.
1. Contractor should ensure a min. 2% pitch to ensure positive drainage for walk, entry plaza and hard court. All areas not meeting this requirement should be brought to the attention of the L.A.

LEGEND

- Existing Plant to Remain
- Existing Plant to be Removed
- Proposed Plant
- Transplanted from On-Site
- Dry Well
- Existing Contours
- Proposed Contours
- Proposed Spot Grades
- Bench
- Trash Receptacle
- Wall Light
- Electrical Conduit
- Utility Pole
- Granite Bollard
- Existing Fence
- Root Control Barrier

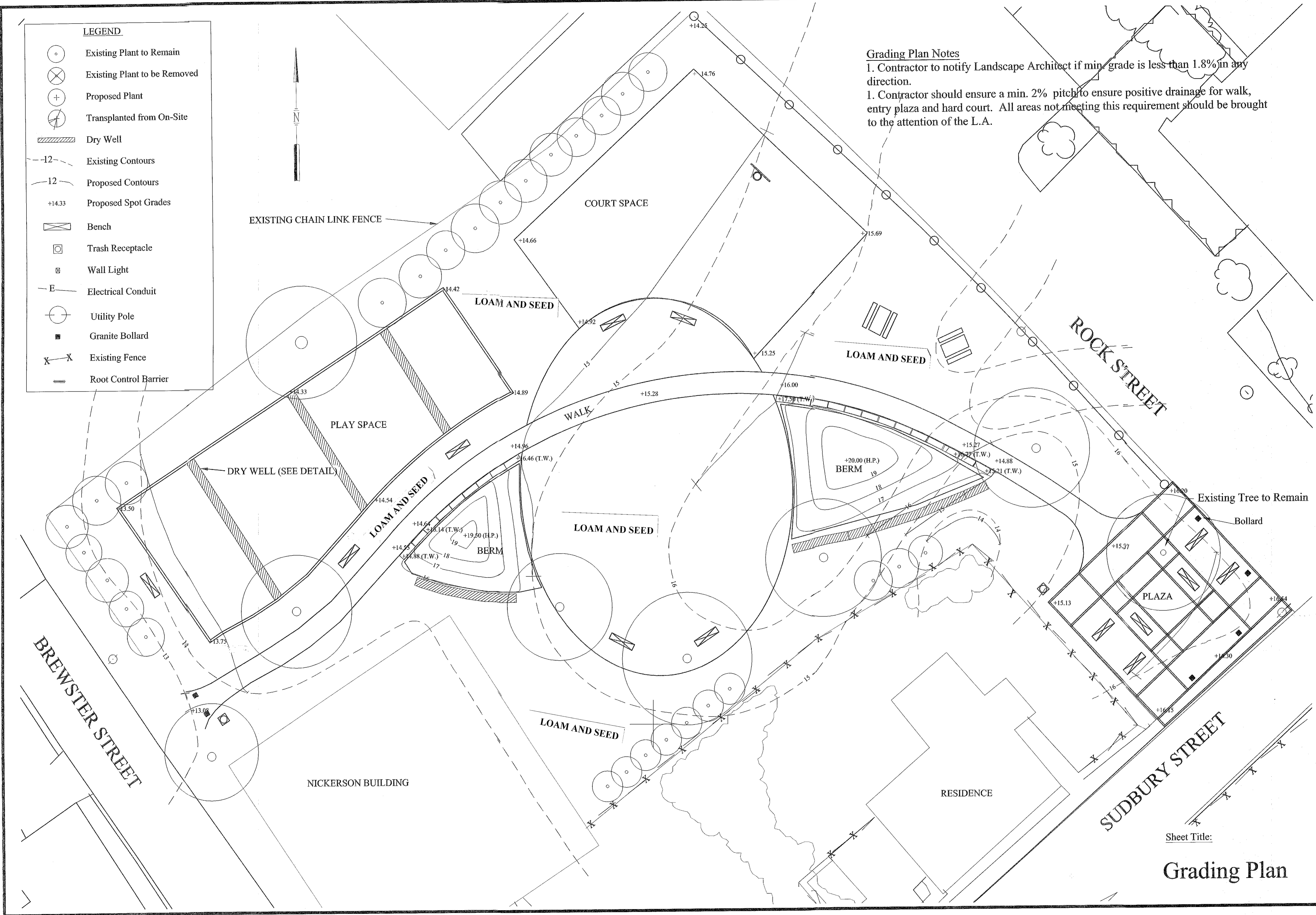

Sheet Title:

Grading Plan

LEGEND

- Existing Plant to Remain
- Existing Plant to be Removed
- Proposed Plant
- Transplanted from On-Site
- Dry Well
- Existing Contours
- Proposed Contours
- Proposed Spot Grades
- Bench
- Trash Receptacle
- Wall Light
- Electrical Conduit
- Utility Pole
- Granite Bollard
- Existing Fence
- Root Control Barrier

PLANT LIST

| Sym. | No. | Botanical Name | Common Name | Size |
|------|-----|-------------------------------------|--------------------------|-------------|
| AR | 7 | Acer rubrum | Red Maple | 2 1/2" cal. |
| CA | 16 | Clethra alnifolia 'Compacta' | Compact Sweet Pepperbush | 2-3' |
| IG | 81 | Ilex glabra 'Compacta' | Inkberry | 2-2 1/2' |
| ItV | 23 | Itea virginica | Sweetspire | 18-24" |
| IV | 7 | Ilex verticillata 'Red Sprite' | Winterberry | 2-3' |
| IV | 1 | Ilex verticillata 'Jim Dandy' | Winterberry | #2 |
| MB | 9 | Malus baccata | Siberian Crabapple | 2 1/2" cal. |
| QP | 3 | Quercus palustris | Pin Oak | 2 1/2" cal. |
| TOT | 13 | Thuja occidentalis 'Techny' | Mission Arborvitae | 6-7' |
| TP | 6 | Thuja plicata - on site transplants | | |

Richardson & Associates
Landscape Architects
P.O. Box 426
Saco, Maine 04072
(207) 286-9291

ROCK STREET PARK
Portsmouth, New Hampshire

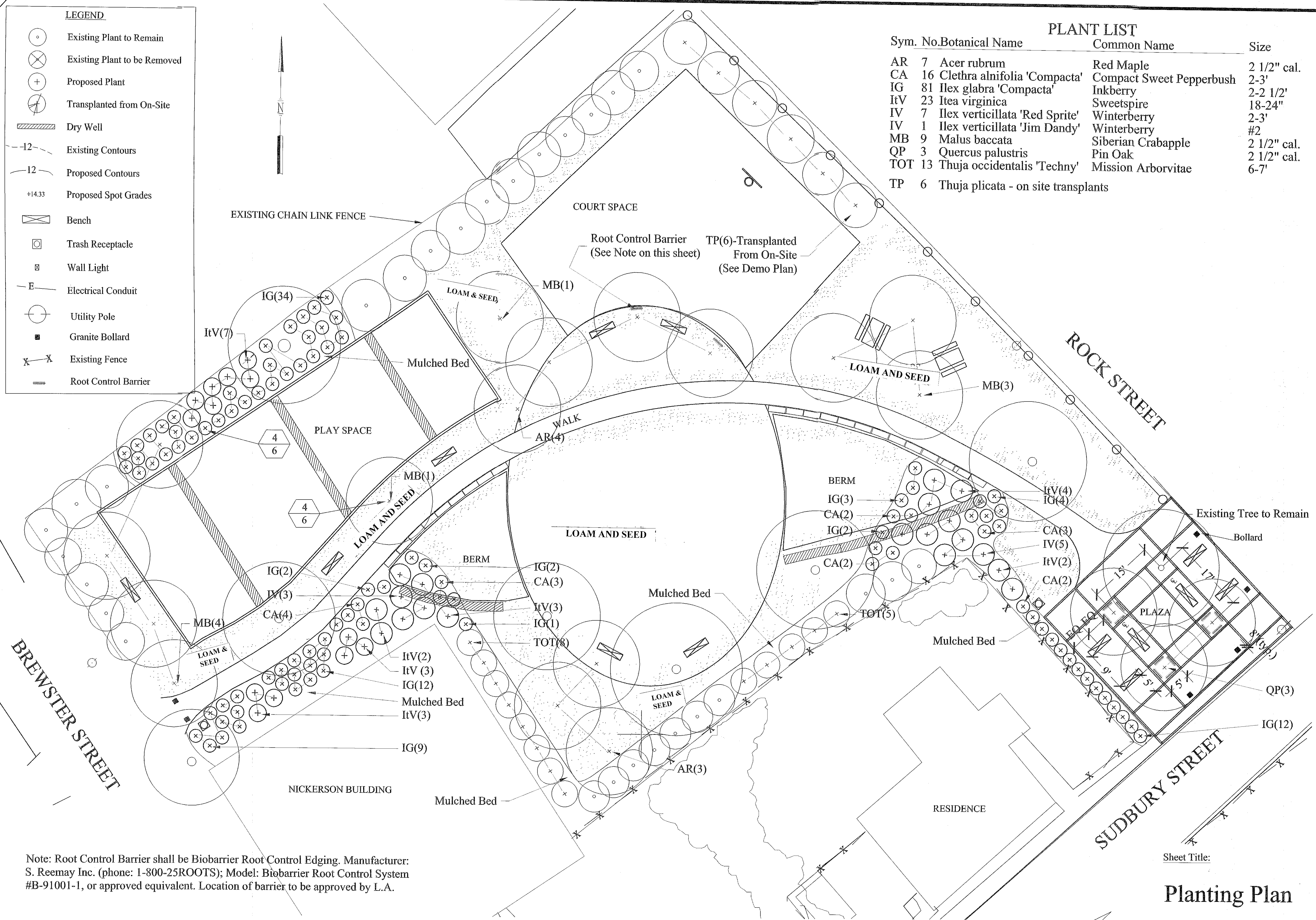

Note: Root Control Barrier shall be Biobarrier Root Control Edging. Manufacturer: S. Reemay Inc. (phone: 1-800-25ROOTS); Model: Biobarrier Root Control System #B-91001-1, or approved equivalent. Location of barrier to be approved by L.A.

Sheet Title:

Planting Plan

Scale: 1"=10'
Date: 4/22/98
Revisions: 6/15/98
6/29/98

Sheet Number:
4 of 6

Note: Paint Product Information to be Submitted to L.A. for Approval

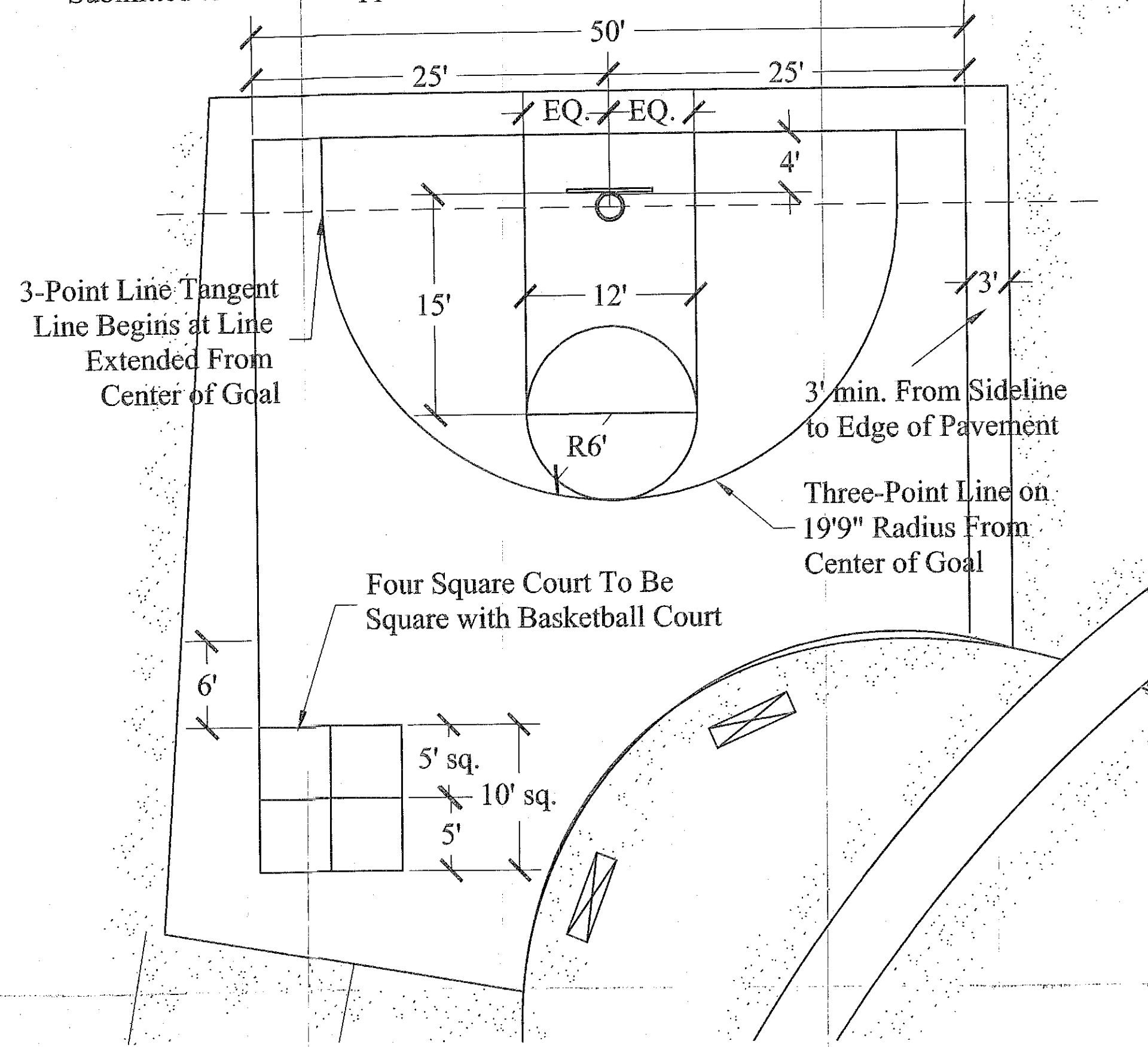

1 COURT PAINTING DETAIL
Scale: 1/8" = 1' - 0"

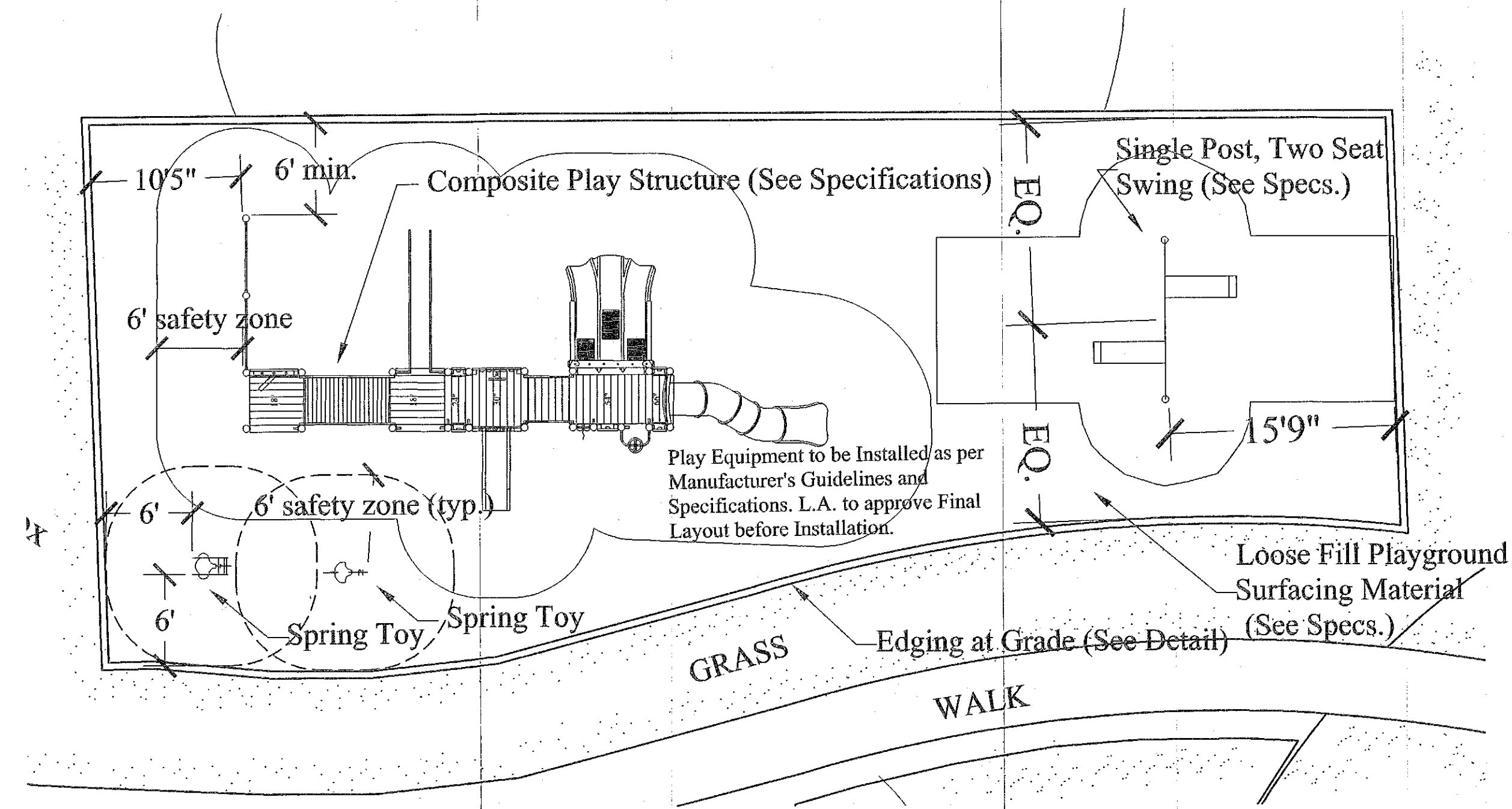

3 PLAYGROUND AREA DETAIL
Scale: 1/8" = 1' - 0"

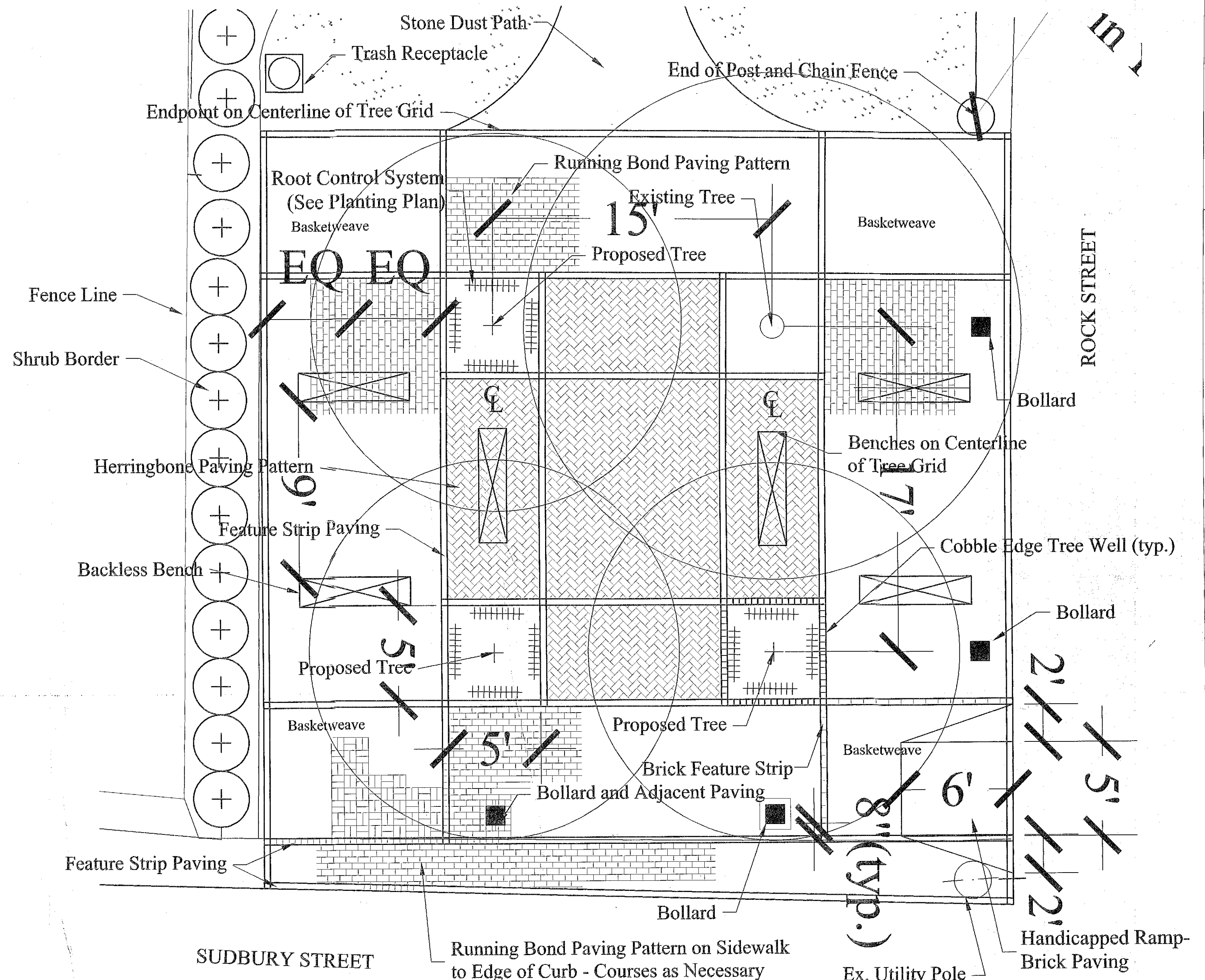

2 ENTRY PLAZA PAVING DETAIL
Scale: 1/4" = 1' - 0"

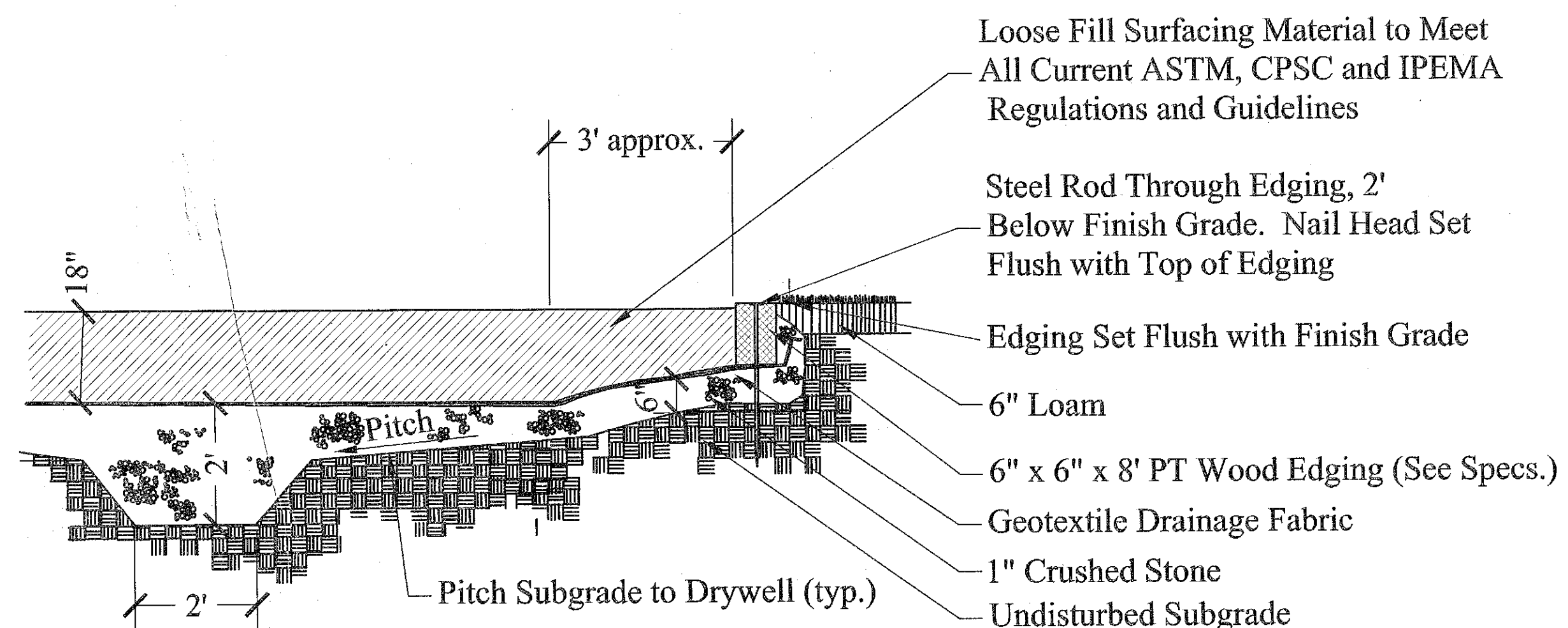

4 SECTION THROUGH PLAYGROUND SURFACING & DRY WELL
Scale: 1/2" = 1' - 0"

Sheet Title:

Detail Sheet A

Scale: As Noted

Date: 4/22/98
Revisions: 6/15/98
6/29/98

Sheet Number:

5 of 6

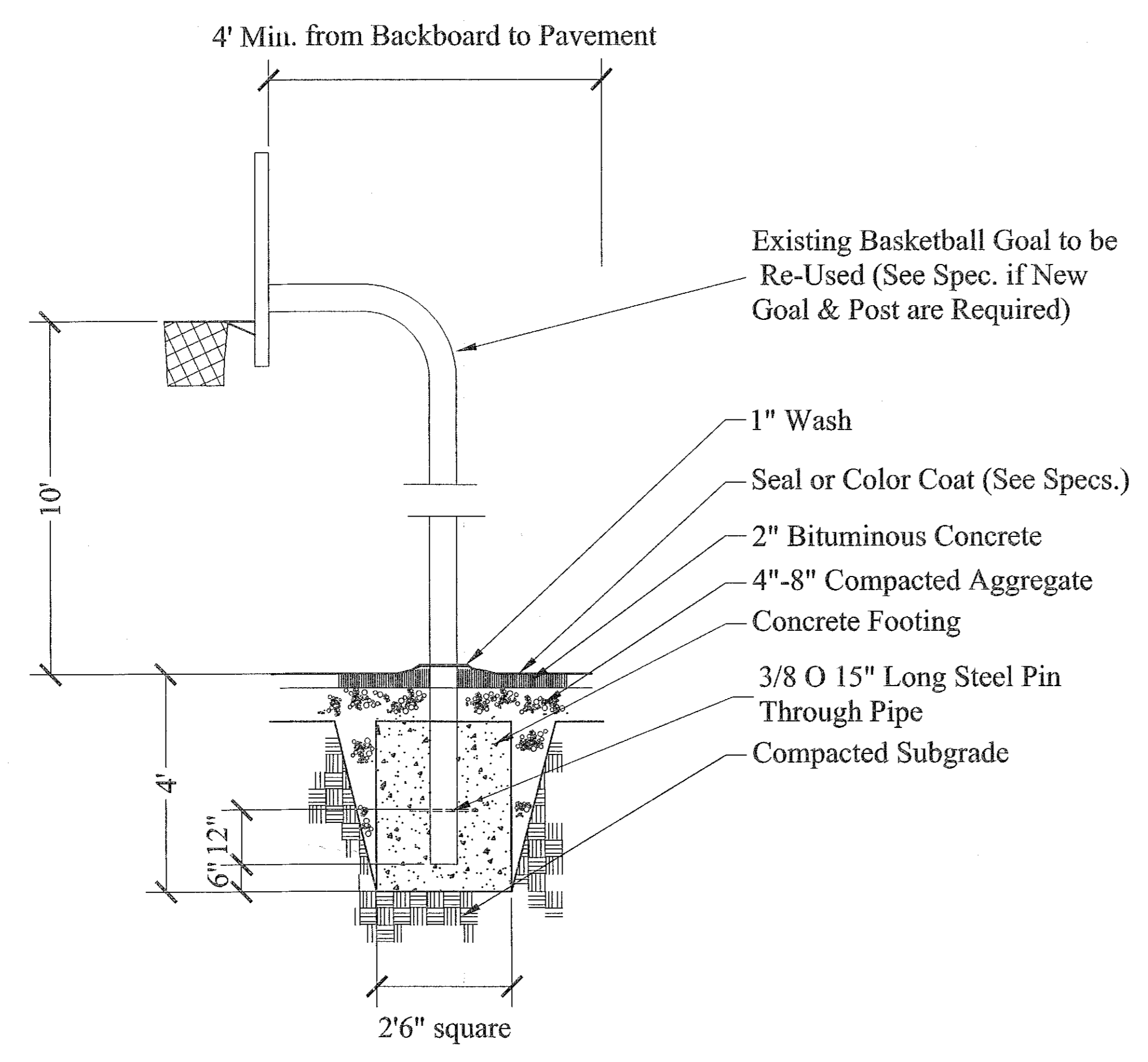

1 COURT SURFACE AND BASKETBALL POST
Scale: 1/2" = 1' - 0"

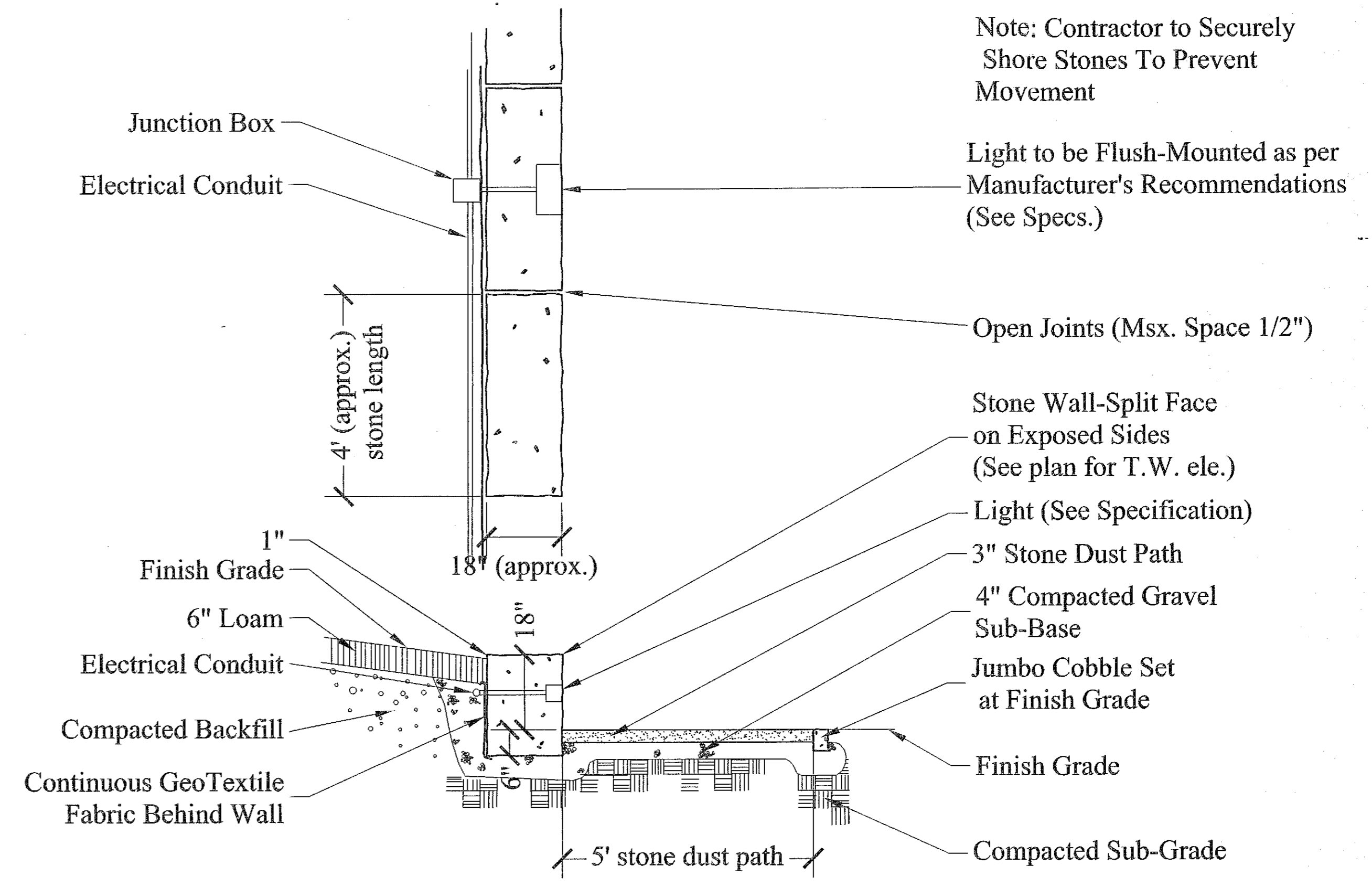

2 WALL AND STONE DUST PATH DETAIL
Scale: 1/2" = 1' - 0"

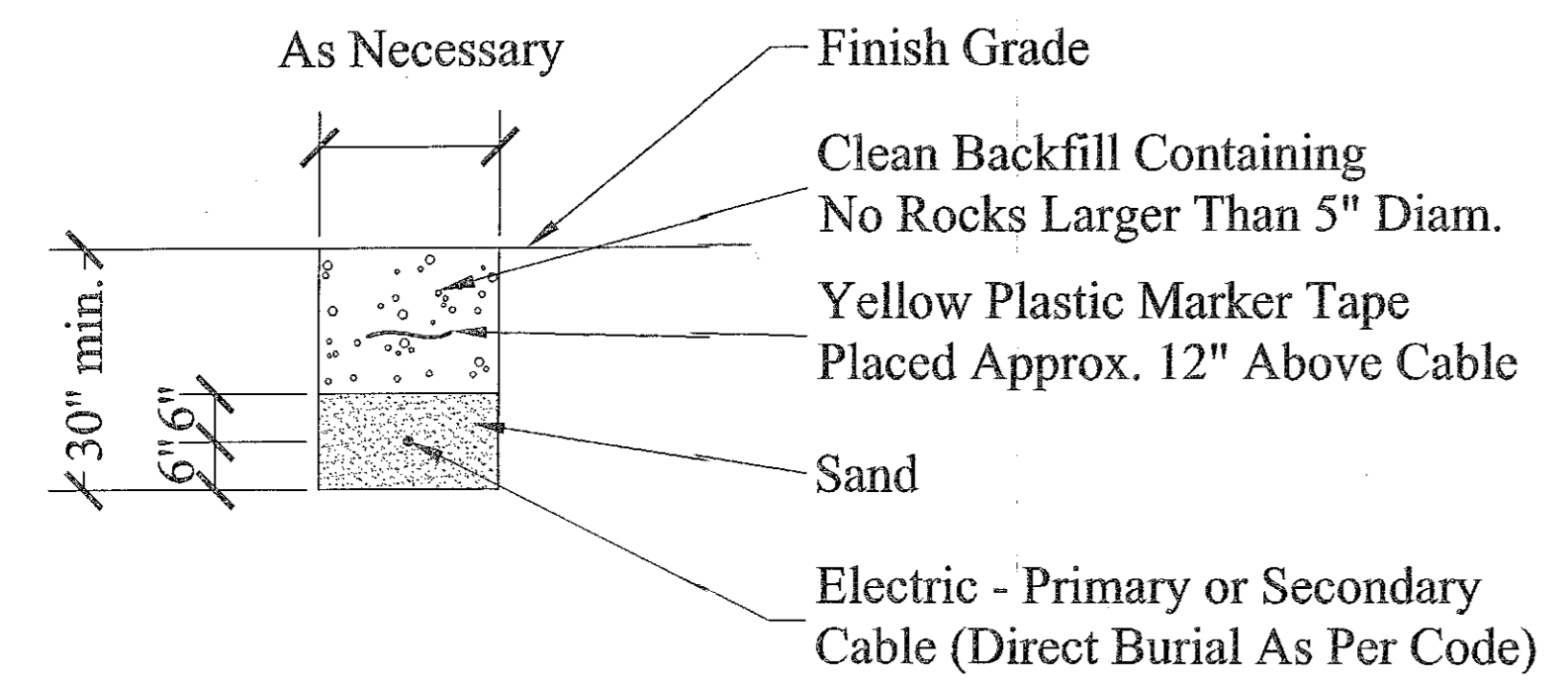

3 ELECTRICAL TRENCHING
Scale: 1/2" = 1' - 0"

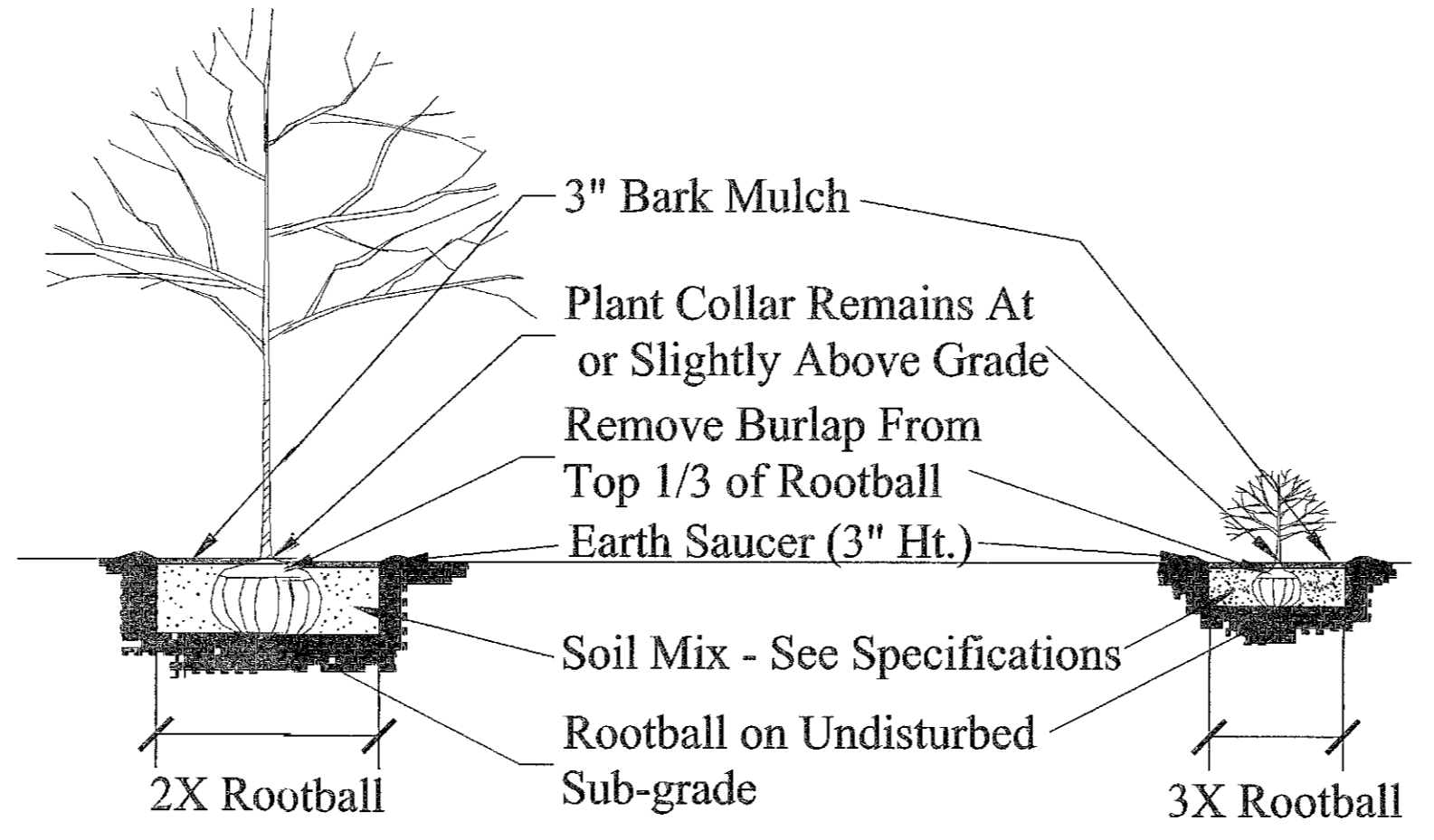

4 TREE AND SHRUB PLANTING
N.T.S.

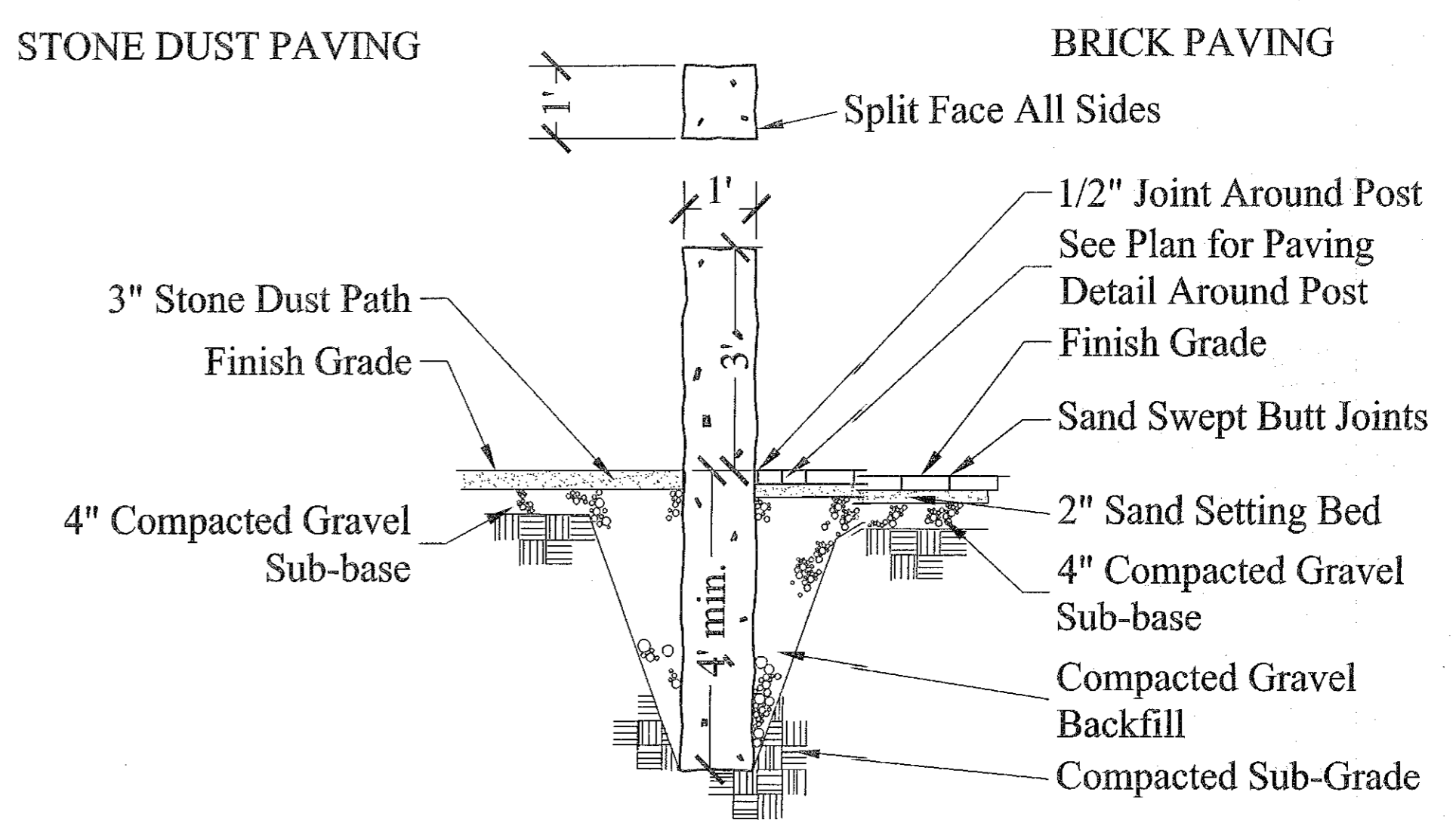

5 GRANITE BOLLARDS
Scale: 1/4" = 1' - 0"

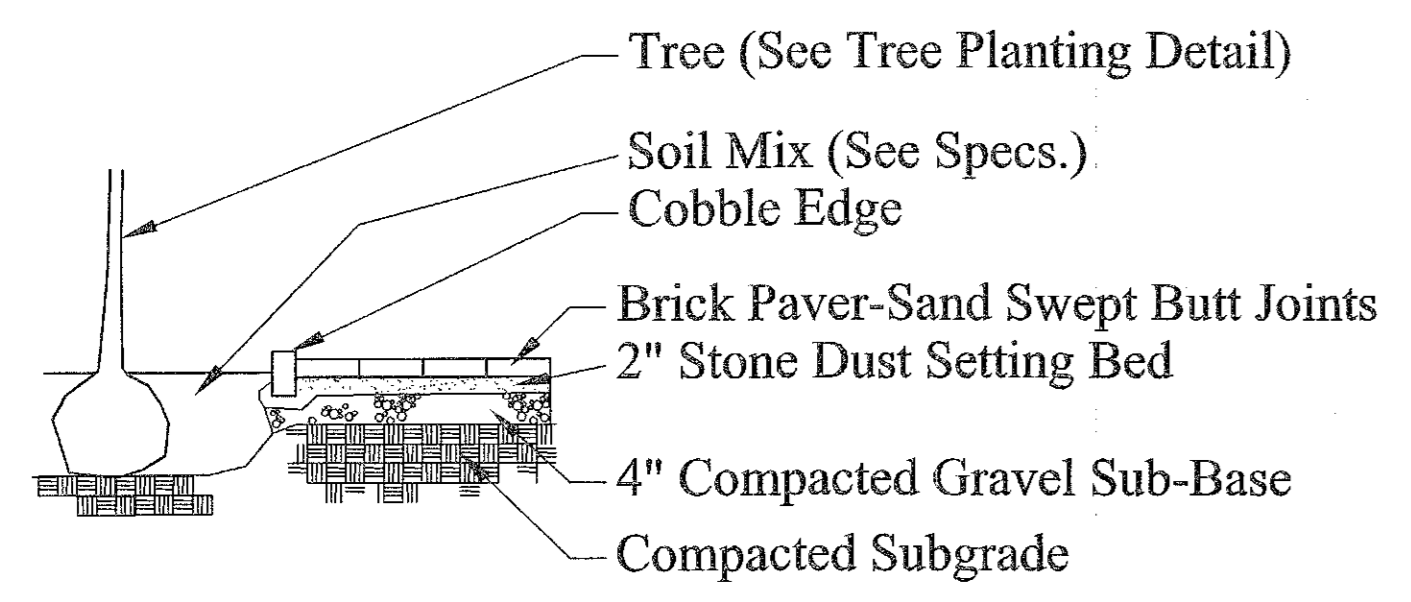

6 BRICK PAVING AT ENTRY PLAZA
Scale: 1/2" = 1' - 0"

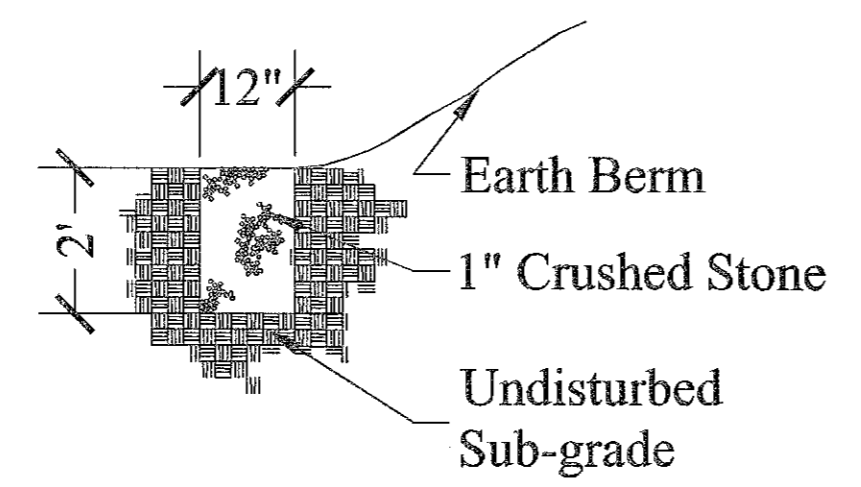

7 DRY WELL
N.T.S.

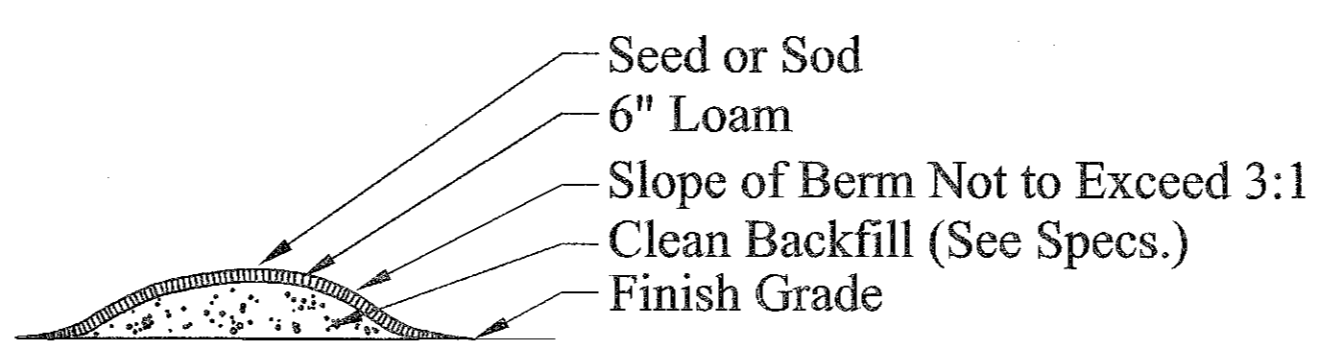

8 EARTH BERM
N.T.S.

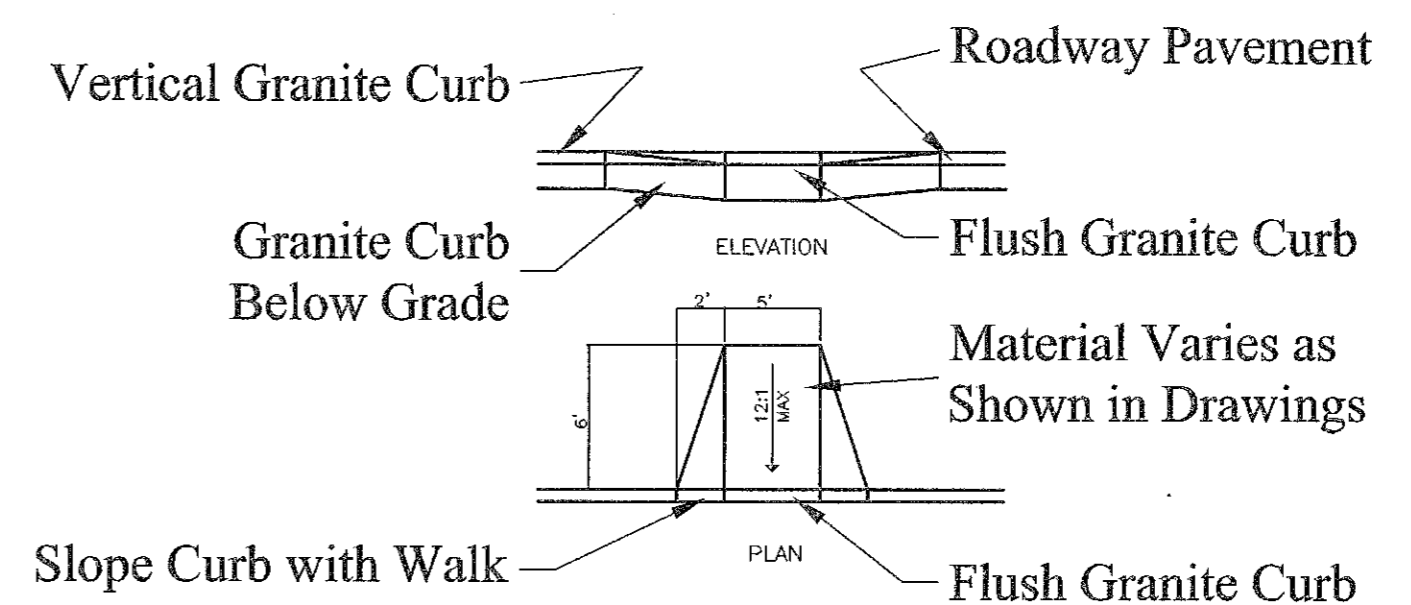

9 HANDICAPPED RAMP
N.T.S.

Note: Contractor to Securely Shore Stones To Prevent Movement
Light to be Flush-Mounted as per Manufacturer's Recommendations (See Specs.)

Richardson & Associates
Landscape Architects
P.O. Box 426
Saco, Maine 04043
(207) 286-9291

ROCK STREET PARK

Portsmouth, New Hampshire

Scale: As Noted

Date: 4/16/98
Revisions: 6/15/98
6/29/98

Sheet Number:

Sheet Title:
Detail Sheet B

6 of 6